

NOTES:
 THE PROPOSED PAVEMENT STRIPING IS NOT SHOWN ON THIS PLAN SHEET. SEE PAVEMENT MARKING SHEETS AND SCHEDULES FOR PROPOSED STRIPING LOCATIONS.

TOTAL PARKING LANE AREA ALONG THE SOUTH SIDE OF IL RTE. 16, BETWEEN STATE ST. AND MONROE ST. = 327 SQ. YD.

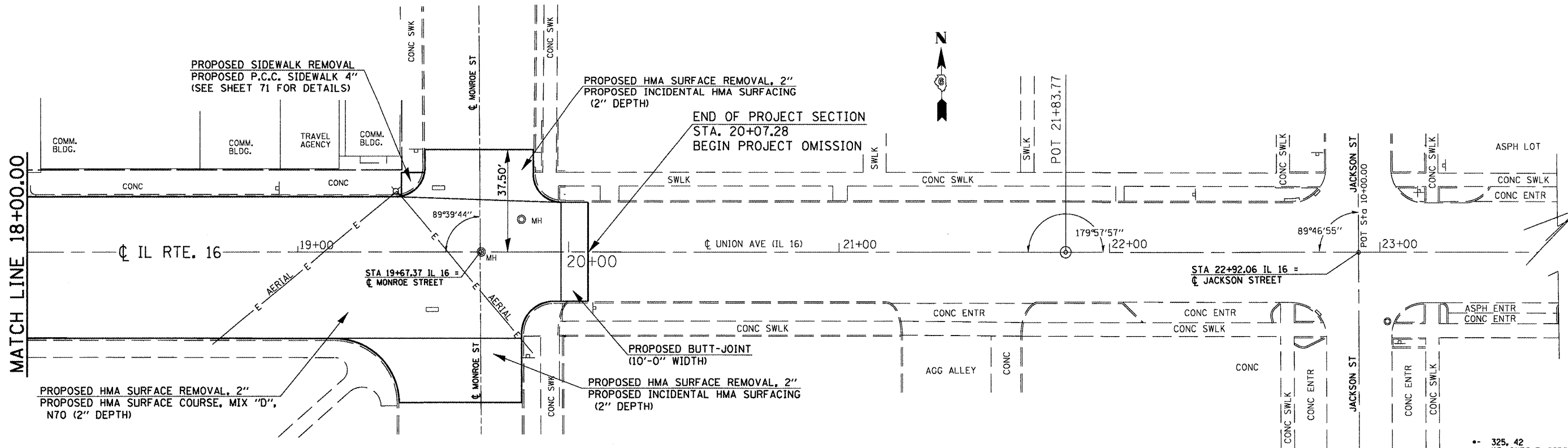

FILE NAME =	USER NAME = sparkgw	DESIGNED - RTS	REVISED -	STATE OF ILLINOIS DEPARTMENT OF TRANSPORTATION	PLAN SHEET (LITCHFIELD)	F.A.P. RTE.	SECTION	COUNTY	TOTAL SHEETS	SHEET NO.	
o:\pwork\pwork\sparkgw\d0222005\0672067-ah-plant.dgn	PLT SCALE = 48.0000' / in.	DRAWN - RTS	REVISED -			•	••	MONTGOMERY	80	40	
PLDT DATE = Aug-25-2011 10:16:02AM	DATE = 06-15-11	CHECKED -	REVISED -			CONTRACT NO. 72D67		ILLINOIS FED. AID PROJECT			
		DATE -	REVISED -			SCALE: 1"	SHEET NO. 5 OF 5 SHEETS	STA.	TO STA.		

-- 325, 42
 --- (15, 21)RS-7, 22RS-4, 24RS-8