

| PAVEMENT MARKING LEGEND | | | |
|-------------------------|---|-----|--|
| ① | PERFORMED PLASTIC PAVEMENT MARKING, TYPE B, INLAID - LINE 5" | ↩ | PREFORMED PLASTIC PAVEMENT MARKING, TYPE B, INLAID - LETTERS AND SYMBOLS (WHITE) |
| ② | PERFORMED PLASTIC PAVEMENT MARKING, TYPE B, INLAID - LINE 6" | ▶ | RAISED REFLECTIVE PAVEMENT MARKER (ONE-WAY CRYSTAL) |
| ③ | PERFORMED PLASTIC PAVEMENT MARKING, TYPE B, INLAID - LINE 6" (6' SKIP- 2' DASH) | ▶ | RAISED REFLECTIVE PAVEMENT MARKER (ONE -WAY AMBER) |
| ④ | PERFORMED PLASTIC PAVEMENT MARKING, TYPE B, INLAID - LINE 24" | ◆ | RAISED REFLECTIVE PAVEMENT MARKER (TWO -WAY AMBER) |
| ⑤ | THERMOPLASTIC PAVEMENT MARKING - LINE 5" | ⊗-W | PAVEMENT MARKING, WHITE |
| ⑥ | THERMOPLASTIC PAVEMENT MARKING - LINE 5" (DOUBLE YELLOW LINES @ 13" CENTERS) | ⊗-Y | PAVEMENT MARKING, YELLOW |
| ⑦ | THERMOPLASTIC PAVEMENT MARKING - LINE 6" | | |
| ⑧ | THERMOPLASTIC PAVEMENT MARKING - LINE 8" | | |
| ⑨ | THERMOPLASTIC PAVEMENT MARKING - LINE 12" | | |
| ⑩ | PAINT PAVEMENT MARKING - LINE 5" | | |

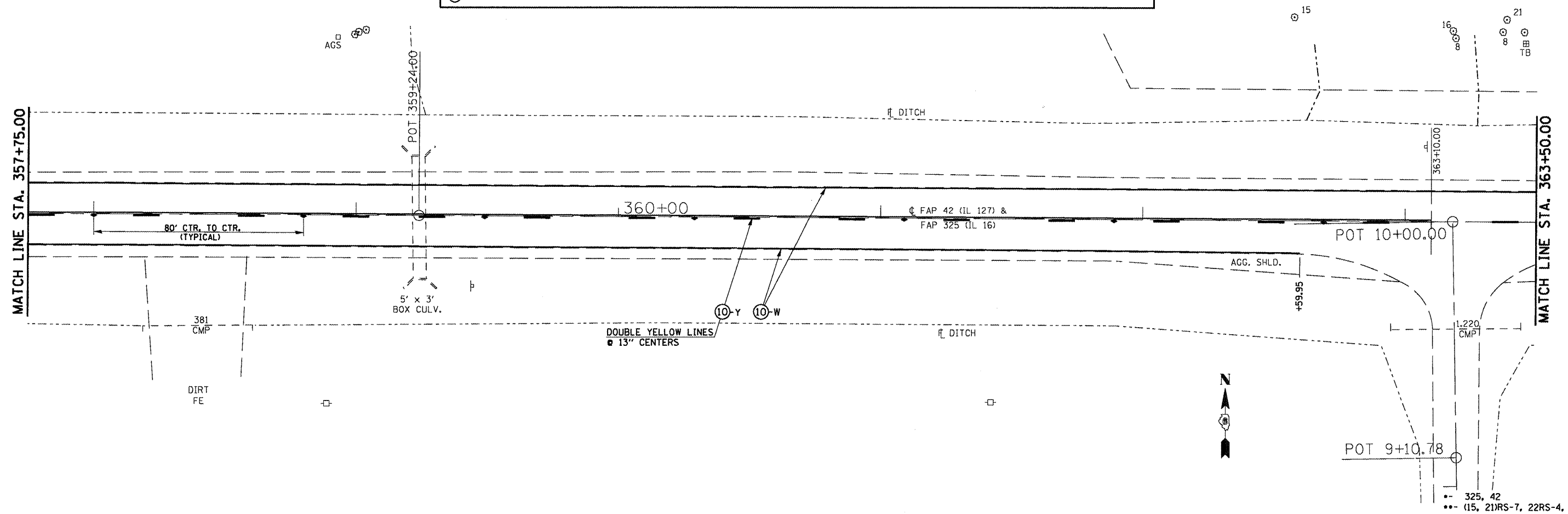

| | | | | | | | | | | | |
|------------------------------------|---------------------|-----------------|-----------|---|---|-------------------------|-------------|---------|------------|--------------|-----------|
| FILE NAME = | USER NAME = sparkgw | DESIGNED - RTS | REVISED - | STATE OF ILLINOIS DEPARTMENT OF TRANSPORTATION | PAVEMENT MARKING LAYOUT (IL 16 /IL 127 INTERSECTION) | | F.A.P. RTE. | SECTION | COUNTY | TOTAL SHEETS | SHEET NO. |
| 067-shr-pmk.dgn | 067-shr-pmk.dgn | DRAWN - RTS | REVISED - | | SCALE: | SHEET NO. 3 OF 4 SHEETS | STA. | TO STA. | MONTGOMERY | 80 | 63 |
| PLOT SCALE = 48.0000' / in. | | CHECKED - RTS | REVISED - | | CONTRACT NO. 72D67 | | | | | | |
| PLOT DATE = Aug-25-2011 10:16:15AM | | DATE - 06-16-11 | REVISED - | | FED. ROAD DIST. NO. [ILLINOIS] FED. AID PROJECT | | | | | | |