

ARCHIVED LIGHTING PLANS

FOR INFORMATION ONLY

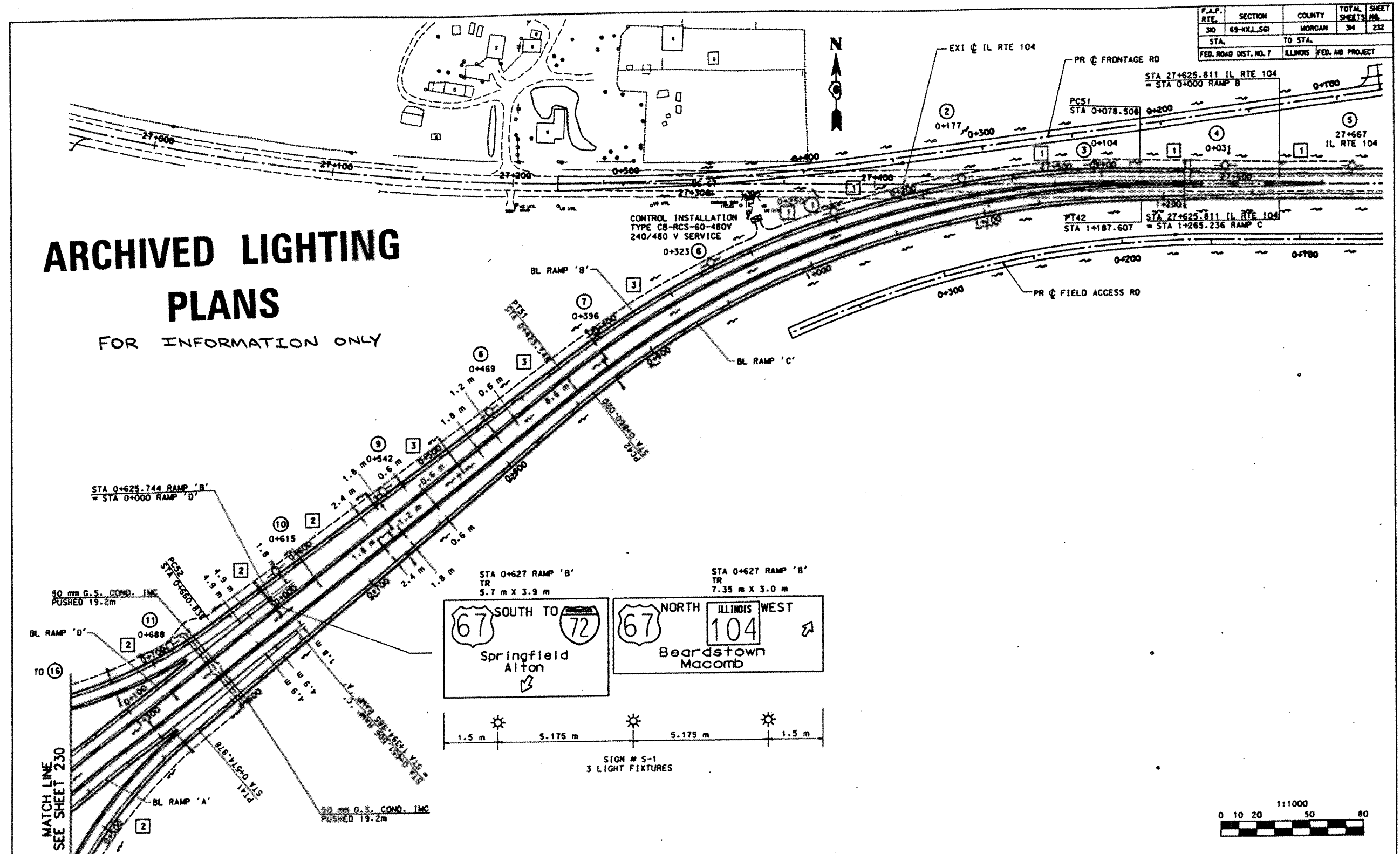

F.A.P. RTE.	SECTION	COUNTY	TOTAL SHEETS	SHEET NO.
310	69-IXL-1	MORGAN	34	232
STA. TO STA.		ILLINOIS FED. AID PROJECT		

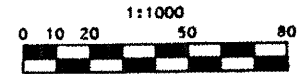
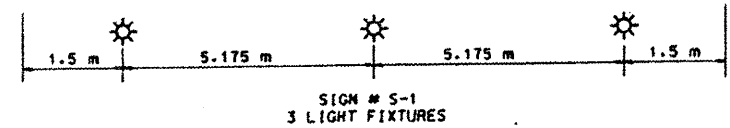
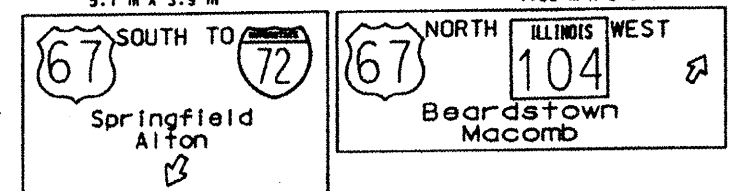

REVISIONS	
NAME	DATE

ILLINOIS DEPARTMENT OF TRANSPORTATION
 FAP RTE 310 (US 67)
 AND
 IL RTE 104 INTERCHANGE
 LIGHTING
 DRAWN BY: RM
 CHECKED BY: FRB
 DATE: JUNE 17, 1997

FILE NO.	PROJECT	DATE	REVISION

STATE OF ILLINOIS
 DEPARTMENT OF TRANSPORTATION

ARCHIVED LIGHTING PLANS
 SCALE: _____ SHEET OF SHEETS STA. TO STA.

F.A.P. RTE.	SECTION	COUNTY	TOTAL SHEETS	SHEET NO.
310	169-IX-1	MORGAN	17	16
CONTRACT NO. 72E13			ILLINOIS FED. AID PROJECT	