

**ELEVATION**

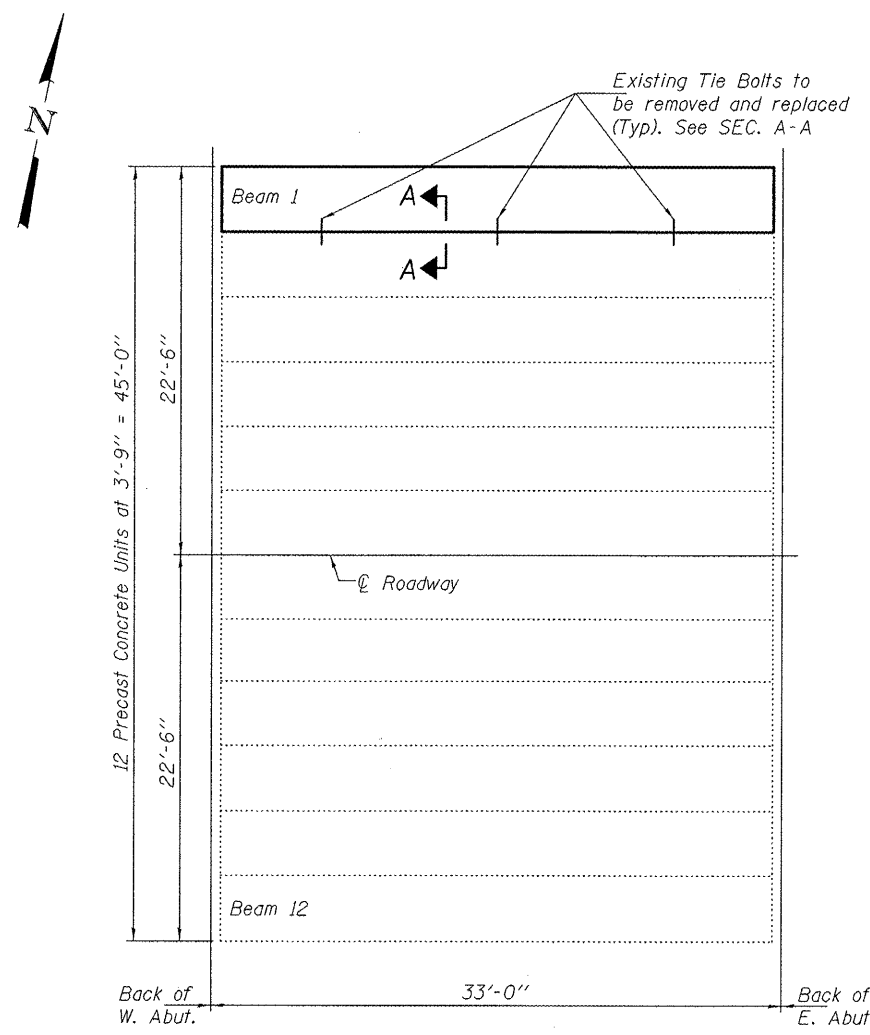

**PLAN**

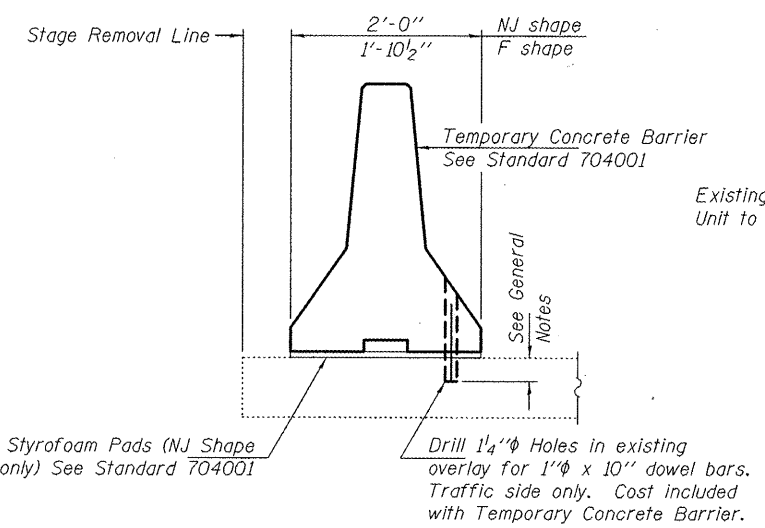

**SECTION THRU SLAB**

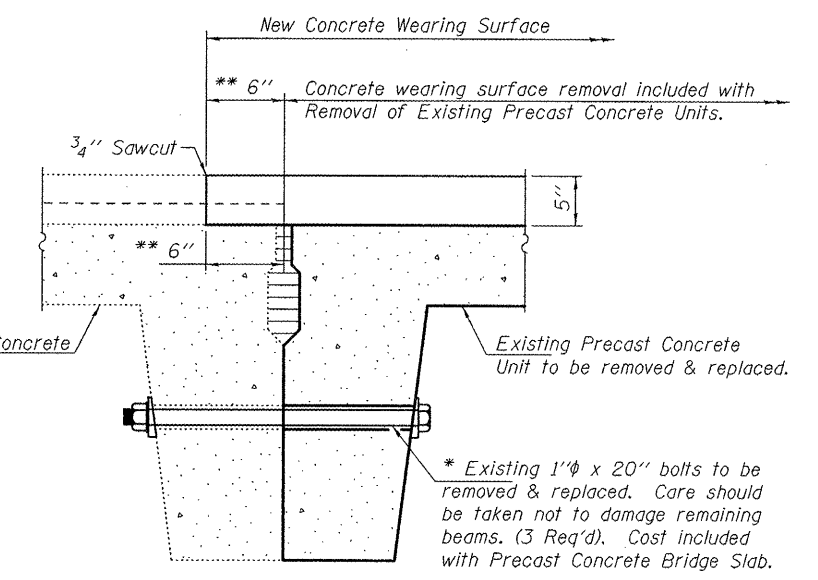

**SECTION A-A**

- \* New bolts shall only be snug tightened after placement.
- \*\* Limits of Concrete Wearing Surface Removal.
- \*\*\* Existing reinforcement to extend 6" min. beyond removal line.

**DESIGN STRESSES**

**PC UNITS**  
 $f_c = 1,800$  psi  
 $f'_c = 4,500$  psi  
 $f_s = 20,000$  psi (Reinforcement)  
 $n = 8$

**FIELD UNITS**  
 $f'_c = 3,500$  psi  
 $f_y = 60,000$  psi (Reinforcement)

**DESIGN SPECIFICATIONS**  
 2002 AASHTO Bridge Design Specifications

**TOTAL BILL OF MATERIAL**

ITEM	UNIT	QUANTITY
Precast Concrete Bridge Slab	Sq. Ft.	120
Removal of Existing Precast Concrete Units	Sq. Ft.	120
Concrete Wearing Surface Removal	Sq. Yd.	1.8
Concrete Wearing Surface, 5"	Sq. Yd.	15.1
Reinforcement Bars, Epoxy Coated	Pound	190
Mechanical Splicers	Each	33
Steel Railing, Type S1	Foot	64



EXPIRES 11-30-2012

DESIGNED: <i>Ally Vancey</i>	EXAMINED: <i>July F. J...</i>	DATE: NOVEMBER 28, 2011
CHECKED: <i>Mered Christman</i>	PASSED: <i>...</i>	REVISED:
DRAWN: <i>baliva</i>	REVISED:	
CHECKED: <i>ADY</i>		

STATE OF ILLINOIS  
 DEPARTMENT OF TRANSPORTATION

PLAN AND ELEVATION  
 FAP 321 OVER PLUM POINT SLOUGH  
 SN 075-0022

F.A.P. RTE. 321	SECTION 104RS2, BR3, 105RS7, BR3, 4; 106RS6	COUNTY PIKE	TOTAL SHEETS 69	SHEET NO. 52
CONTRACT NO. T2E43			ILLINOIS FED. AID PROJECT	