

EXIST. CURVE 103  
 PI STA. = 140+75.68  
 $\Delta = 3^\circ 00' 00''$  (LT)  
 $D = 0^\circ 18' 00''$   
 $R = 19,098.05'$   
 $T = 500.10'$   
 $L = 999.97'$   
 $E = 6.55'$   
 $e = \text{---}$   
 $T.R. = \text{---}$   
 $S.E. \text{ RUN} = \text{---}$   
 $P.C. \text{ STA.} = 135+75.58$   
 $P.T. \text{ STA.} = 145+75.55$

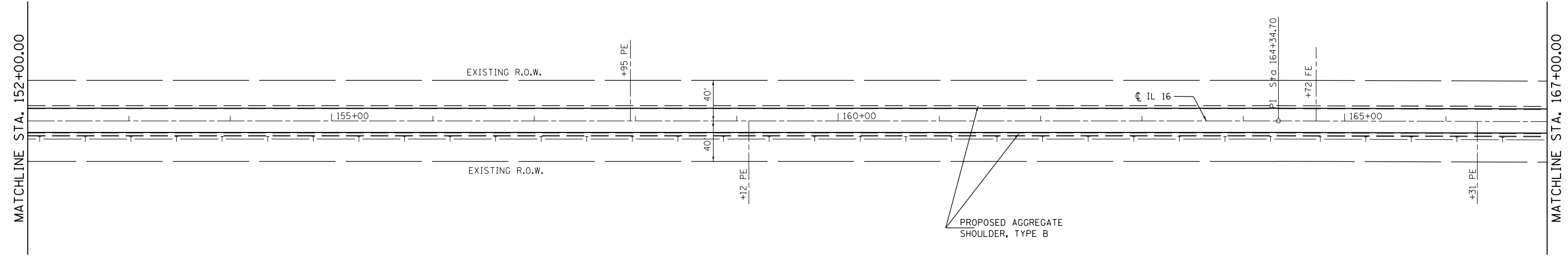
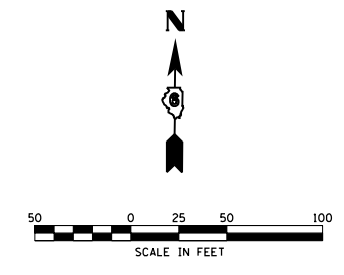
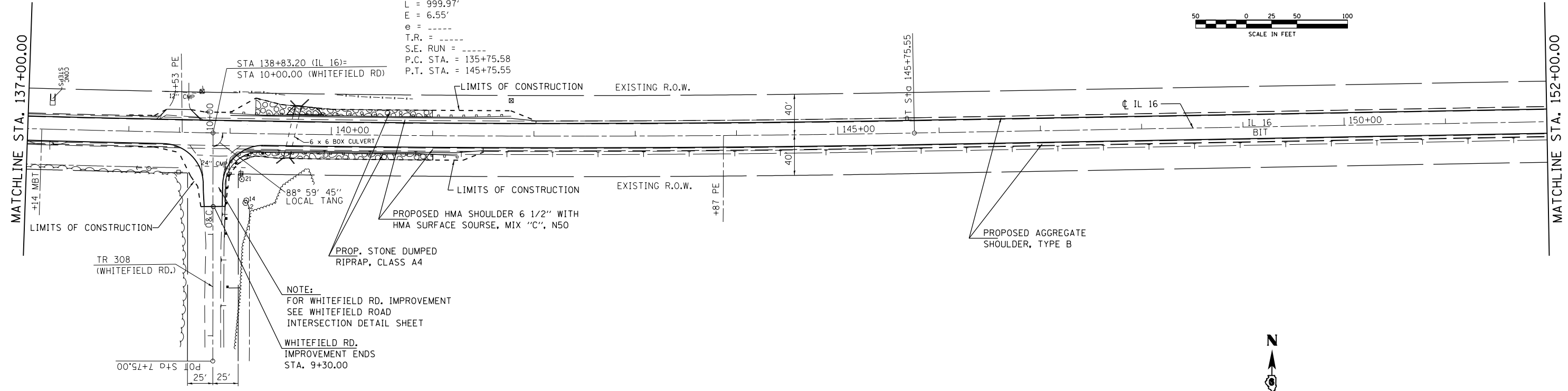
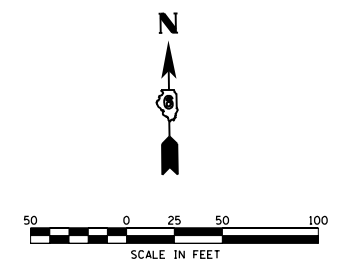

FILE NAME =	USER NAME = sparksgw	DESIGNED -	REVISED -	<b>STATE OF ILLINOIS DEPARTMENT OF TRANSPORTATION</b>	<b>PLAN SHEET</b>	F.A.P. RTE.	SECTION	COUNTY	TOTAL SHEETS	SHEET NO.	
ei:\pw\work\p\id\dot\sparksgw\10264305\067	PE47-sht-plan.dgn	DRAWN -	REVISED -			325	14 RS-5	MACOUPIN	70	21	
	PLOT SCALE = 100.0000' / 1in.	CHECKED -	REVISED -			CONTRACT NO. 72E47					
	PLOT DATE = Nov-01-2011 04:19:00PM	DATE -	REVISED -			ILLINOIS FED. AID PROJECT					
				SCALE:		SHEET NO. 5 OF 8 SHEETS		STA. 137+00 TO STA. 167+00			