

B.M. #17B: CHSLD. "□" IN CENTER OF NORTH HEADWALL OF 24" RCP UNDER IL 16, 195' WEST OF INTERSECTION OF IL 16 & WHITE FIELD RD. STA. 136+51.50 @ 19.9' LT NAVD 88 = ELEV. 649.024

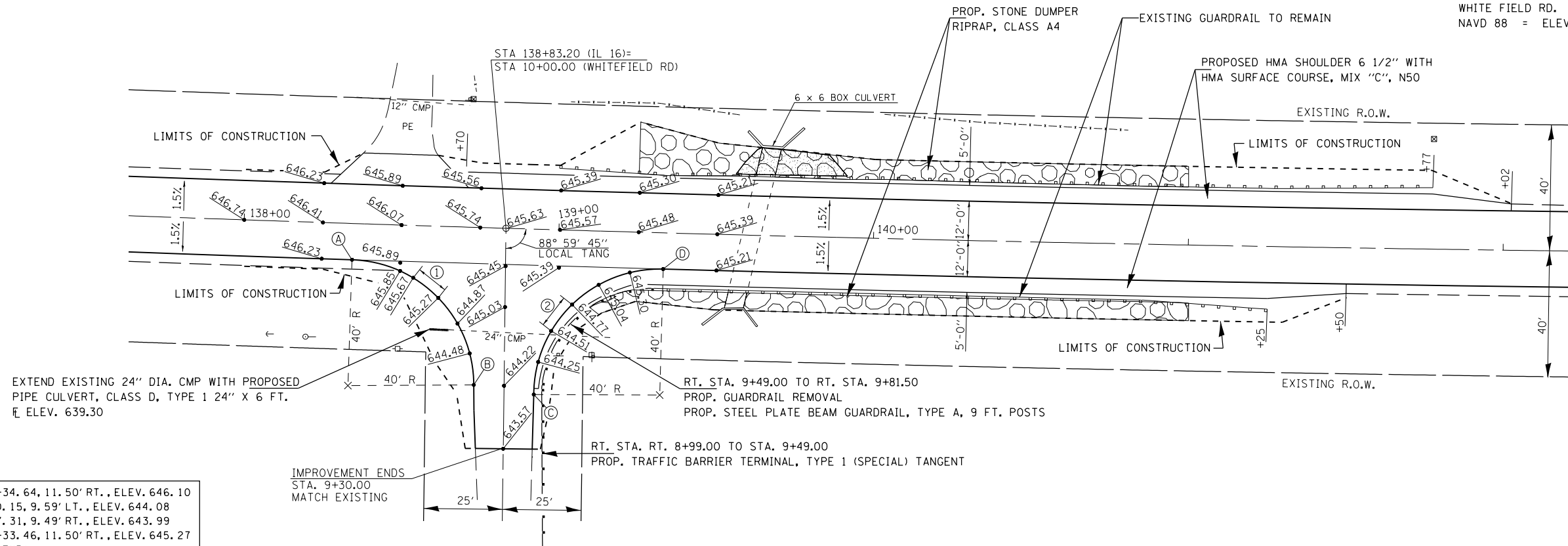

- (A) STA. 138+34.64, 11.50' RT., ELEV. 646.10
- (B) STA. 9+50.15, 9.59' LT., ELEV. 644.08
- (C) STA. 9+47.31, 9.49' RT., ELEV. 643.99
- (D) STA. 139+33.46, 11.50' RT., ELEV. 645.27
- (L) 10.21' (TYP)
- (2) 10.71' (TYP)

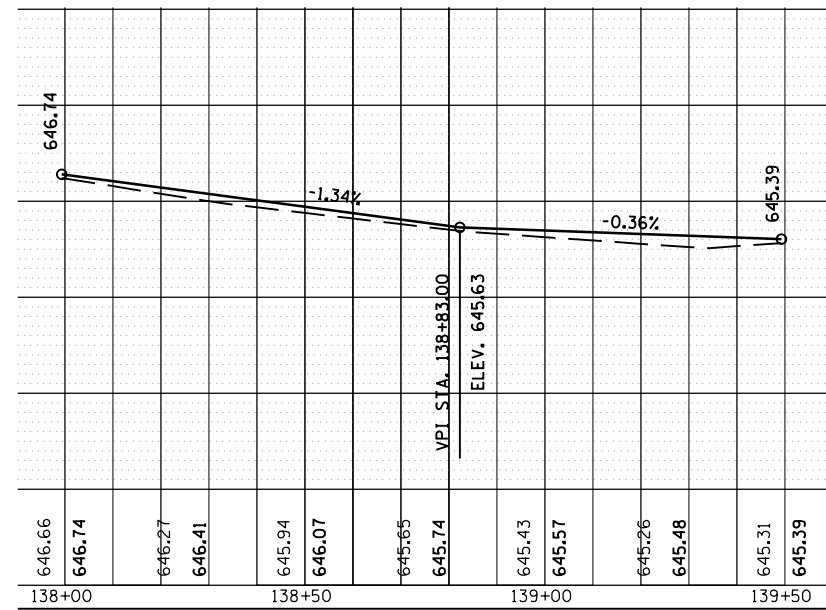
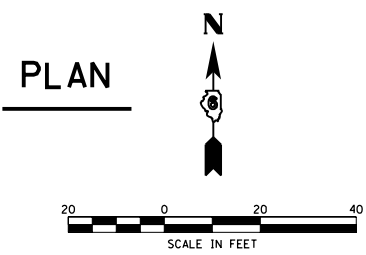

IL 16 PROPOSED PROFILE

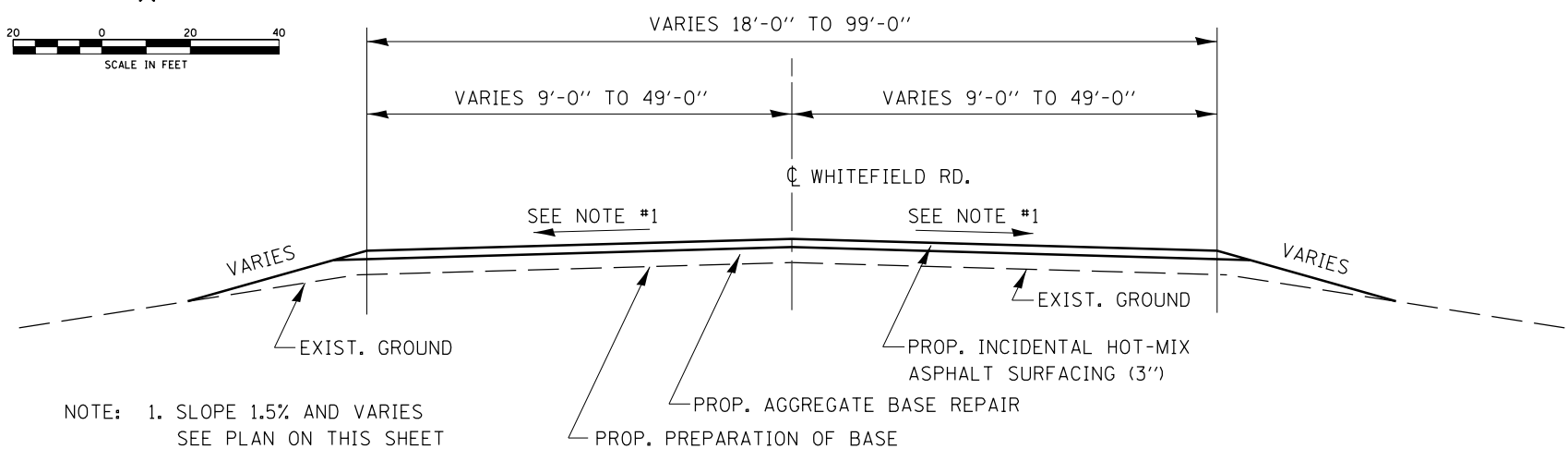

**TYPICAL SECTION
WHITEFIELD RD.**

STA. 9+30.00 TO STA. 9+88.00

FILE NAME =	USER NAME = sparksgw	DESIGNED -	REVISED -	STATE OF ILLINOIS DEPARTMENT OF TRANSPORTATION	WHITEFIELD RD. INTERSECTION DETAIL			F.A.P. RTE.	SECTION	COUNTY	TOTAL SHEETS	SHEET NO.
c:\pwork\pwork\sparksgw\10264385\0672E47-sht-details.dgn	DESIGNED -	REVISED -	REVISED -					325	14 RS-5	MACOUPIN	70	25
PLOT SCALE = 40.0000' / in.	CHECKED -	REVISED -	REVISED -		CONTRACT NO. 72E47							
PLOT DATE = Nov-01-2011 04:19:27PM	DATE -	REVISED -	REVISED -		ILLINOIS FED. AID PROJECT							