

POT STA 360+22.18
PK NAIL

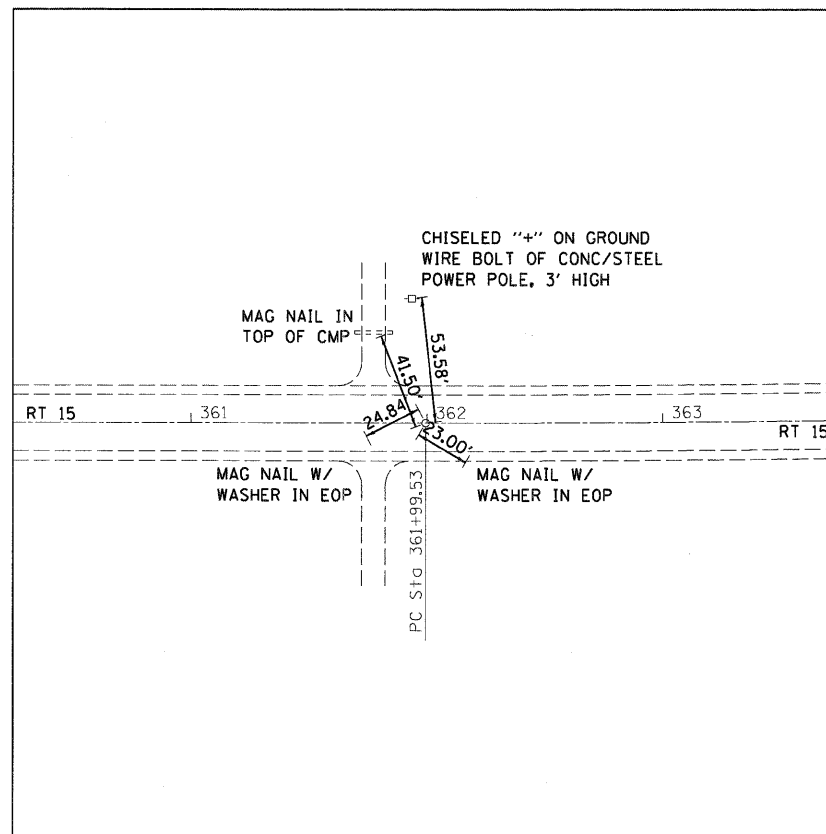

PC STA 361+99.53
PK NAIL

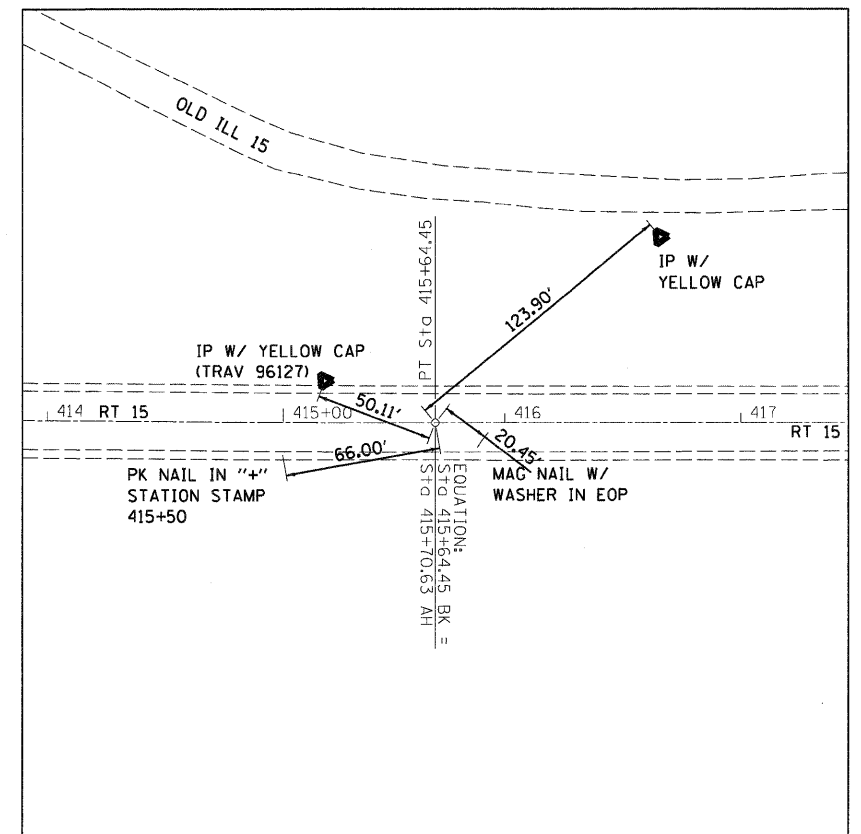

PT STA 415+64.45 BK
= 415+70.63 AH
PK NAIL

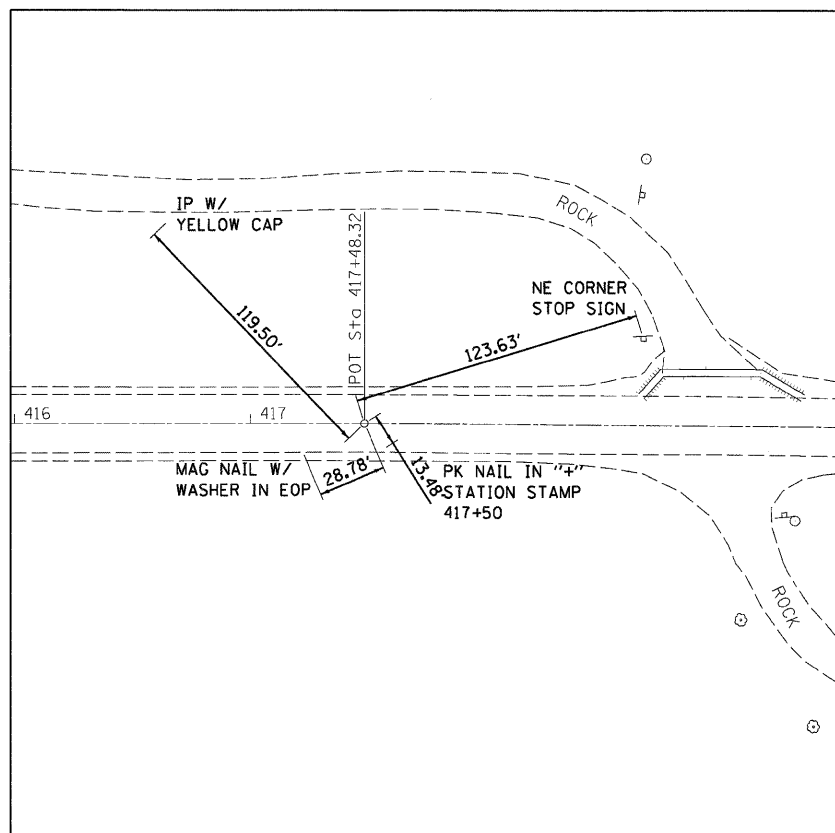

POT STA 417+48.32
PK NAIL

BENCHMARK DATA

- WE-16 - CHISELED SQUARE 7.15 MILES EAST OF FAIRFIELD AND FIRST STRUCTURE, ON THE NE HEADWALL OF STRUCTURE *096-0011 AT STATION 450+32 @ 19.0 FEET RIGHT, ELEV 393.113
- WE-17 - CHISELED SQUARE 7.60 MILES EAST OF FAIRFIELD ON THE NE HEADWALL OF STRUCTURE *096-0012 AT STATION 428+00 @ 19.0 FEET RIGHT, ELEV 393.162
- WE-18 - CHISELED SQUARE 8.1 MILES EAST OF FAIRFIELD ON THE NE HEADWALL OF STRUCTURE *096-0013 AT STATION 402+18 @ 19.0 FEET RIGHT, ELEV 393.396

PRINTED DATE: 10/25/2011
FILE NAME: m:\proj\2011\10\25\1110\1110.dwg



USER NAME = \$USER\$	DESIGNED - JEH	REVISED -
PLOT SCALE = 40,0000' / IN.	DRAWN - JEH	REVISED -
PLOT DATE = 10/25/2011	CHECKED - PAT	REVISED -
	DATE - 3-23-2011	REVISED -

**STATE OF ILLINOIS
DEPARTMENT OF TRANSPORTATION**

**SN: 096-0074
ALIGNMENT TIES AND BENCHMARKS**

SHEET NO 1 OF 1 SHEETS

F.A.P. RTE	SECTION	COUNTY	TOTAL SHEETS	SHEET NO
823	(22.B2A)B-1 & (22.B2B)B-1	WAYNE	85	8
CONTRACT NO 74216				
ILLINOIS FEDERAL AID PROJECT				