

PARCEL NUMBER 7004103  
FIRST NATIONAL BANK OF MARSHALL  
LAND TRUST 426

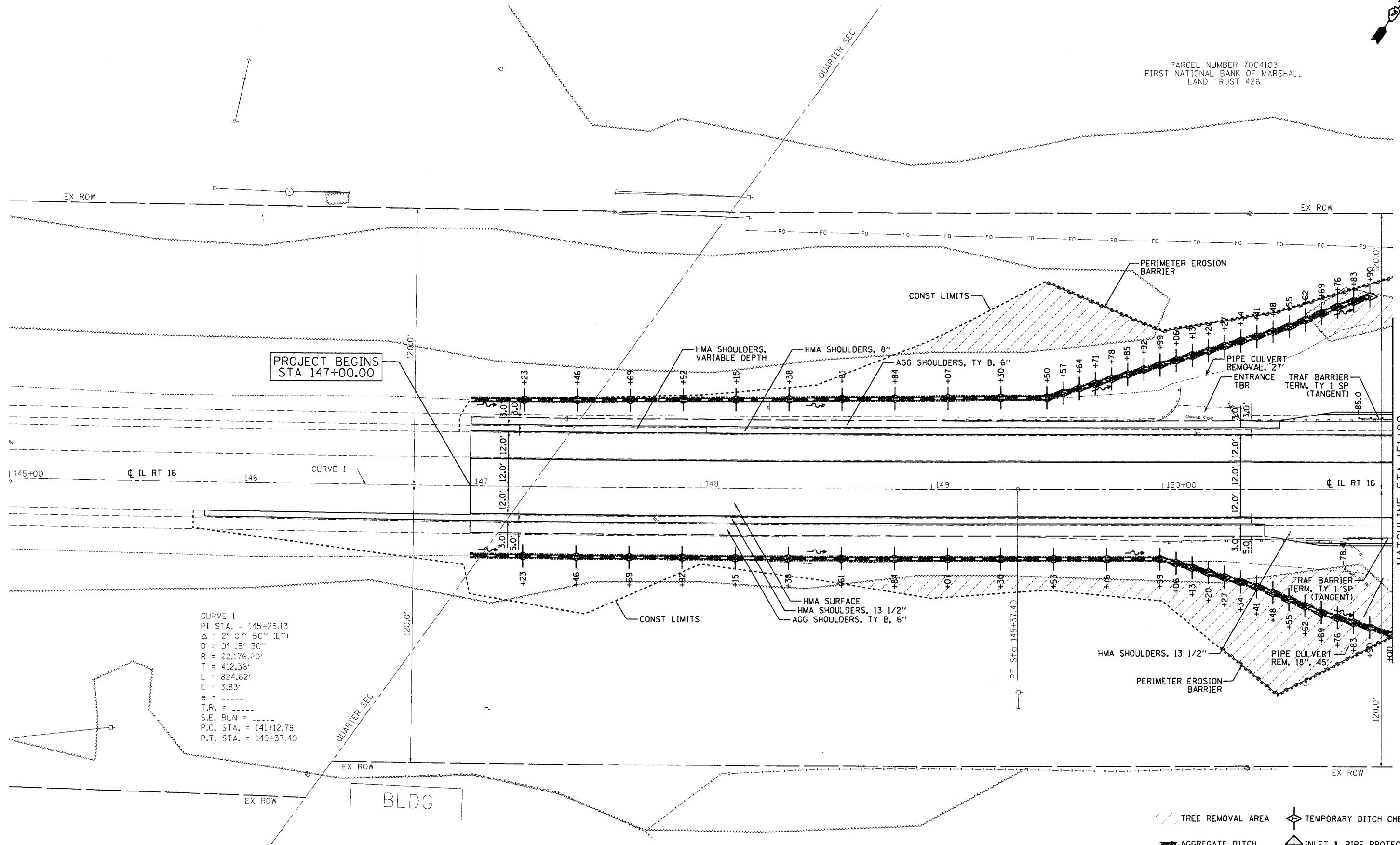

PROJECT BEGINS  
STA 147+00.00

CURVE 1  
PI STA. = 145+25.13  
 $\Delta = 2^\circ 07' 50''$  (LT)  
 $D = 0^\circ 15' 30''$   
 $R = 22,176.20'$   
 $T = 412.36'$   
 $L = 824.62'$   
 $E = 3.83'$   
 $\theta = \text{---}$   
T.R. =  $\text{---}$   
S.E. RUN =  $\text{---}$   
P.C. STA. = 141+12.78  
P.T. STA. = 149+37.40

- TREE REMOVAL AREA
- TEMPORARY DITCH CHECK
- AGGREGATE DITCH
- INLET & PIPE PROTECTION



STEPHEN MICHAEL PERNDERGAST

PRINTED DATE: 5/11/2011  
FILE NAME: m:\proj\pca\148\148\_14em\_25 - 07\various design\work order\_07\roads\drawings\Sheets\12-RUG-Plan-148.dgn



USER NAME = *USER*	DESIGNED - ADG, JEH	REVISED -
PLOT SCALE = 20,0000' / IN.	DRAWN - ADG, JEH	REVISED -
PLOT DATE = 5/11/2011	CHECKED - ADG, DF	REVISED -
	DATE - 05-11-2011	REVISED -

STATE OF ILLINOIS  
DEPARTMENT OF TRANSPORTATION

ROUTE 16 ROADWAY PLAN

SCALE: 1"=20' SHEET NO 1 OF 4 SHEETS STA 147+00 TO STA 151+00

F.A.P. RTE. 91	SECTION (SBRI8-1)	COUNTY COLES	TOTAL SHEETS 91	SHEET NO 12
				CONTRACT NO 74244
ILLINOIS FED. AID PROJECT				