

TYPICAL TRAFFIC PATTERN FOR STAGE 1  
STA 2177+57.30 TO STA 2255+37.65

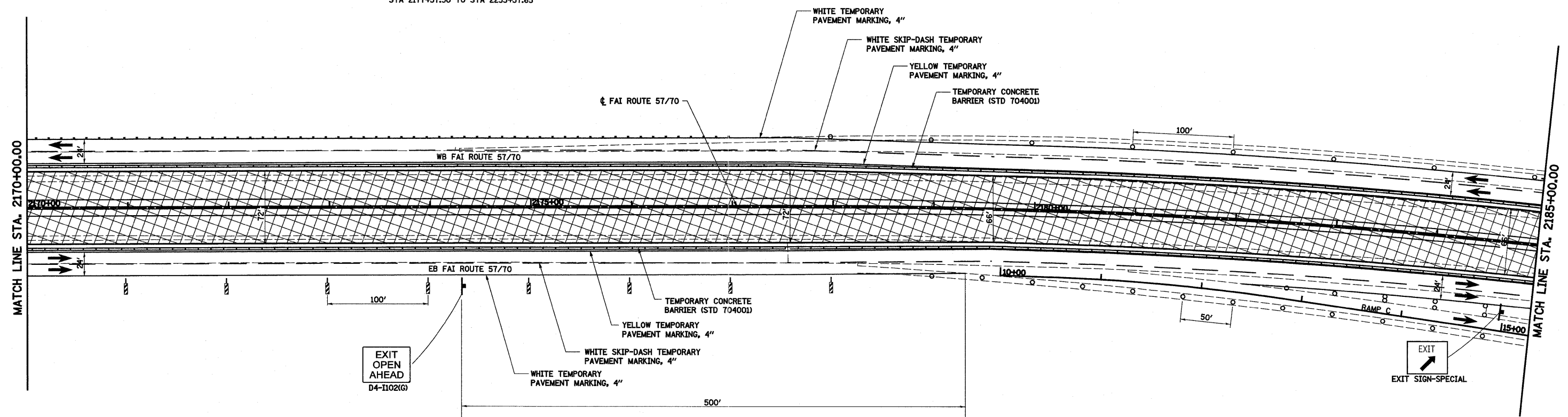

**LEGEND**

- TEMPORARY PCC PAVEMENT
- CONSTRUCTION THIS STAGE
- SIGN
- DIRECTION OF TRAFFIC
- TYPE II BARRICADES OR DRUMS WITH MONO-DIRECTIONAL STEADY BURNING LIGHTS
- VERTICAL PANEL
- TYPE III BARRICADE WITH FLASHING LIGHTS
- ARROW BOARD

**NOTES: STAGE 1**

1. SHIFT TRAFFIC TO OUTSIDE EXISTING PAVEMENT AND TEMPORARY PAVEMENT CONSTRUCTED DURING PRE-STAGE 1.
2. CONSTRUCT INSIDE PROPOSED PAVEMENT AND MEDIAN.
3. ALL ENTRANCE AND EXIT RAMP TO REMAIN OPEN.

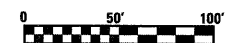

FILE NAME =	USER NAME = lnrde	DESIGNED - ESW	REVISED -	<b>STATE OF ILLINOIS DEPARTMENT OF TRANSPORTATION</b>	<b>MAINTENANCE OF TRAFFIC, STAGE 1, FAI ROUTE 57/70</b>	F.A.I. RTE.	SECTION	COUNTY	TOTAL SHEETS	SHEET NO.	
SA\Projects\403-00072-57-70\dgn\ML_keller\mor_sl.dgn		DRAWN - PDB	REVISED -			57/70	(25-3,4)R	EFFINGHAM	1098	105	
PLOT SCALE = 100.0000' / IN.		CHECKED - BRM	REVISED -			CONTRACT NO. 74299					
PLOT DATE = 3/17/2011		DATE - 4-28-08	REVISED -			FED. ROAD DIST. NO. 2 ILLINOIS FED. AID PROJECT					
				SCALE: 1"=50'		SHEET NO. 5 OF 10 SHEETS		STA. 2170+00.00 TO STA. 2185+00.00			