

- NOTES: EB TRANSITION PAVEMENT**
1. REMOVE EXISTING PAVEMENT FROM STA 2185+35.00 TO STA 2190+55.00.
  2. CONSTRUCT PROPOSED PAVEMENT ACCORDING TO 57/70 PROFILE FROM STA 2186+85.00 TO STA 2189+05.00.
  3. CONSTRUCT TEMPORARY TRANSITION PAVEMENT ACCORDING TO PROFILE ON SHEET 14 OF 14 FROM STA 2185+35.00 TO STA 2186+85.00 AND STA 2189+05.00 TO STA 2190+55.00.

- NOTES: WB TRANSITION PAVEMENT**
1. REMOVE EXISTING PAVEMENT FROM STA 2188+30.00 TO STA 2194+85.00.
  2. CONSTRUCT PROPOSED PAVEMENT ACCORDING TO 57/70 PROFILE FROM STA 2189+80.00 TO STA 2193+35.00.
  3. CONSTRUCT TEMPORARY TRANSITION PAVEMENT ACCORDING TO PROFILE ON SHEET 14 OF 14 FROM STA 2188+30.00 TO STA 2189+80.00 AND STA 2193+35.00 TO STA 2194+85.00.

- NOTES: PRE-STAGE 2A**
1. SHIFT ALL TRAFFIC EXITING AT FAYETTE AVE OR IL 32 & IL 33 TO FAR RIGHT LANE. SHIFT REMAINING THROUGH FAI 57/70 TRAFFIC TO NEWLY CONSTRUCTED INSIDE SHOULDER AND PAVEMENT.
  2. CONSTRUCT PAVEMENT AND TEMPORARY PAVEMENT AT EACH RAMP TERMINAL AS INDICATED.

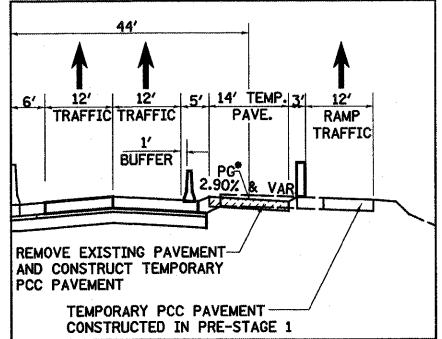
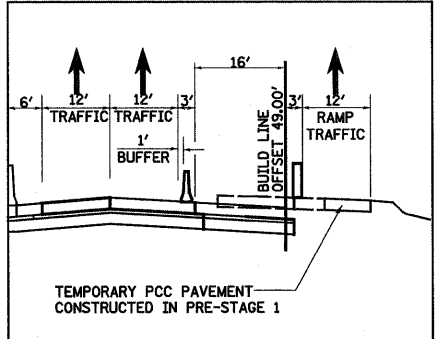

• FOR PROFILE DETAILS, SEE SHEET 14 OF 14

**LEGEND**

	TEMPORARY PCC PAVEMENT		TYPE II BARRICADES OR DRUMS WITH MONO-DIRECTIONAL STEADY BURNING LIGHTS
	CONSTRUCTION THIS STAGE		VERTICAL PANEL
	SIGN		TYPE III BARRICADE WITH FLASHING LIGHTS
	DIRECTION OF TRAFFIC		ARROW BOARD

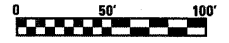

USER NAME = lunde PLOT SCALE = 1/8"=50' IN. PLOT DATE = 3/16/2011	DESIGNED - ESW DRAWN - PDB CHECKED - BMJ DATE - 5-07-08	REVISED - REVISED - REVISED - REVISED -	<b>STATE OF ILLINOIS</b> <b>DEPARTMENT OF TRANSPORTATION</b>	<b>MAINTENANCE OF TRAFFIC, PRE-STAGE 2A, FAI ROUTE 57/70</b>		F.A.I. RTE. 57/70	SECTION (25-3,4)R	COUNTY EFFINGHAM	TOTAL SHEETS 1098	SHEET NO. 116
				SCALE: 1"=50'	SHEET NO. 6 OF 14 SHEETS	STA. 2185+00.00 TO STA. 2220+00.00	CONTRACT NO. 74299			