

NOTES: WB TRANSITION PAVEMENT

1. REMOVE EXISTING PAVEMENT FROM STA 2211+35.00 TO STA 2217+40.00.
2. CONSTRUCT PROPOSED PAVEMENT ACCORDING TO 57/70 PROFILE FROM STA 2213+35.00 TO STA 2215+90.00.
3. CONSTRUCT TEMPORARY TRANSITION PAVEMENT ACCORDING TO PROFILE ON SHEET 13 OF 14 FROM STA 2211+35.00 TO STA 2213+35.00 AND STA 2215+90.00 TO STA 2217+40.00.

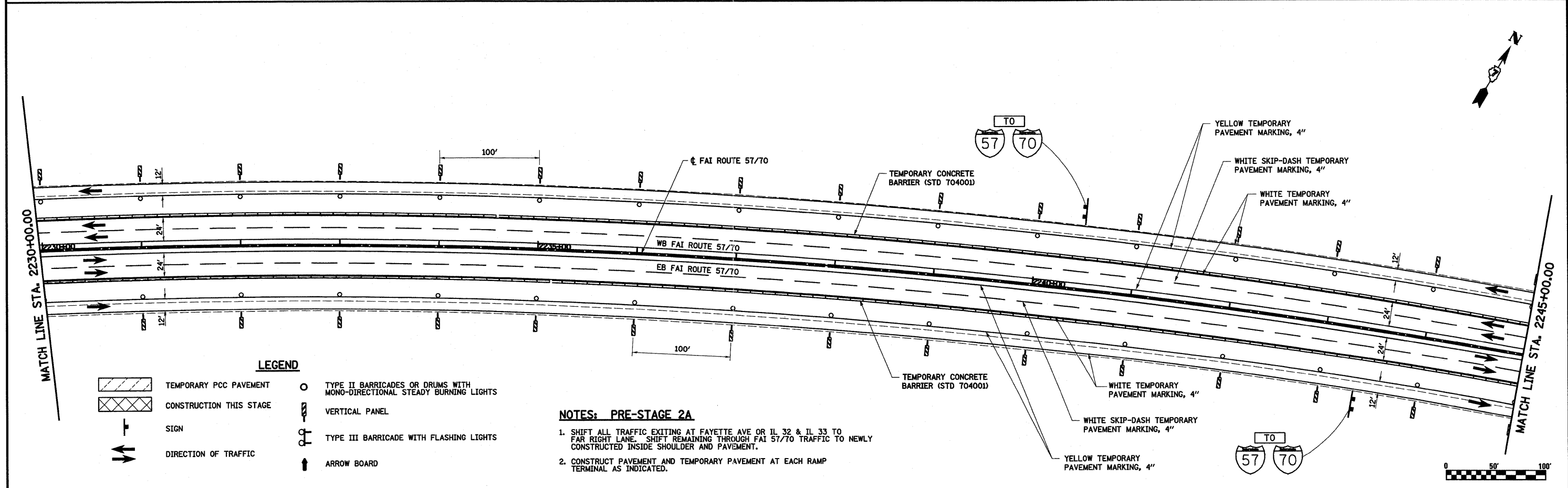

LEGEND

- TEMPORARY PCC PAVEMENT
- CONSTRUCTION THIS STAGE
- SIGN
- DIRECTION OF TRAFFIC
- TYPE II BARRICADES OR DRUMS WITH MONO-DIRECTIONAL STEADY BURNING LIGHTS
- VERTICAL PANEL
- TYPE III BARRICADE WITH FLASHING LIGHTS
- ARROW BOARD

NOTES: PRE-STAGE 2A

1. SHIFT ALL TRAFFIC EXITING AT FAYETTE AVE OR IL 32 & IL 33 TO FAR RIGHT LANE. SHIFT REMAINING THROUGH FAI 57/70 TRAFFIC TO NEWLY CONSTRUCTED INSIDE SHOULDER AND PAVEMENT.
2. CONSTRUCT PAVEMENT AND TEMPORARY PAVEMENT AT EACH RAMP TERMINAL AS INDICATED.

FILE NAME =	USER NAME = bsebel	DESIGNED - ESW	REVISED -	STATE OF ILLINOIS DEPARTMENT OF TRANSPORTATION	MAINTENANCE OF TRAFFIC, PRE-STAGE 2A, FAI ROUTE 57/70	F.A.I. RTE.	SECTION	COUNTY	TOTAL SHEETS	SHEET NO.	
S:\Projects\403-00072-57-70\dm\ML_Keller\wpf_P2a.dwg		DRAWN - PDB	REVISED -			57/70	(25-3,4)R	EFFINGHAM	1098	118	
PLOT SCALE = 100.00000 ' / IN.		CHECKED - BRM	REVISED -			CONTRACT NO. 74299					
PLOT DATE = 3/18/2011		DATE - 5-07-08	REVISED -			FED. ROAD DIST. NO. ILLINOIS FED. AID PROJECT					