

DETAIL I-I

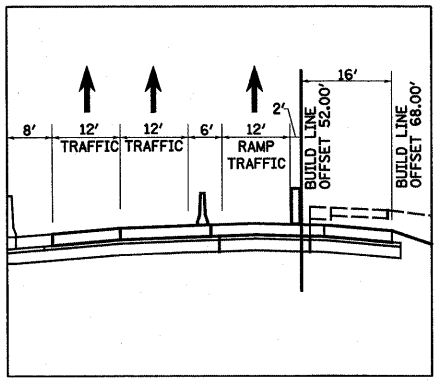

DETAIL C-C

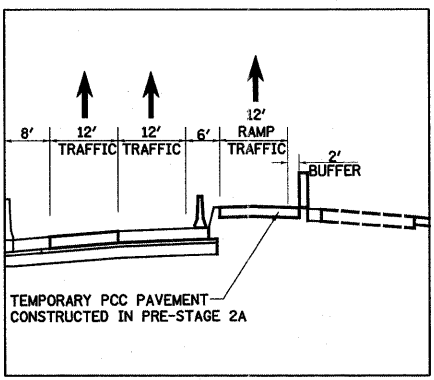

DETAIL D-D

TEMPORARY CONNECTOR  
FAYETTE RAMP A

DESCRIPTION	COORDINATE	
	NORTHING	EASTING
POT STA 0+00.00	894589.09	917702.13
POT STA 3+34.34	894371.24	917448.51

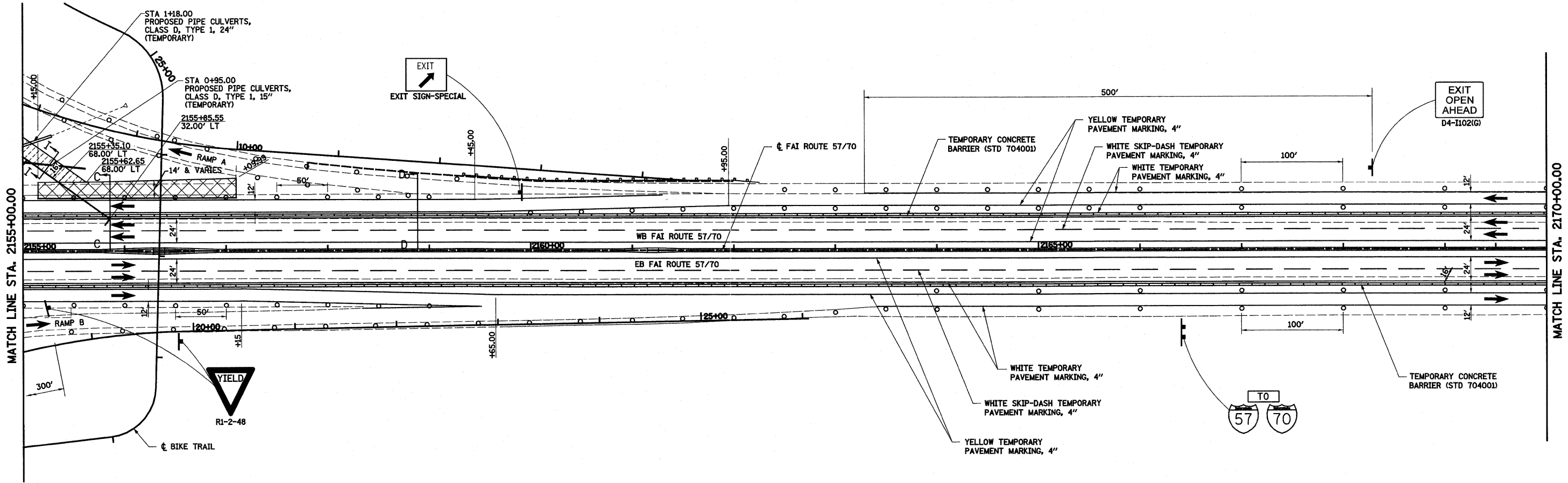

LEGEND

- TEMPORARY PCC PAVEMENT
- CONSTRUCTION THIS STAGE
- SIGN
- DIRECTION OF TRAFFIC
- TYPE II BARRICADES OR DRUMS WITH MONO-DIRECTIONAL STEADY BURNING LIGHTS
- VERTICAL PANEL
- TYPE III BARRICADE WITH FLASHING LIGHTS
- ARROW BOARD

NOTES: PRE-STAGE 2B

- SHIFT ALL TRAFFIC EXITING AT FAYETTE AVE OR IL 32 & IL 33 TO FAR RIGHT LANE. SHIFT REMAINING THROUGH 57/70 TRAFFIC TO INSIDE SHOULDER PAVEMENT.
- CONSTRUCT PAVEMENT, PROPOSED PAVEMENT AND SHOULDER AND TEMPORARY RAMP CONNECTOR AT EACH RAMP TERMINAL. CONSTRUCT WIDENING ON KELLER RAMPS.

NOTES: EB TRANSITION PAVEMENT

- REMOVE EXISTING PAVEMENT FROM STA 2151+10.00 TO STA 2154+50.00.
- CONSTRUCT PROPOSED PAVEMENT ACCORDING TO 57/70 PROFILE FROM STA 2151+10.00 TO STA 2154+50.00.
- CONSTRUCT TEMPORARY CONNECTOR PAVEMENT FOR FAYETTE RAMP B ACCORDING TO PROFILE ON SHEET 11 OF 12

NOTES: WB TRANSITION PAVEMENT

- REMOVE EXISTING PAVEMENT FROM STA 2155+15.00 TO STA 2157+09.99.
- CONSTRUCT PROPOSED PAVEMENT ACCORDING TO 57/70 PROFILE FROM STA 2155+15.00 TO STA 2157+09.99.
- CONSTRUCT TEMPORARY CONNECTOR PAVEMENT FOR FAYETTE RAMP A ACCORDING TO PROFILE ON SHEET 11 OF 12

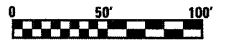

FILE NAME =	USER NAME = paul	DESIGNED - ESW	REVISED -	<b>STATE OF ILLINOIS DEPARTMENT OF TRANSPORTATION</b>	<b>MAINTENANCE OF TRAFFIC, PRE-STAGE 2B, FAYETTE RAMP A</b>	F.A.I. RTE.	SECTION	COUNTY	TOTAL SHEETS	SHEET NO.
S:\Projects\403-00072-57-70\dgn\ML_Keller\mot_P52b.dgn	PLOT SCALE = 1/800.0000 "/td> <td>DRAWN - PDB</td> <td>REVISED -</td> <td>57/70</td> <td>(25-3,4)R</td> <td>EFFINGHAM</td> <td>1098</td> <td>128</td>	DRAWN - PDB	REVISED -			57/70	(25-3,4)R	EFFINGHAM	1098	128
PLOT DATE = 3/18/2011	DATE - 5-07-08	CHECKED - BRM	REVISED -			SCALE: 1"=50'		FED. ROAD DIST. NO.	ILLINOIS FED. AID PROJECT	
		DATE - 5-07-08	REVISED -			SHEET NO. 4 OF 12 SHEETS		STA. 2155+00.00 TO STA. 2170+00.00		CONTRACT NO. 74299