

**KELLER RAMP A**

DESCRIPTION	COORDINATE	
	NORTHING	EASTING
POT STA 0+00.00	899872.51	919988.75
POT STA 1+42.69	899836.10	919850.78

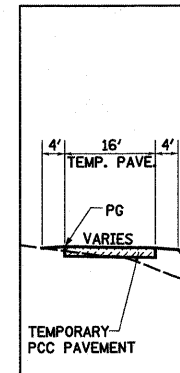

DETAIL I-I

**LEGEND**

- TEMPORARY PCC PAVEMENT
- CONSTRUCTION THIS STAGE
- SIGN
- DIRECTION OF TRAFFIC
- TYPE II BARRICADES OR DRUMS WITH MONO-DIRECTIONAL STEADY BURNING LIGHTS
- VERTICAL PANEL
- TYPE III BARRICADE WITH FLASHING LIGHTS
- ARROW BOARD

**NOTES: PRE-STAGE 2B**

- SHIFT ALL TRAFFIC EXITING AT FAYETTE AVE OR IL 32 & IL 33 TO FAR RIGHT LANE. SHIFT REMAINING THROUGH 57/70 TRAFFIC TO INSIDE SHOULDER PAVEMENT.
- CONSTRUCT PAVEMENT, PROPOSED PAVEMENT AND SHOULDER AND TEMPORARY RAMP CONNECTOR AT EACH RAMP TERMINAL. CONSTRUCT WIDENING ON KELLER RAMP.

**NOTES: EB TRANSITION PAVEMENT**

- REMOVE EXISTING PAVEMENT FROM STA 2213+35.00 TO STA 2215+00.00.
- CONSTRUCT PROPOSED PAVEMENT ACCORDING TO 57/70 PROFILE FROM STA 2213+35.00 TO STA 2215+00.00.
- CONSTRUCT TEMPORARY CONNECTOR PAVEMENT FOR KELLER RAMP A ACCORDING TO PROFILE ON SHEET 12 OF 12. CONSTRUCT WIDENING ON LEFT SIDE OF KELLER RAMP A.

**NOTES: WB TRANSITION PAVEMENT**

- REMOVE EXISTING PAVEMENT FROM STA 2206+74.00 ALONG KELLER RAMP B TO STA 2213+25.00 ALONG 57/70.
- CONSTRUCT PROPOSED PAVEMENT ACCORDING TO 57/70 PROFILE FROM STA 2206+74.00 TO STA 2213+25.00.

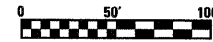
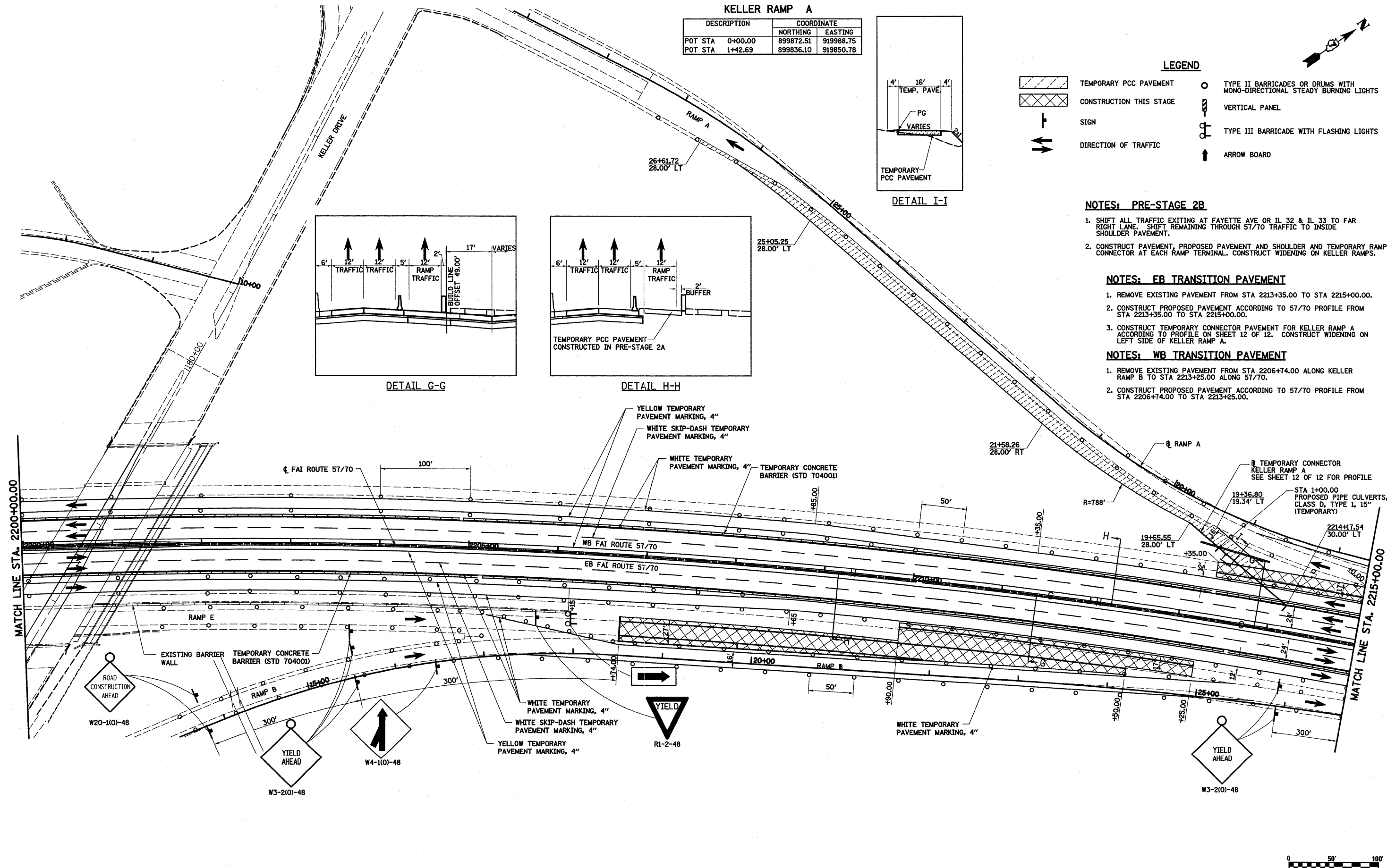

FILE NAME = S:\Projects\403-00072-57-70\dgn\Keller\mof_PSB2.dgn	USER NAME = bseba1	DESIGNED - ESW	REVISED -	<b>STATE OF ILLINOIS DEPARTMENT OF TRANSPORTATION</b>	<b>MAINTENANCE OF TRAFFIC, PRE-STAGE 2B, FAYETTE ROUTE 57/70</b>	F.A.I. RTE. 57/70	SECTION (25-3,4)R	COUNTY EFFINGHAM	TOTAL SHEETS 1098	SHEET NO. 131		
PLOT SCALE = 1/8" = 100' / IN.	CHECKED - BRM	DATE - 5-07-08	REVISED -			SCALE: 1"=50'	SHEET NO. 7 OF 12 SHEETS	STA. 2200+00.00 TO STA. 2215+00.00	FED. ROAD DIST. NO. ILLINOIS FED. AID PROJECT	CONTRACT NO. 74299		
PLOT DATE = 3/18/2011	DATE - 5-07-08	REVISED -	REVISED -									