

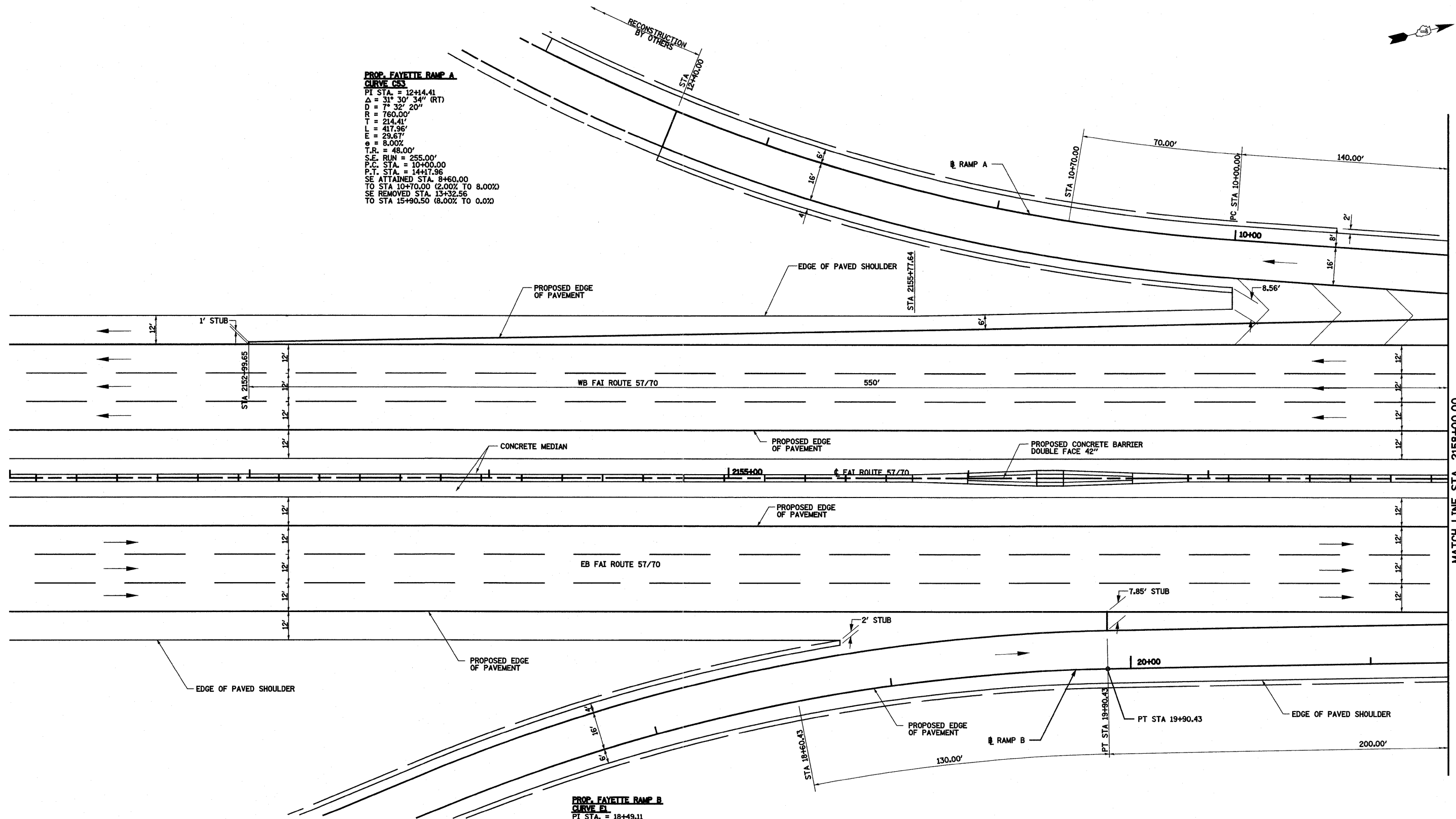

**PROP. FAYETTE RAMP A
CURVE C53**
 P.I. STA. = 12+14.41
 Δ = 31° 30' 34" (RT)
 D = 7° 32' 20"
 R = 760.00'
 T = 214.41'
 L = 417.96'
 E = 29.67'
 ϵ = 8.00%
 T.R. = 48.00'
 S.E. RUN = 255.00'
 P.C. STA. = 10+00.00
 P.T. STA. = 14+17.96
 SE ATTAINED STA. 8+60.00
 TO STA 10+70.00 (2.00% TO 8.00%)
 SE REMOVED STA. 13+32.56
 TO STA 15+90.50 (8.00% TO 0.0%)

**PROP. FAYETTE RAMP B
CURVE D1**
 P.I. STA. = 18+49.11
 Δ = 21° 34' 00" (RT)
 D = 7° 32' 20"
 R = 760.00'
 T = 144.75'
 L = 286.07'
 E = 13.66'
 ϵ = 8.00%
 T.R. = N/A
 S.E. RUN = 207.00'
 P.C. STA. = 17+04.36
 P.T. STA. = 19+90.43
 SE ATTAINED STA. 15+82.36
 TO STA 17+89.36 (1.50% TO 8.00%)
 SE REMOVED STA. 18+60.43
 TO STA 21+90.42 (8.00% TO 3.26%)



MATCH LINE STA. 2158+00.00

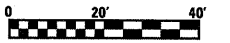

FILE NAME = S:\projects\105-000\105-70\Drawings\105-70-ramp.dwg	USER NAME = John	DESIGNED - ESW	REVISED -	STATE OF ILLINOIS DEPARTMENT OF TRANSPORTATION	INTERCHANGE RAMP TERMINAL DETAIL, RAMPS A & B, FAYETTE AVE.	F.A.I. RTE. 57/70	SECTION (25-3,4)R	COUNTY EFFINGHAM	TOTAL SHEETS 1098	SHEET NO. 195	
PLOT SCALE = 48,000 / IN.	CHECKED - BRM	REVISED -	SCALE: 1"=20'			SHEET NO. 4 OF 5 SHEETS	STA. 2152+00.00 TO STA. 2158+00.00	FED. ROAD DIST. NO.	ILLINOIS FED. AID PROJECT	CONTRACT NO. 74299	
PLOT DATE = 3/20/2011	DATE - 4-25-08	REVISED -									