

**PROP. KELLER DR.
RAMP A CURVE CS6**
 PI STA. = 15+02.68
 $\Delta = 2^\circ 26' 23''$ (LT)
 $D = 1^\circ 16' 24''$
 $R = 4,500.00'$
 $T = 95.88'$
 $L = 191.74'$
 $E = 1.02'$
 $\phi = 8.00\%$
 P.C. STA. = 14+06.79
 P.T. STA. = 15+98.53

**PROP. KELLER DR.
RAMP A CURVE CS8**
 PI STA. = 19+83.27
 $\Delta = 26^\circ 53' 22''$ (RT)
 $D = 7^\circ 32' 20''$
 $R = 760.00'$
 $T = 181.68'$
 $L = 356.68'$
 $E = 21.42'$
 $\phi = 8.00\%$
 T.R. = 48.00'
 S.E. RUN = 255.00'
 P.C. STA. = 18+01.59
 P.T. STA. = 21+58.26
 SE ATTAINED STA. 16+61.89
 TO STA 18+71.59 (1.50% TO 8.00%)
 SE REMOVED STA. 20+73.26
 TO STA 23+76.26 (8.00% TO -1.50%)

**PROP. KELLER DR.
RAMP B CURVE CS30**
 PI STA. = 26+17.30
 $\Delta = 8^\circ 25' 37''$ (RT)
 $D = 1^\circ 16' 54''$
 $R = 4,470.56'$
 $T = 329.36'$
 $L = 657.53'$
 $E = 12.12'$
 $\phi = 4.50\%$
 T.R. = N/A
 S.E. RUN = 120.00'
 P.C. STA. = 22+87.95
 P.T. STA. = 29+45.47
 SE ATTAINED STA. 22+27.95
 TO STA 23+47.95 (1.50% TO 4.50%)
 SE REMOVED STA. 26+15.38
 TO STA 29+45.47 (4.50% TO 2.90%)

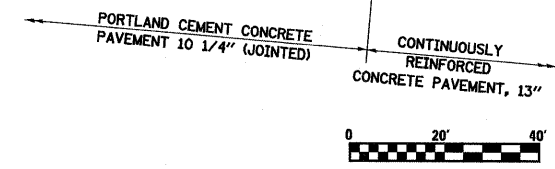
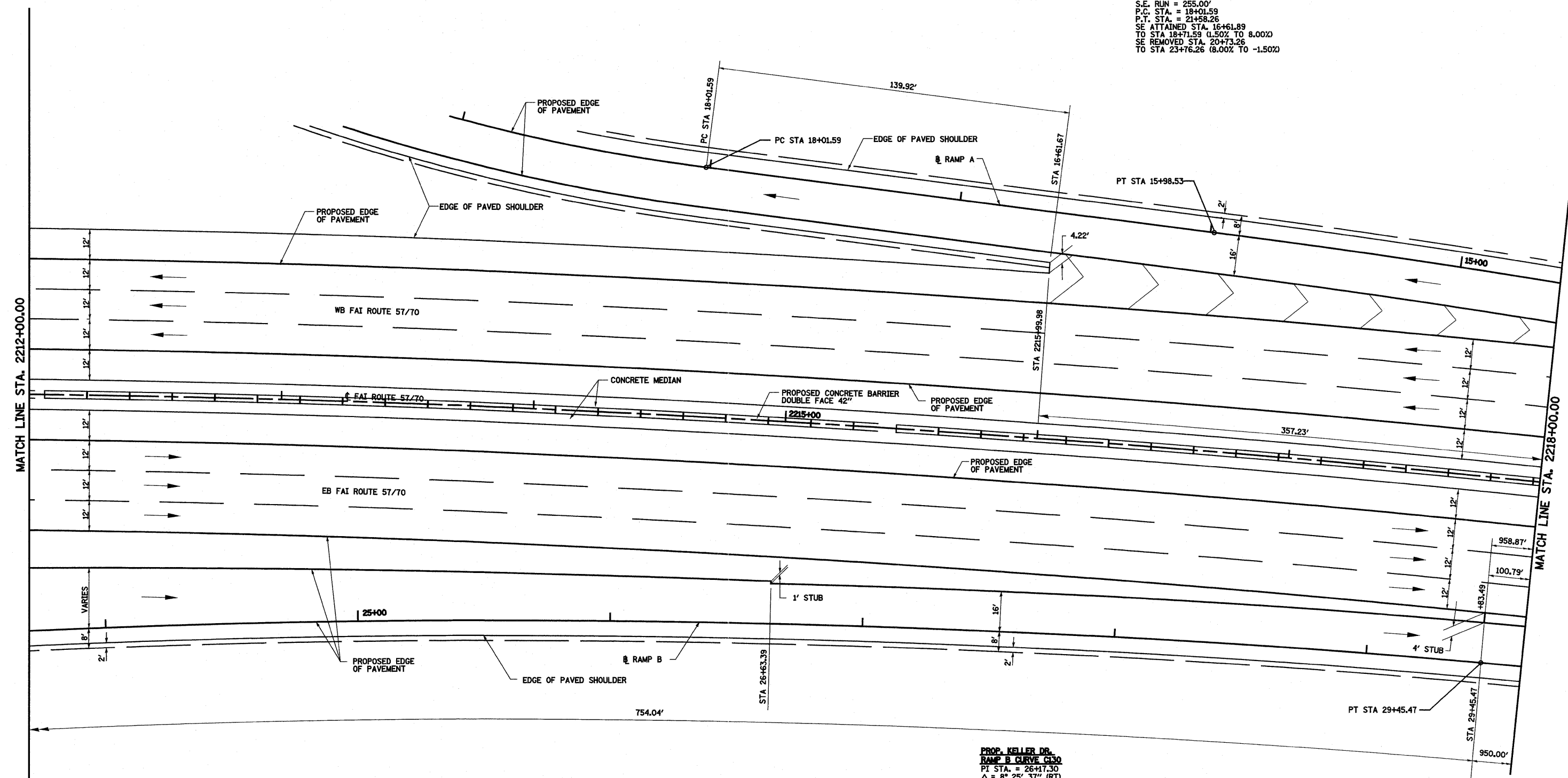

FILE NAME = S:\projects\08-25-08\757-79\plan\Keller\comp.dwg	USER NAME = John	DESIGNED - ESW	REVISED -	STATE OF ILLINOIS DEPARTMENT OF TRANSPORTATION	INTERCHANGE RAMP TERMINAL DETAIL, RAMPS A & B, KELLER DRIVE		F.A.I. RTE. 57/70	SECTION (25-3,4)R	COUNTY EFFINGHAM	TOTAL SHEETS 1098	SHEET NO. 216	
PLOT SCALE = 1/8" = 10'-0"	PLOT DATE = 3/20/2011	DRAWN - PDB	REVISED -		SCALE: 1"=20'	SHEET NO. 5 OF 7 SHEETS	STA. 2212+00.00 TO STA. 2218+00.00	CONTRACT NO. 74299				
		CHECKED - BRM	REVISED -		FED. ROAD DIST. NO. ILLINOIS FED. AID PROJECT							
		DATE - 4-25-08	REVISED -									