

DATE	
BY	
FINAL SURVEY	SURVEYED
NOTE BOOK NO.	PLOTTED
	TEMPLATE
	AREAS CHECKED

DATE	
BY	
ORIGINAL SURVEY	SURVEYED
NOTE BOOK NO.	PLOTTED
	TEMPLATE
	AREAS CHECKED

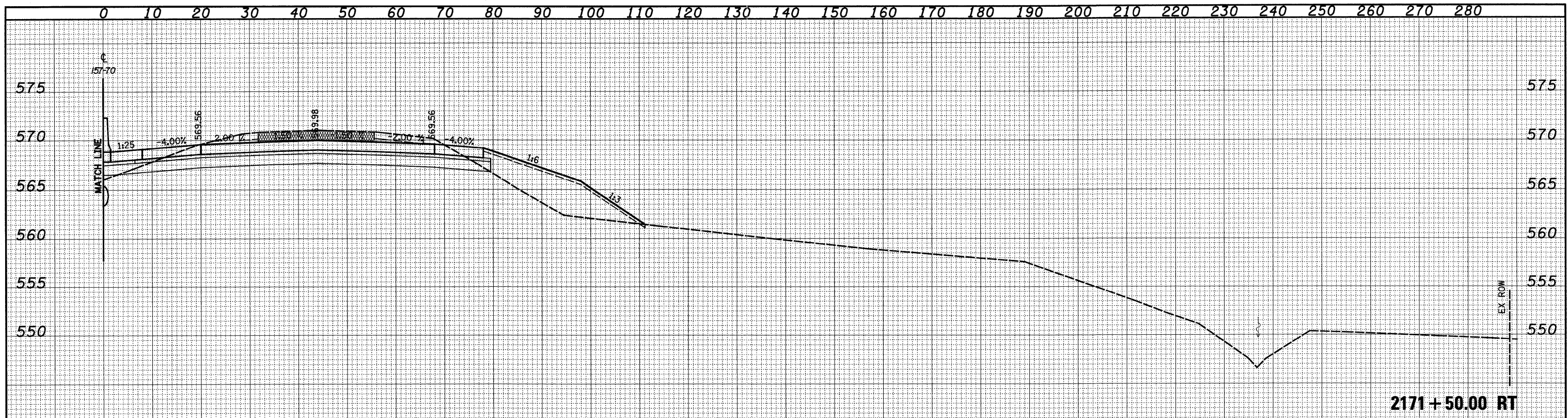

2171+50.00 RT

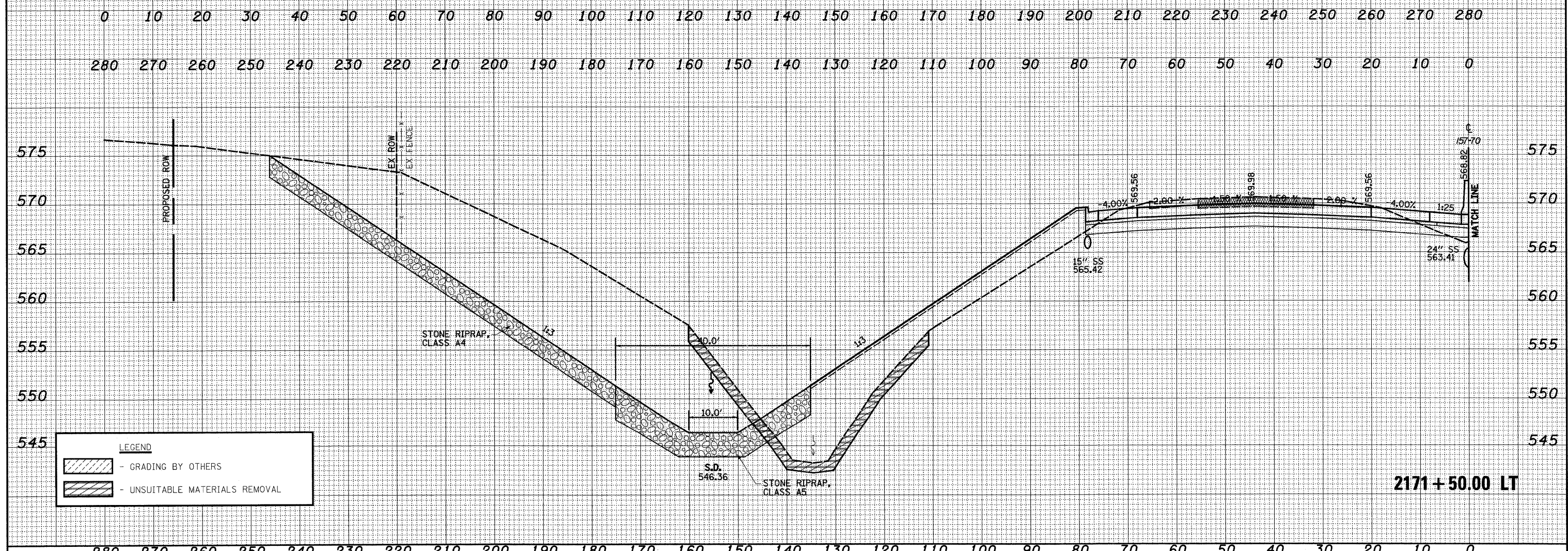

2171+50.00 LT

LEGEND	
	- GRADING BY OTHERS
	- UNSUITABLE MATERIALS REMOVAL

FILE NAME =	USER NAME = John	DESIGNED - JWS	REVISED -	STATE OF ILLINOIS DEPARTMENT OF TRANSPORTATION	CROSS SECTIONS FAI 57/70	F.A.I. RTE. 57/70	SECTION (25-3,4R)	COUNTY EFFINGHAM	TOTAL SHEETS 1098	SHEET NO. 512	
PROJECT NO. 2007-2-7700-01-001	PLOT SCALE = 20.0000' / IN.	DRAWN - LEC	REVISED -			SCALE: 1"=10'	SHEET NO. 86 OF 199 SHEETS	FED. ROAD DIST. NO. (ILLINOIS) FED. AID PROJECT		CONTRACT NO. 74299	
	PLOT DATE = 3/20/2011	CHECKED - BRM	REVISED -			STA. 2171+50.00 TO STA. 2171+50.00					
		DATE - 4-01-08	REVISED -								