

PAVEMENT MARKING LEGEND

- 1 4" (100) SKIP-DASH (YELLOW)
- 2 4" (100) SOLID (YELLOW)
- 3 12" (300) DIAGONAL (YELLOW)
- 4 4" (100) DOUBLE YELLOW (NARROW)
- 5 12" (300) SOLID WHITE
- 6 RESERVED
- 7 6" (150) SKIP-DASH (WHITE)
- 8 4" (100) SOLID (WHITE)
- 9 12" (300) DIAGONAL (WHITE)
- 10 6" (150) SOLID (WHITE)
- 11 24" (600) STOP BAR (WHITE)
- 12 8" (200) SOLID (WHITE)
- 13 4" (100) PARKING WHITE

TYPICAL PAVEMENT MARKERS LEGEND

- ◆ TWO-WAY AMBER MARKER
- ▶ ONE-WAY AMBER MARKER
- ▷ ONE-WAY CRYSTAL MARKER

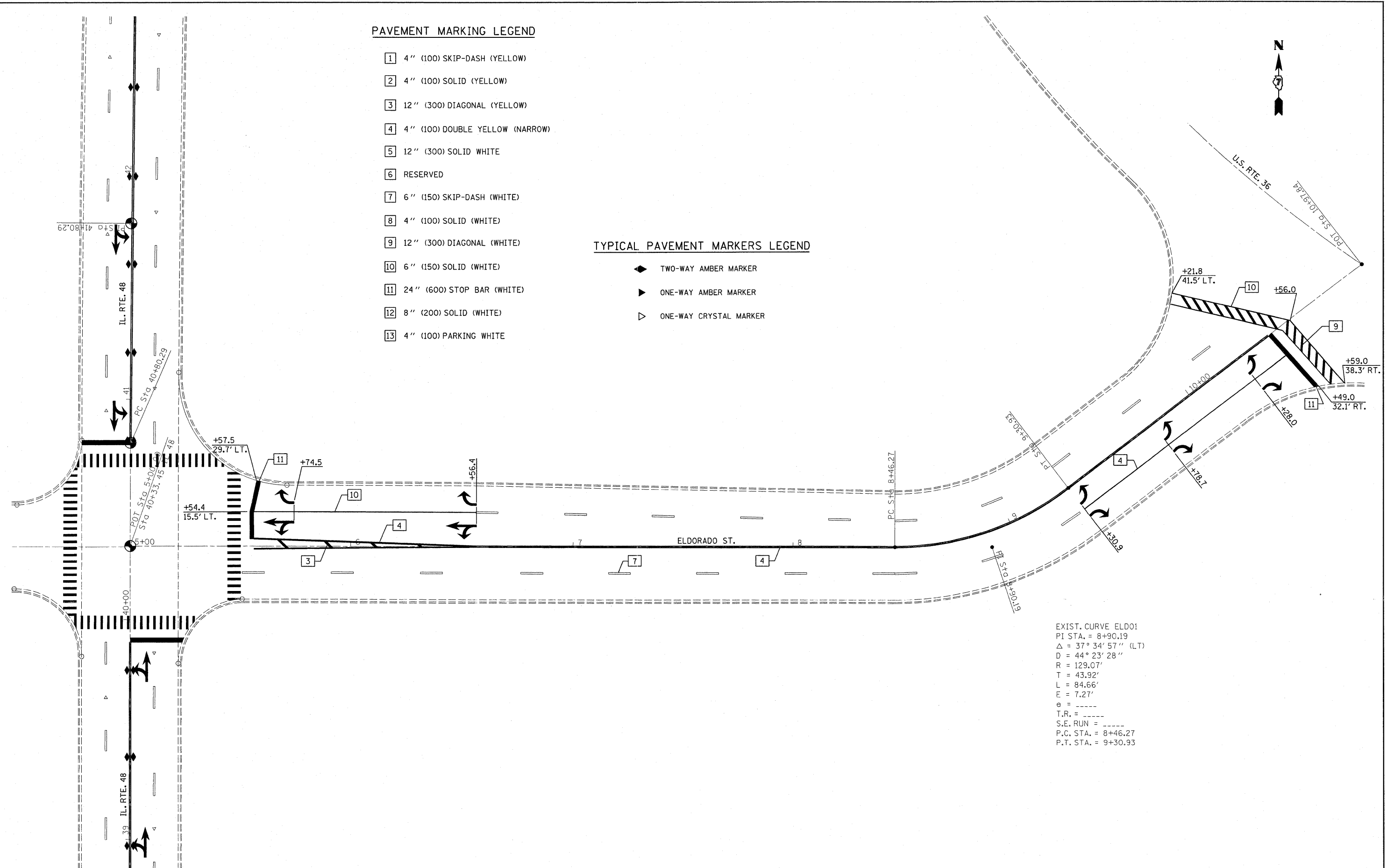

EXIST. CURVE ELD01
 PI STA. = 8+90.19
 $\Delta = 37^\circ 34' 57''$ (LT)
 D = 44' 23' 28"
 R = 129.07'
 T = 43.92'
 L = 84.66'
 E = 7.27'
 e = -----
 T.R. = -----
 S.E. RUN = -----
 P.C. STA. = 8+46.27
 P.T. STA. = 9+30.93

FILE NAME =	USER NAME = swartzrw	DESIGNED -	REVISED -	STATE OF ILLINOIS DEPARTMENT OF TRANSPORTATION	STRIPING PLAN DETAIL			F.A.P. RTE.	SECTION	COUNTY	TOTAL SHEETS	SHEET NO.
ca:\pw\work\pwidot\swartzrw\d0212489\d77	500-sht-striping.dgn	DRAWN -	REVISED -		716	•(127R,RS-2)(130R-2,RS-1)	MACON	98	74			
PLOT SCALE = 20,0000' / in.		CHECKED -	REVISED -		CONTRACT NO. 74500							
PLOT DATE = 10/13/2011		DATE -	REVISED -		ILLINOIS FED. AID PROJECT							
				SCALE: 20	SHEET NO. 19 OF 19 SHEETS	STA.	TO STA.					