

STAGE 2A TRAFFIC CONTROL ITEMS

| TEMPORARY PAVEMENT MARKING - 4" LINE MARKING | TEMPORARY PAVEMENT MARKING - 8" LINE MARKING | WORK ZONE PAVEMENT MARKING REMOVAL |
|--|--|------------------------------------|
| FOOT | FOOT | SQ FT |
| 7,900 | 1,600 | 2,600 |

PRIOR TO STAGE 2A, REMOVE APPROXIMATELY 1415 LINEAR FEET OF TEMPORARY CONCRETE BARRIER ASSOCIATED WITH STRUCTURES 082-0167/-0168. ALSO PRIOR TO STAGE 2A, REMOVE TEMPORARY IMPACT ATTENUATORS PLACED AT STATIONS 240+21.00 AND 252+31.76 WITH STAGE 2. ALL OTHER BARRIERS AND ATTENUATORS PLACED IN STAGE 2 OR PREVIOUS STAGES SHALL REMAIN.

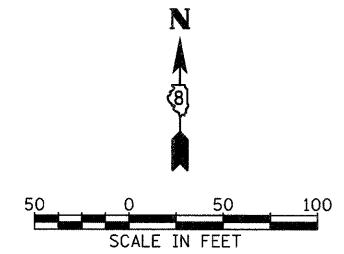

ALL TEMPORARY PAVEMENT MARKINGS AND BARRICADES PLACED IN STAGE 2 WEST OF STATION 229+01.51 SHALL REMAIN. SIGNS AND DEVICES ASSOCIATED WITH EASTBOUND RIGHT LANE CLOSURE SHALL BE REMOVED.

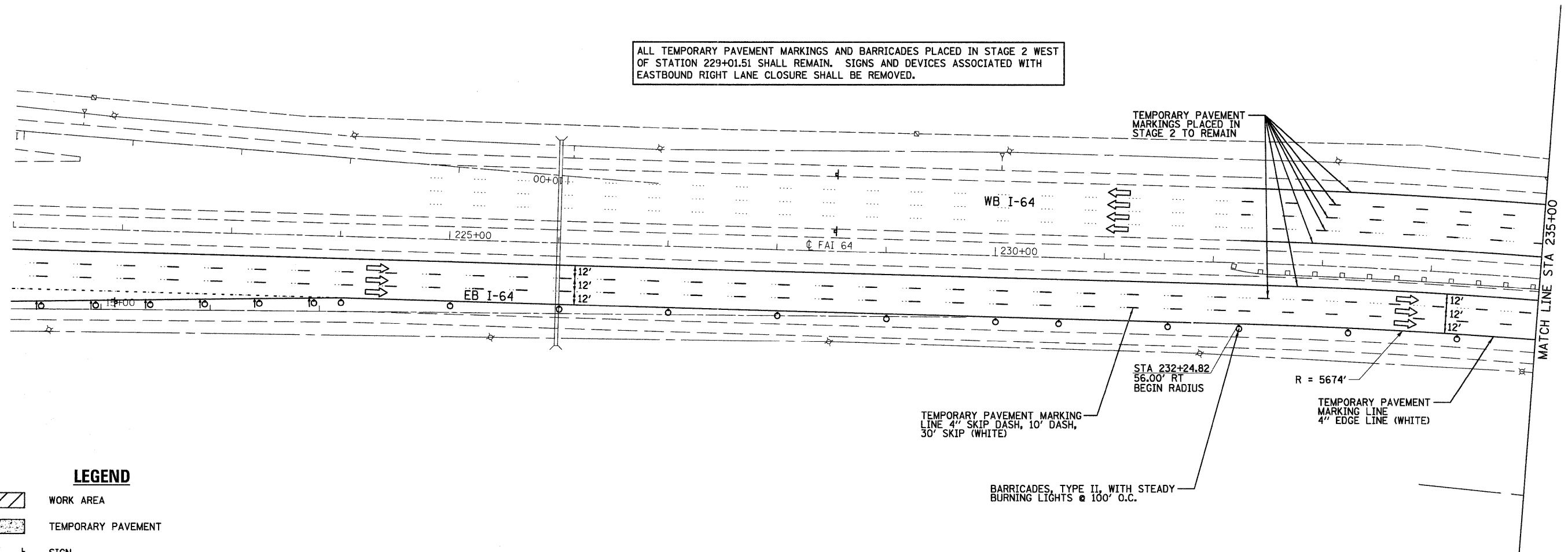

LEGEND

- WORK AREA
- TEMPORARY PAVEMENT
- SIGN
- DIRECTIONAL INDICATOR BARRICADE WITH STEADY BURNING LIGHTS
- TYPE II BARRICADES, DRUMS, OR VERTICAL BARRICADES WITH STEADY BURNING LIGHTS
- TYPE III BARRICADE
- TEMPORARY IMPACT ATTENUATOR
- TEMPORARY CONCRETE BARRIER
- PROPOSED PAVEMENT MARKING
- EXISTING PAVEMENT MARKING
- DIRECTIONAL ARROW (FOR INFORMATIONAL PURPOSES ONLY, DO NOT PAINT ON ROADWAY)

FILE NAME =
DB76415-sht-Staging2A-01.dgn

USER NAME = tbonnell

DESIGNED -

REVISED -

DRAWN -

REVISED -

PLOT SCALE = 50.0000' / 1" =

CHECKED -

REVISED -

PLOT DATE = 11/18/2011

DATE -

REVISED -

STATE OF ILLINOIS
DEPARTMENT OF TRANSPORTATION

SUGGESTED STAGES OF CONSTRUCTION AND
TRAFFIC CONTROL - STAGE 2A

SCALE: 1"=50'

SHEET NO. 1 OF 3 SHEETS

STA. 221+00 TO STA. 235+00

F.A.I.
RTE.

SECTION

COUNTY

TOTAL SHEETS
SHEET NO.

64

82-(3,4)RS

ST. CLAIR

167 51

CONTRACT NO. 76415

FED. ROAD DISTRICT 8 ILLINOIS FED. AID PROJECT