

NOTES:
 1. CONTRACTOR SHALL ADJUST LOCATION OF ADVANCED WARNING SIGNS AS DIRECTED BY THE ENGINEER.
 2. IN ADDITION TO SIGNS SHOWN, ALL SIDEROADS SHALL HAVE "ROAD CONSTRUCTION AHEAD" SIGNS. THE COST SHALL BE INCLUDED IN THE TRAFFIC CONTROL STANDARDS FOR THE PROJECT.

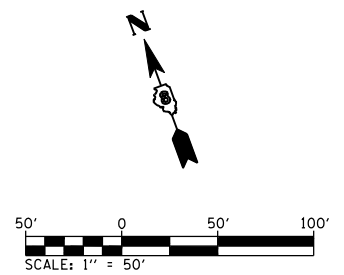

ADVANCED WARNING SIGNS:

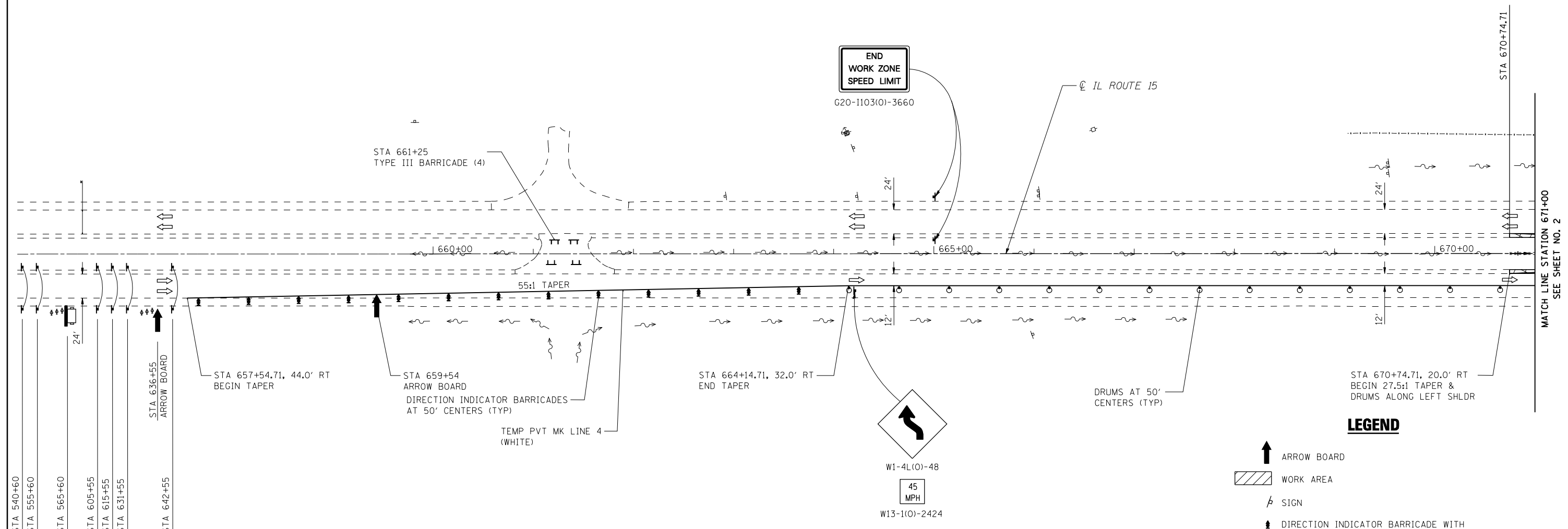
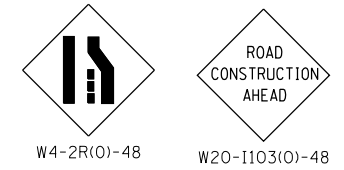

LEGEND

- ARROW BOARD
- WORK AREA
- SIGN
- DIRECTION INDICATOR BARRICADE WITH STEADY BURN MONODIRECTIONAL LIGHT
- TYPE II BARRICADE WITH STEADY BURN MONODIRECTIONAL LIGHT
- DRUM WITH STEADY BURN MONODIRECTIONAL LIGHT
- VERTICAL PANEL (BACK TO BACK)
- TYPE III BARRICADE
- TEMPORARY CONCRETE BARRIER
- TEMPORARY PAVEMENT CONSTRUCTED IN PRESTAGE
- PORTABLE CHANGEABLE MESSAGE SIGN
- TEMPORARY IMPACT ATTENUATOR

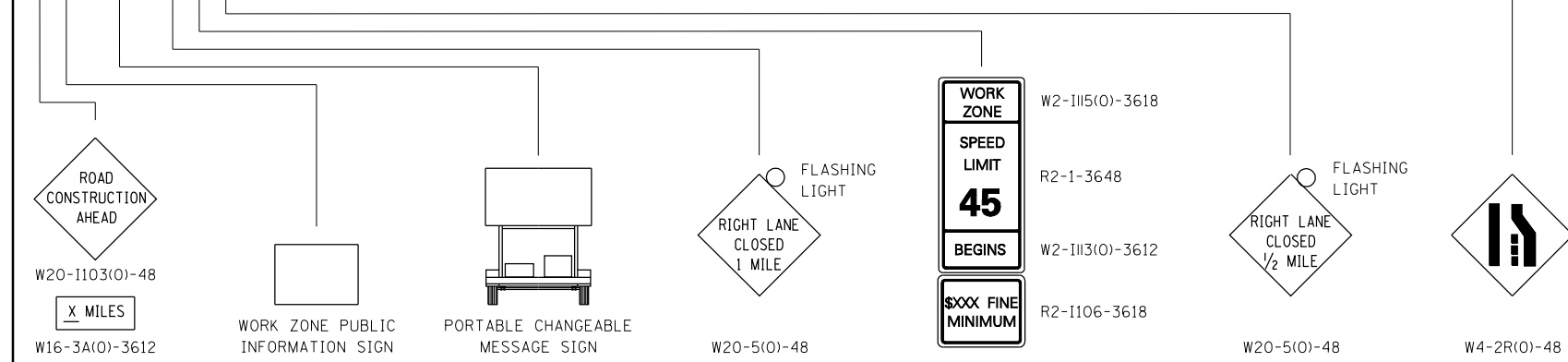

FILE NAME = D876884-sht-staging.dgn	USER NAME = rjo	DESIGNED - R.J.O.	REVISED -	STATE OF ILLINOIS DEPARTMENT OF TRANSPORTATION	IL ROUTE 15 SUGGESTED STAGES OF CONSTRUCTION AND TRAFFIC CONTROL STAGE 1		F.A.P. RTE. 103	SECTION 27-1-VHB-1	COUNTY ST. CLAIR	TOTAL SHEETS 277	SHEET NO. 35
	PLOT SCALE = 100.0000' / IN.	CHECKED - A.T.M.	REVISED -		SCALE: 1"=50'	SHEET NO. 1 OF 7 SHEETS	STA. 659+76.81 TO STA. 671+00.00	CONTRACT NO. 76884		ILLINOIS FED. AID PROJECT	
	PLOT DATE = 10/17/2011	DATE - 10/19/11	REVISED -								