

BILL OF MATERIAL

ITEM	UNIT	TOTAL
Removal of Existing Structures No. 1	Each	1
Removal of Existing Structures No. 2	Each	1

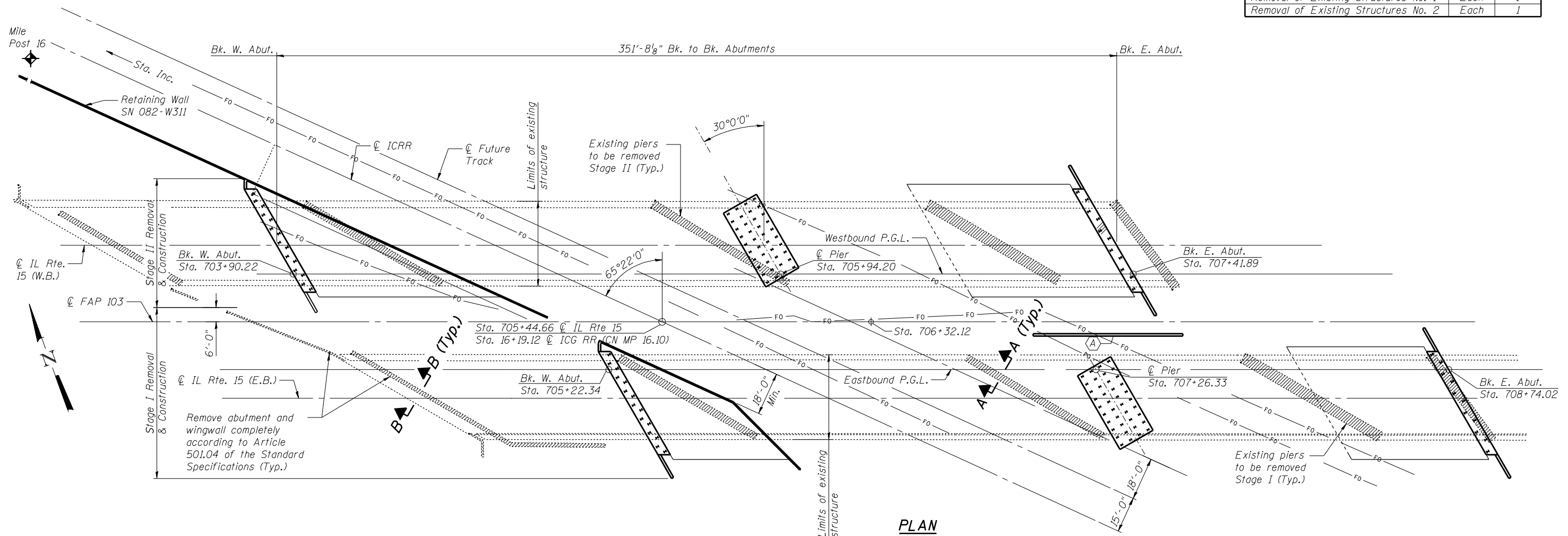

PLAN

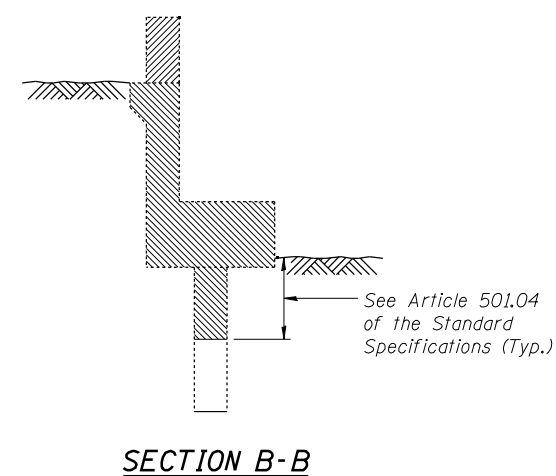
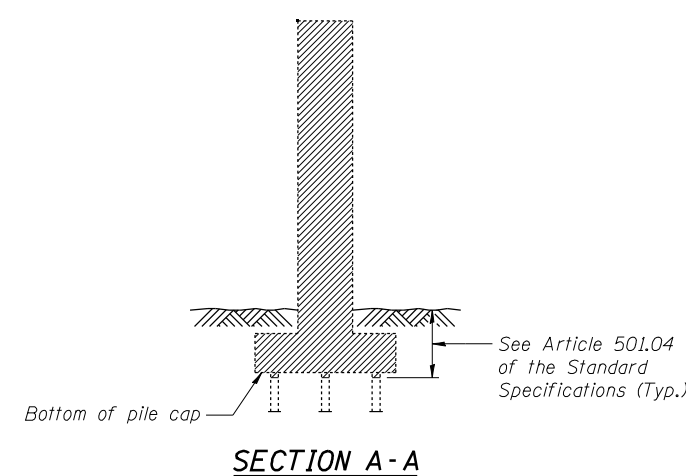

(A) (B) Face of MSE Wall (height less than 7 feet)
See Sht. S-49 of S-62 for details

Note:
For abutment pile layout, see Sheets S-40 through S-43 of S-62.
For pier pile layout, see Sheets S-45 & S-47 of S-62.

LEGEND
Structure Removal

FILE NAME = 0820117-0118-76884-003-FOUNDATION.Plan.dgn



USER NAME = brazzera	DESIGNED - RAB	REVISED -
PLOT SCALE = 42x8.0000 '1' / IN.	CHECKED - BTO	REVISED -
PLOT DATE = 10/19/2011	DRAWN - RAB	REVISED -
	CHECKED - BTO	REVISED -

**STATE OF ILLINOIS
DEPARTMENT OF TRANSPORTATION**

**FOUNDATION PLAN
STRUCTURE NO. 082-0117 (E.B.) & 082-0118 (W.B.)**

F.A.P. RTE. 103	SECTION 27-1-VHB-1	COUNTY ST. CLAIR	TOTAL SHEETS 277	SHEET NO. 118
				CONTRACT NO. 76884
ILLINOIS FED. AID PROJECT				

SHEET NO. S-3 OF S-62 SHEETS