

PROJECT NO.	SEC.	COUNTY	TOTAL SHEETS	SHEET NO.
R.A.T.-70	82-10M	ST. CLAIR	35	14
DATE JULY 1960 CHICAGO, ILLINOIS SHEET NO. 4				

NO. B-6

NO. B-7

NO. B-8

ELEV.	Ground surface	Ground surface	Ground surface
420	Elev. 417.6	Elev. 416.2	Elev. 417.7
415	Brown silty clay topsoil 12 3'-0"	Cinder fill 2 2'-0"	Dark brown silty clay topsoil 10 3'-0"
	Brown silty clay 9 6'-0"	Brown silty clay 7 6'-0"	Brown silty clay 8 6'-0"
410	Brown silt & very fine sand trace clay 9	Brown silt & very fine sand with clay 7	Brown very fine silty sand 6
405	Brown very fine sand 6	Brown silt & very fine sand with clay 3	Brown silt & very fine sand 5 13'-0"
400	Gray silt 10 16'-0"	Brown fine to medium sand, trace clay 3	Brown & gray clayey silt with thin sand seams 4 16'-0"
395	Brown silt & very fine sand 3	Brown fine to medium sand, trace clay 20	Brown & gray clayey silt with thin sand seams 5 23'-0"
390	Gray fine sand 6 21'-0"	Brown fine to medium sand, trace clay 20	Brown fine sand trace silt 29 26'-0"
385	Gray fine to coarse sand 29 32'-0"	Brown medium to coarse sand 20	Gray clayey silt with very fine sand 5 35'-0"
380	Gray medium to coarse sand trace clay & small gravel 51 36'-0"	Brown medium to coarse sand 20	Gray clayey silt & very fine sand 18 38'-0"
375	Gray medium to coarse sand trace small gravel 9	Brown medium to coarse sand 7	Gray medium to coarse sand with small gravel 52
370	Gray medium to coarse sand trace small gravel 10	Gray fine sand 28	Gray medium to coarse sand with small gravel 45
365	Gray fine sand 46	Gray fine sand 28	Gray medium to coarse sand trace large gravel 15
360	Gray fine sand 46	Gray medium sand 28	Gray, very fine silty sand 17
355	Gray fine to coarse sand 20	Gray medium sand 28	Gray fine sand with silt 40
350	Gray fine to coarse sand 20	Gray medium sand 28	Gray fine sand with silt 40
345	Gray fine to coarse sand 20	Gray fine sand 28	Gray fine to coarse sand with sm to med gravel 40
340	Gray fine to coarse sand 20	Gray fine sand 28	Gray fine sand 31
335	Gray fine to coarse sand 20	Gray fine sand 28	Gray fine sand 31
330	Gray fine to coarse sand 20	Gray fine sand 28	Gray fine sand 21
325	Gray fine to coarse sand 20	Gray fine sand 28	Gray fine sand 45

Boring stopped by Mr. Hanson

Refusal - Rock or boulder
Boring bailed to 10'-0"

Boring stopped by Mr. Hanson.
Boring bailed to 55'-0"

Used 60'-0" of 2 1/2" casing.
Water levels below ground surface
17'-0" with casing at 69'-0"
47'-0" with casing at 84'-0"
51'-0" with casing at 69'-0"
51'-0" 1 1/2 hours after completion.

Used 60'-2" of 2 1/2" casing.
Water levels below ground surface
33'-0" 1 1/2 hours
caved - 23'-0" 28 hours after completion

Used 60'-0" of 2 1/2" casing.
Water levels below ground surface.
31'-0" 1 hour
caved - 30'-0" 2 1/2 hours after completion

* Circulating water loss in strata
Date: March 10, 1958

NOTES:

- Classifications are made by visual inspection.
- Water levels (W.L.) figure indicates time of reading (based after completion of boring). Water levels indicated are those observed when borings were made or as noted. Porosity of the soil strata, variations of rainfall, site topography, etc., may cause changes in these levels.
- Figures in right hand column indicate number of blows required to drive 2" diameter sampling pipe casing, using 140-lb weight falling 30 inches.

Designed by: R.D.
Drawn by: R.B.
Checked by: P.D.

EXCAVATION QUANTITIES FOR BRIDGE & NORTH EAST NINE HALL	
Class II Excav. for structure	sq. 2,500
Special Excav. (Phase I)	sq. 82,500
Special Excav. (Phase II)	sq. 16,900

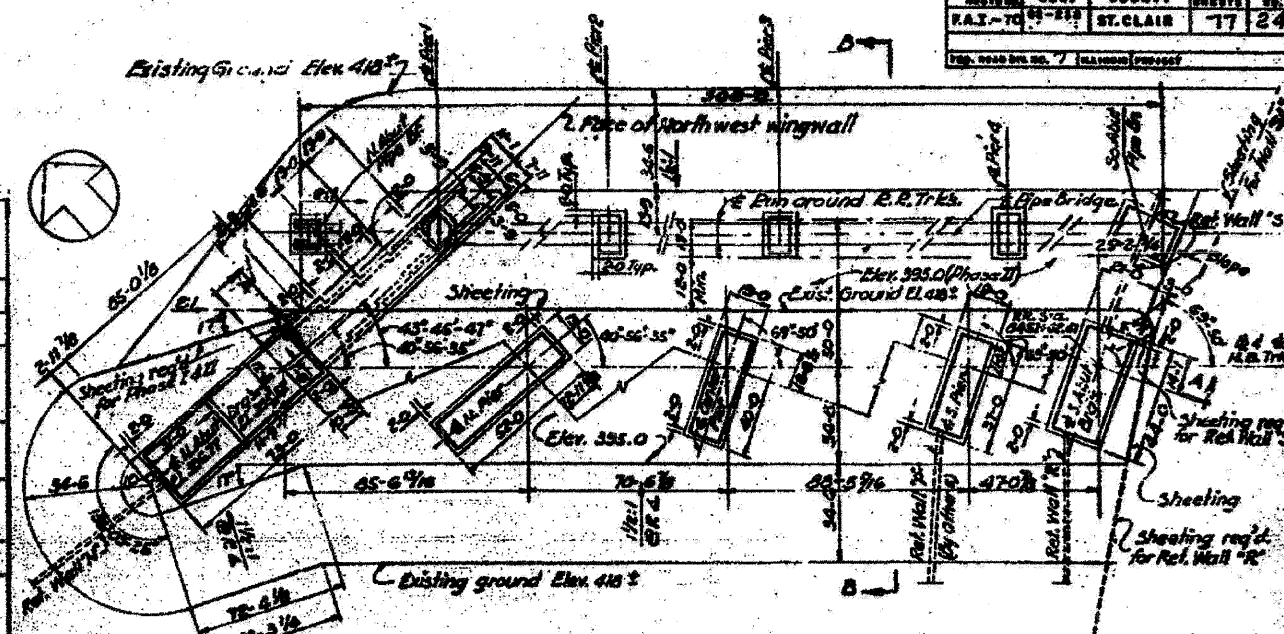

EXCAVATION PLAN

Note: For excavation and sheeting required for Ret Walls, see highway plans.

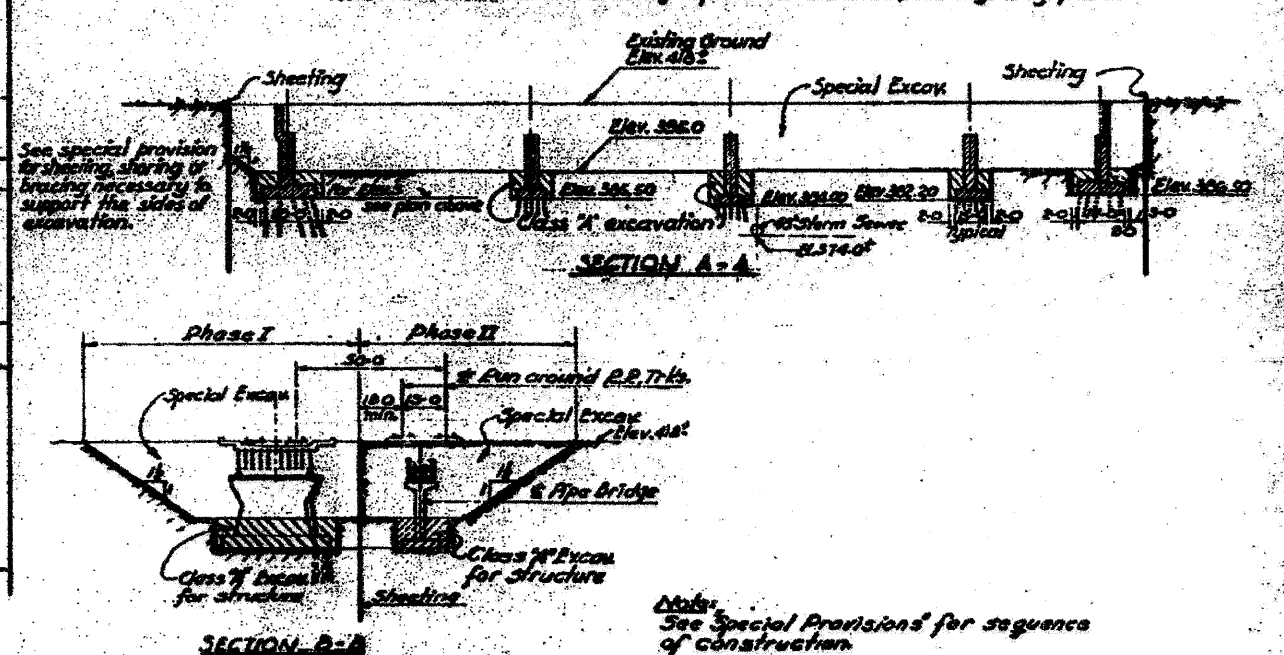

Notes: See Special Provisions for sequence of construction.

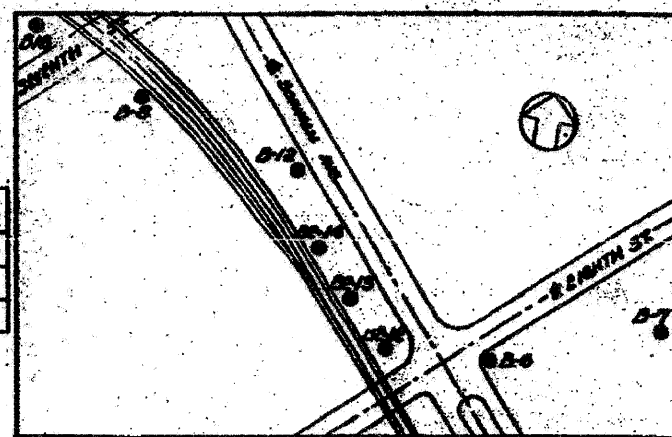

LOCATION PLOT OF BORINGS

STATE OF ILLINOIS
DEPARTMENT OF PUBLIC WORKS & BLDGS.
DIVISION OF HIGHWAYS
CITY OF EAST ST. LOUIS
EAST ST. LOUIS EXPRESSWAY
L. & N. R.R. OVER WEST BOUND EXPWAY,
RAMP "L" EAST BOUND EXPWAY AND RAMP "C"
BORING LOGS & EXCAVATION PLAN

H. W. LOCHNER, INC.
ENGINEERS
DATE JULY 1960 CHICAGO, ILLINOIS SHEET NO. 4