

**CONTROL POINT #NDCP11**  
 STA. 1489+21.72, 57.23' RT.  
 N=391795.053 E=803574.287  
 ELEV=470.197

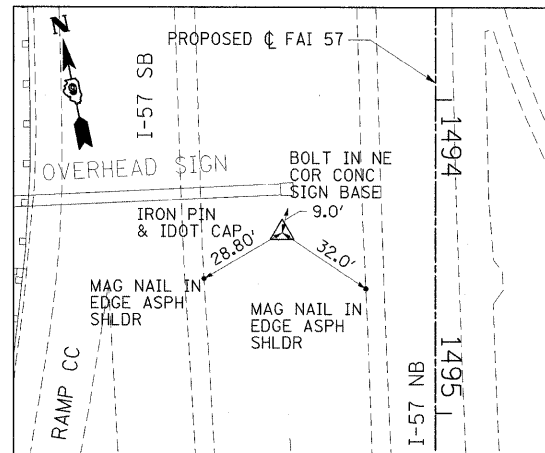

**CONTROL POINT #ND4**  
 STA. 1494+42.39, 48.79' RT.  
 N=391264.321 E=803470.761  
 ELEV=466.446

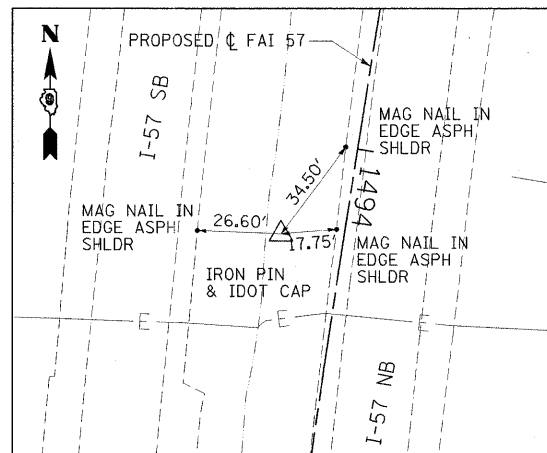

**CONTROL POINT #ND2697**  
 STA. 1499+30.43, 19.90' RT.  
 N=390777.816 E=803408.039  
 ELEV=461.196

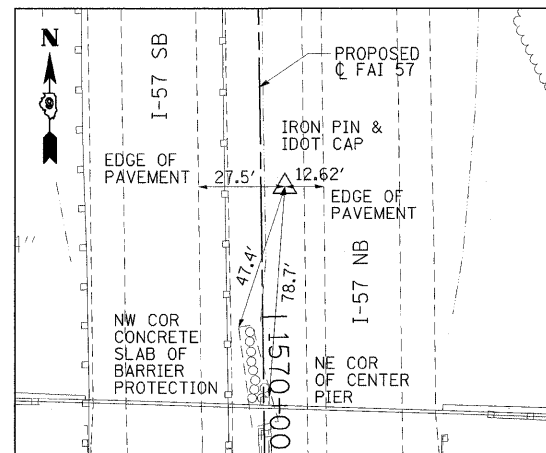

**CONTROL POINT #WN100**  
 STA. 1569+58.42, 7.68' LT.  
 N=383745.276 E=803447.319  
 ELEV=469.986

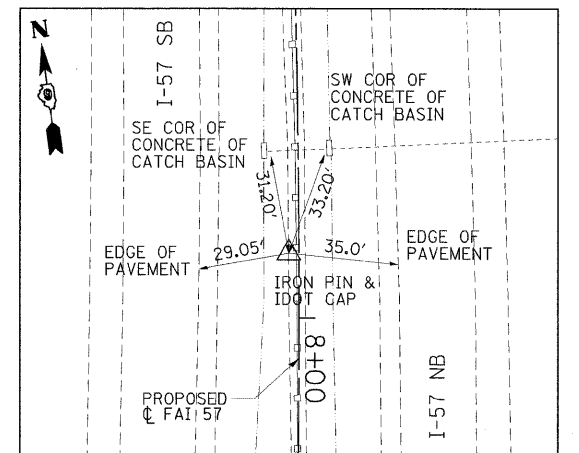

**CONTROL POINT #WS104**  
 STA. 7+79.11, 3.18' LT.  
 N=382634.747 E=803411.539  
 ELEV=473.073

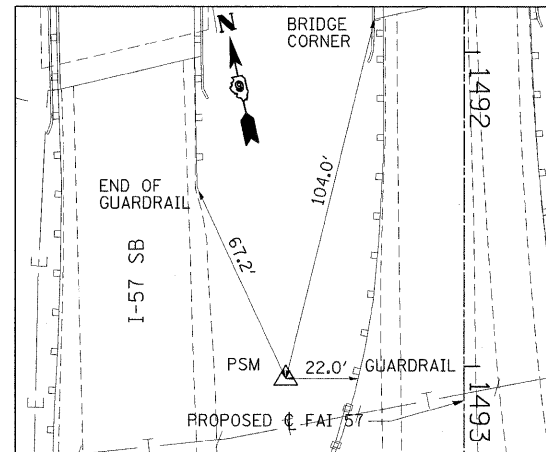

**CONTROL POINT #NDCP10**  
 STA. 1493+03.95, 56.62' RT.  
 N=391401.390 E=803491.729  
 ELEV=468.568

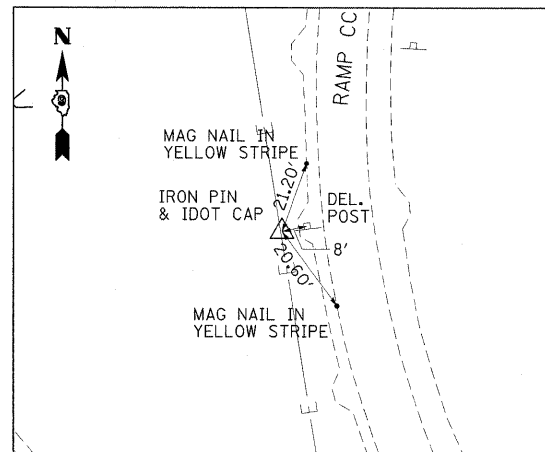

**CONTROL POINT #ND8791**  
 STA. 1496+00.11, 566.18' RT.  
 N=391213.933 E=802931.412  
 ELEV=450.199

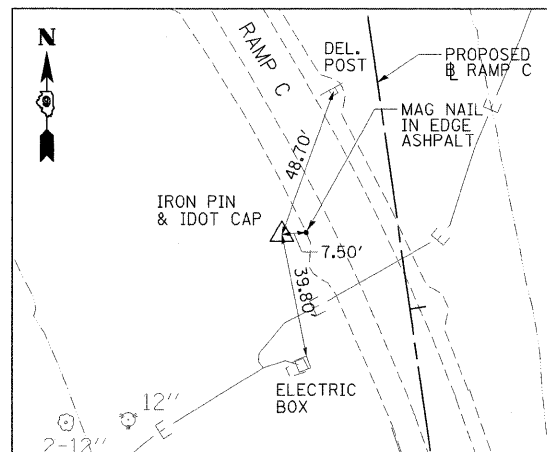

**CONTROL POINT #ND8792**  
 STA. 1500+93.76, 196.43' RT.  
 N=390637.904 E=803201.169  
 ELEV=454.535

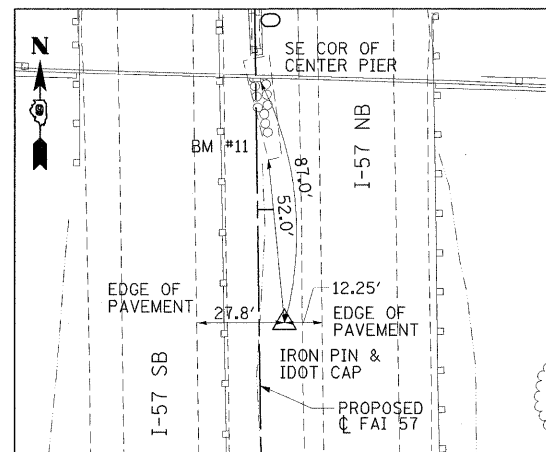

**CONTROL POINT #WS101**  
 STA. 1571+36.11, 8.14' LT.  
 N=383567.612 E=803450.351  
 ELEV=470.534

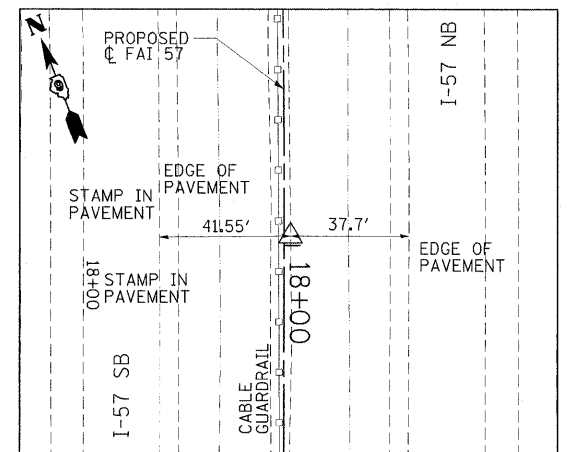

**CONTROL POINT #WS105**  
 STA. 17+97.07, 2.08' LT.  
 N=381667.198 E=803167.872  
 ELEV=474.343

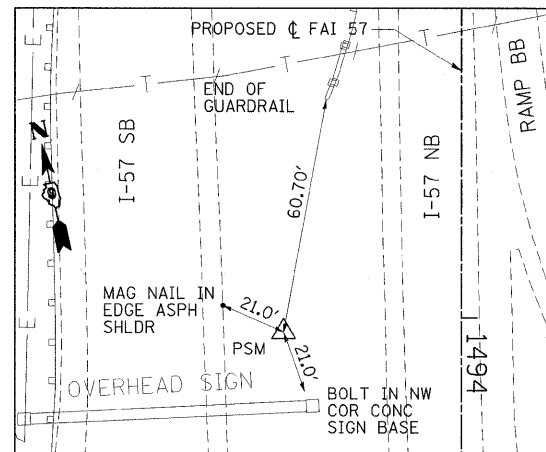

**CONTROL POINT #NDCP9**  
 STA. 1494+04.50, 56.46' RT.  
 N=391302.975 E=803471.091  
 ELEV=467.113

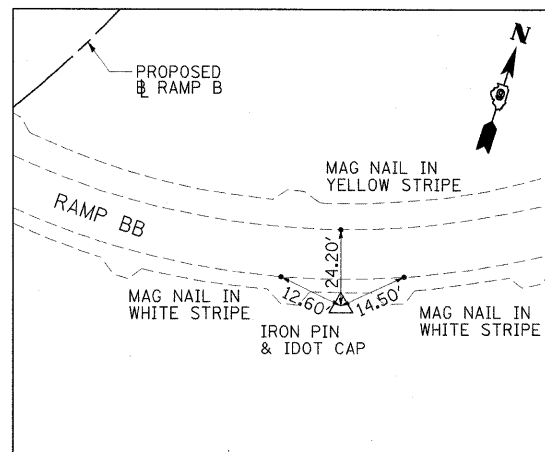

**CONTROL POINT #ND2695**  
 STA. 1495+75.08, 479.90' LT.  
 N=391025.955 E=803960.771  
 ELEV=458.420

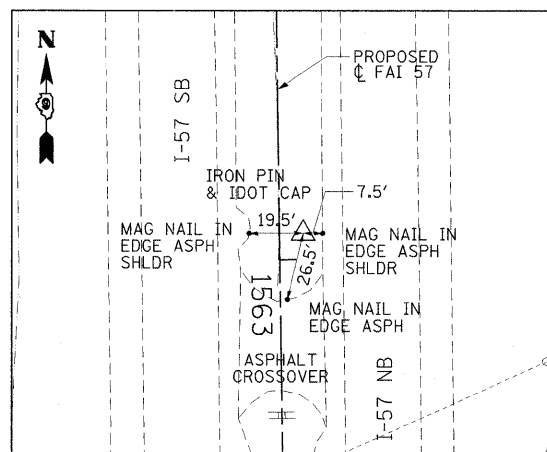

**CONTROL POINT #ND9730**  
 STA. 1562+91.63, 7.54' LT.  
 N=384411.994 E=803437.522  
 ELEV=467.947

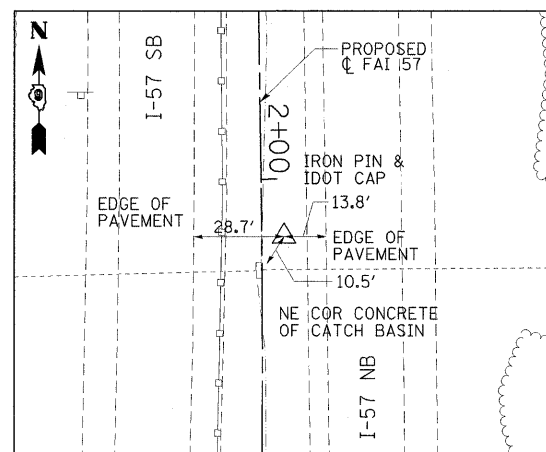

**CONTROL POINT #WS102**  
 STA. 2+18.39, 7.18' LT.  
 N=383193.718 E=803454.774  
 ELEV=470.498

**NOTES:**

- HORIZONTAL CONTROL BASED ON THE ILLINOIS STATE PLANE COORDINATES NAD 83 (1997 ADJUSTMENT) EAST ZONE.
- VERTICAL CONTROL BASED ON NAVD (1988).
- HORIZONTAL AND VERTICAL CONTROL FOR THIS PROJECT BASED ON DIFFERENT DATUM THAN RECENTLY COMPLETED/ONGOING PROJECTS. CONTRACTOR SHALL ONLY USE CONTROL POINTS LISTED HEREIN FOR LAYOUT ON THIS CONTRACT AND VERIFY ACCURACY OF CONTROL LOCATED WITHIN ADJACENT PROJECTS PRIOR TO LAYOUT.
- CONTROL FOR HILLVIEW WAY SHEETS 123-135 SHALL BE BASED ON STAKEOUT COORDINATES LISED ON SHEET 129

FILE NAME = ...ND978182-shr-ATB\_008\_Ties.dgn

USER NAME = Rob Heady  
 PLOT SCALE = 30.0000 "/ IN.  
 PLOT DATE = 10/7/2011

DESIGNED - MJO  
 DRAWN - RAH  
 CHECKED - BJD  
 DATE - 10/07/11

REVISED -  
 REVISED -  
 REVISED -  
 REVISED -

**STATE OF ILLINOIS  
 DEPARTMENT OF TRANSPORTATION**

**ALIGNMENT TIES  
 I-57**

SCALE: SHEET NO. OF SHEETS STA. TO STA.

F.A. RTE.	SECTION	COUNTY	TOTAL SHEETS	SHEET NO.
* 0X1-6-2HRK-2, HB-1,2; 0X-1R-1		WILLIAMSON	968	92
* F.A.I. 57 AND F.A.P. 331				CONTRACT NO. 78182
ILLINOIS FED. AID PROJECT				