

PLAN	SURVEYED	BY	DATE
	PLOTTED		
	NOTED		
	NO. OF WAY CHECKED		
	NO. OF ROAD CHECKED		
	NO. OF STRUCTURE NOTATIONS CHECKED		
	NO.		
	NO.		
	NO.		
	NO.		

PROFILE	SURVEYED	BY	DATE
	PLOTTED		
	NOTED		
	NO. OF WAY CHECKED		
	NO. OF ROAD CHECKED		
	NO. OF STRUCTURE NOTATIONS CHECKED		
	NO.		
	NO.		
	NO.		
	NO.		

PROP. RAMP I CURVE-1 DATA
 PI STA. = 21+27.17
 $\Delta = \Delta = 15^\circ 08' 25''$ (RT)
 $D = D = 4^\circ 46' 29''$
 $R = 1,200.00'$
 $T = 159.48'$
 $L = 317.10'$
 $E = 10.55'$
 $\theta = 7.02^\circ$
 $L.R. = N/A$
 $S.E. RUN = 225'$
 $P.C. STA. = 19+67.69$
 $P.T. STA. = 22+84.79$

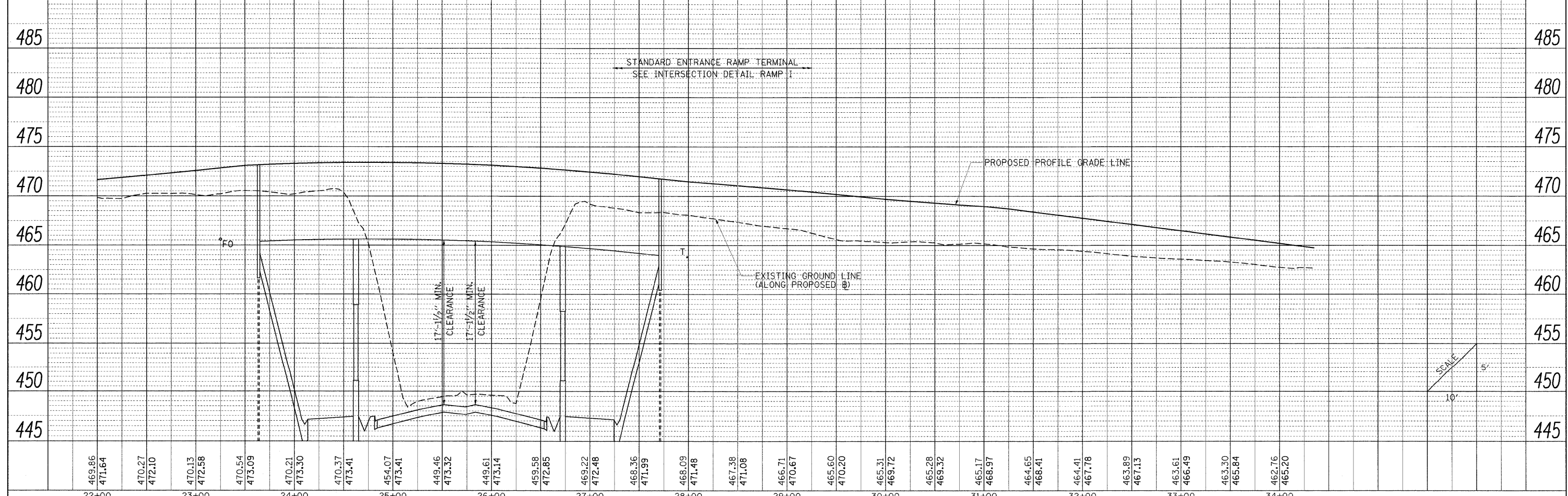
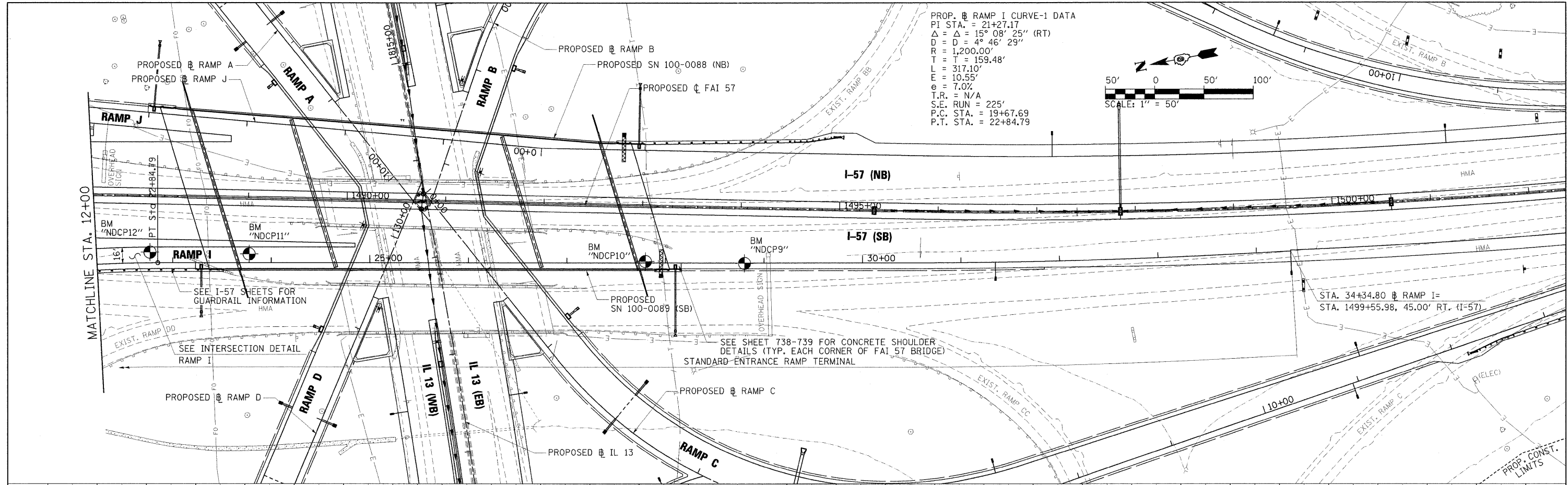
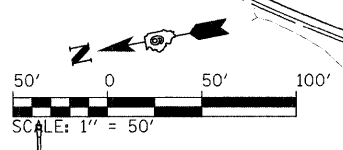

FILE NAME = ... \0978182-sht-plnpr-RAMP1-024.dgn	USER NAME = Brad Downen	DESIGNED - BJD	REVISED -	STATE OF ILLINOIS DEPARTMENT OF TRANSPORTATION	PLAN AND PROFILE RAMP I	F.A. RTE.	SECTION	COUNTY	TOTAL SHEETS	SHEET NO.
	PLOT SCALE = 50.0000' / IN.	DRAWN - RAH	REVISED -			* 0X1-6-2JHBK-2, HB-1,2, 0X-1R-1	WILLIAMSON	968	117	
	PLOT DATE = 10/12/2011	CHECKED - BJD	REVISED -			* F.A.I. 57 AND F.A.P. 331	CONTRACT NO. 78182			
		DATE - 10/07/11	REVISED -			ILLINOIS FED. AID PROJECT				