

TEMP. DIAMOND A CURVES

EXIST. CURVE DIAA1	PROP. CURVE DIAA2
PI STA. = 13+40.41	PI STA. = 14+67.65
$\Delta = 22^\circ 03' 26''$ (LT)	$\Delta = 17^\circ 31' 28''$ (LT)
$D = 19^\circ 05' 55''$	$D = 12^\circ 34' 37''$
R = 300.00'	R = 455.56'
T = 58.47'	T = 70.22'
L = 115.49'	L = 139.34'
E = 5.64'	E = 5.38'
e = N/C	e = N/C
T.R. = N/A	T.R. = N/A
S.E. RUN = N/A	S.E. RUN = N/A
P.C. STA = 12+81.94	P.C.C. STA = 13+97.43
P.C.C. STA = 13+97.43	P.R.C. STA = 15+36.77

TEMP. DIAMOND A COORDINATE DATA

P.O.T. STA.	P.C.C. STA.
10+79.78	13+97.43
N: 391613.979	N: 391928.621
E: 804335.637	E: 804311.287
P.C. STA.	P.R.C. STA.
12+81.94	15+36.77
N: 391816.131	N: 392047.274
E: 804334.100	E: 804239.273

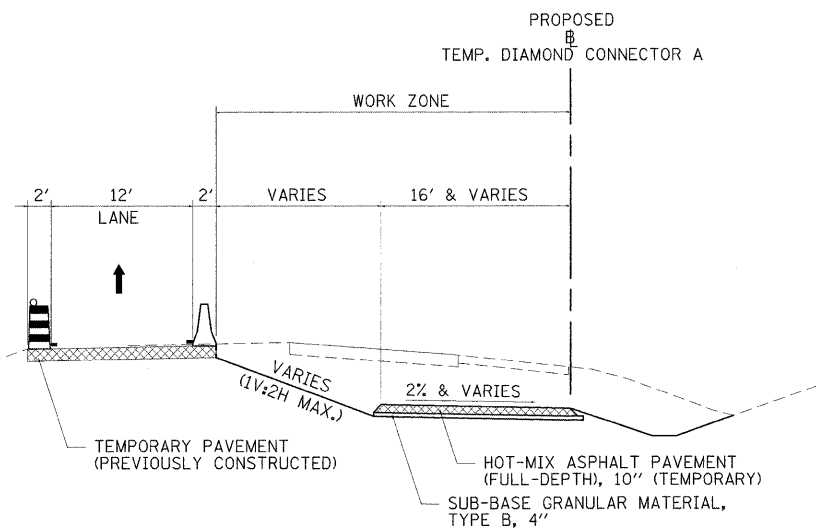

RAMP A - PRE-STAGE B TYPICAL #1
 TEMP. DIAMOND CONNECTOR A: STA. 13+75.00 TO STA. 19+65.71

NOTES:
 1. CONTRACTOR TO VERIFY HORIZONTAL AND VERTICAL LOCATION OF TEMPORARY DIAMOND STUBS TO DETERMINE IF FIELD ADJUSTMENTS TO CURVES OR ELEVATIONS ARE REQUIRED. CONTRACTOR SHALL RECEIVE APPROVAL FROM RESIDENT ENGINEER PRIOR TO CONSTRUCTING TEMPORARY DIAMOND CONNECTORS.

LEGEND

- WORK ZONE
- COMPLETED PAVEMENT
- TEMPORARY PAVEMENT - FULL DEPTH (CONSTRUCTED THIS STAGE)
- TEMPORARY PAVEMENT - FULL DEPTH (CONSTRUCTED PREVIOUS STAGE)
- TEMPORARY RAMP
- MILL/OVERLAY
- TEMPORARY CONCRETE BARRIER WALL
- IMPACT ATTENUATORS, TEMPORARY (FULLY REDIRECTIVE, NARROW)
- IMPACT ATTENUATORS, TEMPORARY (NON-REDIRECTIVE)
- DRUM WITH STEADY BURNING LIGHT
- TYPE II BARRICADE WITH STEADY BURNING LIGHT
- TYPE III BARRICADE WITH FLASHING LIGHTS
- DIRECTION OF TRAFFIC FLOW