

LEGEND:
 XXX.XX PROPOSED ELEVATION (TOP OF TEMPORARY PAVEMENT)
 XXX.XX EXISTING ELEVATION (PAVEMENT OR GROUND)

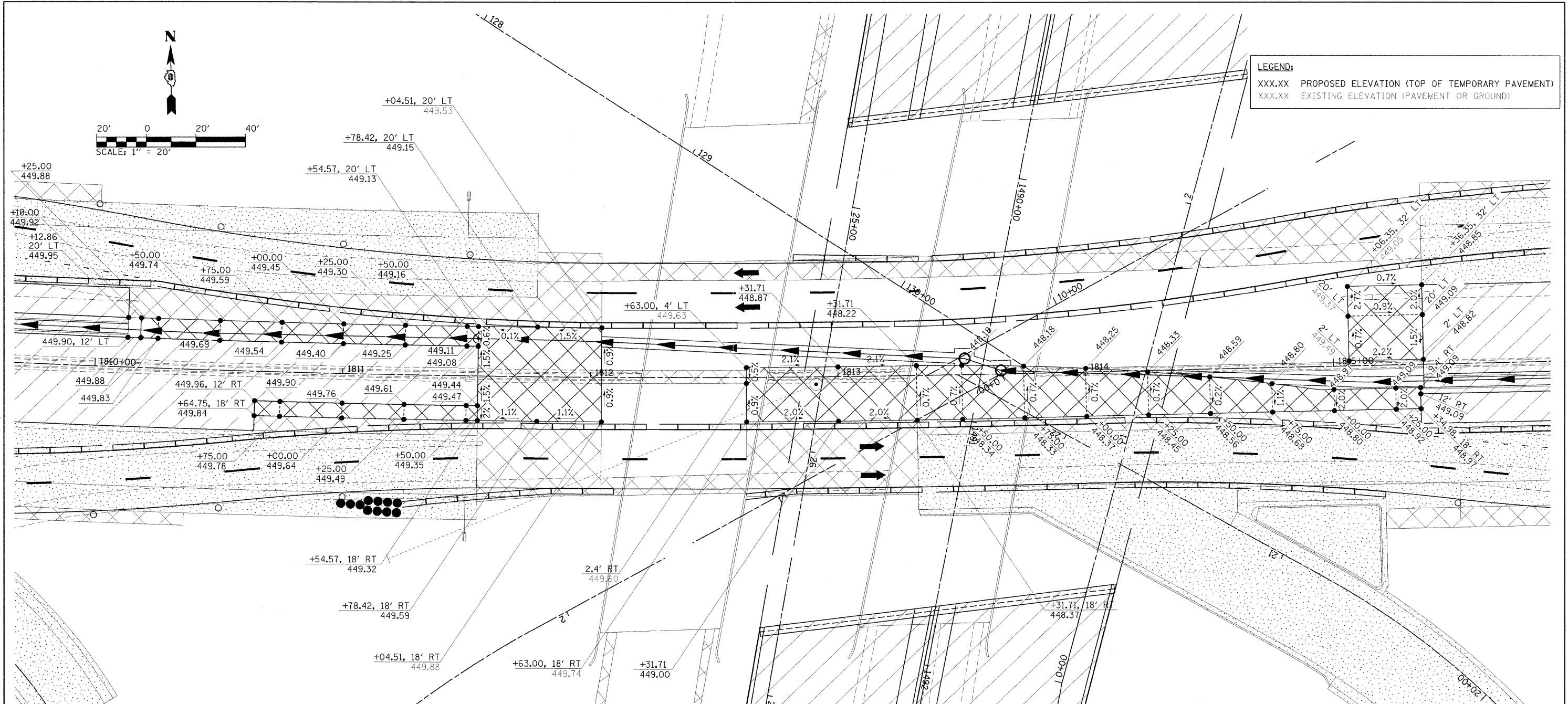

LEGEND

- WORK ZONE
- COMPLETED PAVEMENT
- TEMPORARY PAVEMENT - FULL DEPTH (CONSTRUCTED THIS STAGE)
- TEMPORARY PAVEMENT - FULL DEPTH (CONSTRUCTED PREVIOUS STAGE)
- TEMPORARY RAMP
- MILL/OVERLAY
- TEMPORARY CONCRETE BARRIER WALL
- IMPACT ATTENUATORS, TEMPORARY (FULLY REDIRECTIVE, NARROW)
- IMPACT ATTENUATORS, TEMPORARY (NON-REDIRECTIVE)
- DRUM WITH STEADY BURNING LIGHT
- TYPE II BARRICADE WITH STEADY BURNING LIGHT
- TYPE III BARRICADE WITH FLASHING LIGHTS
- DIRECTION OF TRAFFIC FLOW

- TEMPORARY PAVEMENT - SUGGESTED SEQUENCE OF CONSTRUCTION:**
1. CONSTRUCT ALL PERMANENT ITEMS OF WORK THAT ARE SCHEDULED FOR CONSTRUCTION IN STAGE 1B.
 2. CONSTRUCT THE FULL-DEPTH TEMPORARY PAVEMENT FROM STA. 1812+63.00 TO STA. 1815+34.98.
 3. PLACE TEMPORARY CONCRETE BARRIER WALL ALONG INSIDE EDGE OF RECENTLY CONSTRUCTED TEMPORARY PAVEMENT.
 4. COMPLETE PATCHING OF EXISTING PAVEMENT IN AREAS WHERE PERMANENT AND TEMPORARY DRAINAGE IS INSTALLED.
 5. CONSTRUCT THE REMAINDER OF THE TEMPORARY PAVEMENT SCHEDULED FOR CONSTRUCTION IN STAGE 1B.

FILE NAME =	USER NAME = Brad Downen	DESIGNED - JMS	REVISED -
...\\D9\8182-sht-staging\IB-IL13.TemporaryPavementDetails.dgn	Plot Scale = 20.0000' / IN.	DRAWN - JMS	REVISED -
	PLOT DATE = 10/12/2011	CHECKED - BJD	REVISED -
		DATE - 10/07/11	REVISED -

**STATE OF ILLINOIS
DEPARTMENT OF TRANSPORTATION**

**MAINTENANCE OF TRAFFIC PLAN - IL 13
STAGE 1B - TEMPORARY PAVEMENT DETAILS**

SCALE: 1" = 20' SHEET NO. OF SHEETS STA. TO STA.

F.A. RTE.	SECTION	COUNTY	TOTAL SHEETS	SHEET NO.
•	01-6-2HKB-2, HB-1,2; 01-1R-1	WILLIAMSON	968	225
•	F.A.I. 57 AND F.A.P. 331			CONTRACT NO. 78182
ILLINOIS FED. AID PROJECT				