

DATE	
BY	
SURVEYED	
PLOTTED	
DATE	
AREAS	
CHECKED	
NO.	

DATE	
BY	
SURVEYED	
PLOTTED	
DATE	
AREAS	
CHECKED	
NO.	

STA. 62+49, LT.
I-57
N=377468.9
E=801721.3

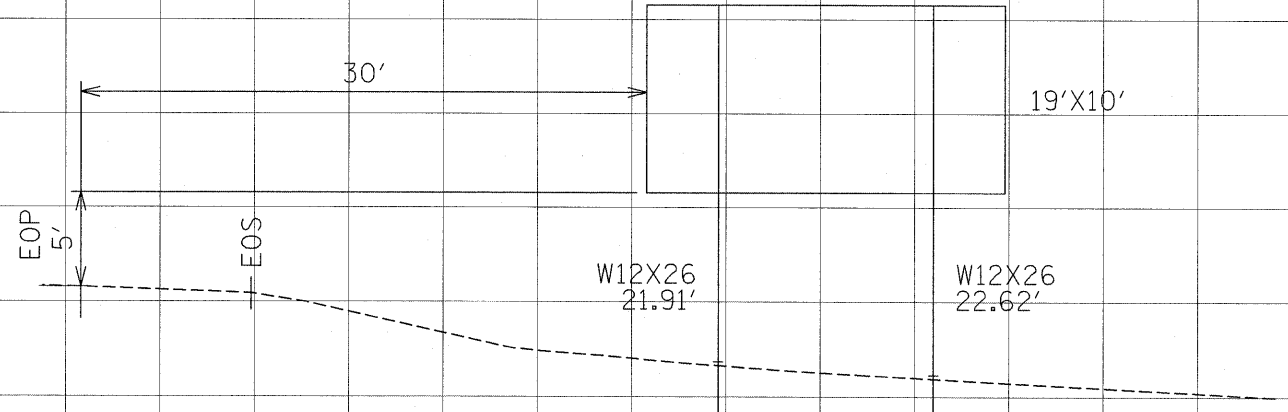

STA. 128+85, LT.
I-57
N=370892.9
E=801272.7

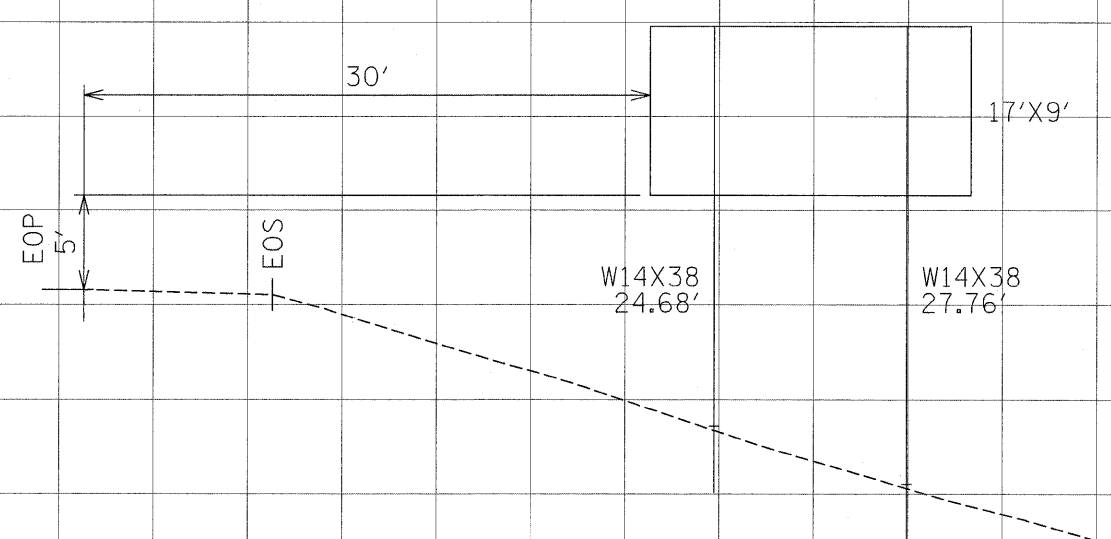

STA. 141+97, LT.
I-57
N=369575.6
E=801207.5

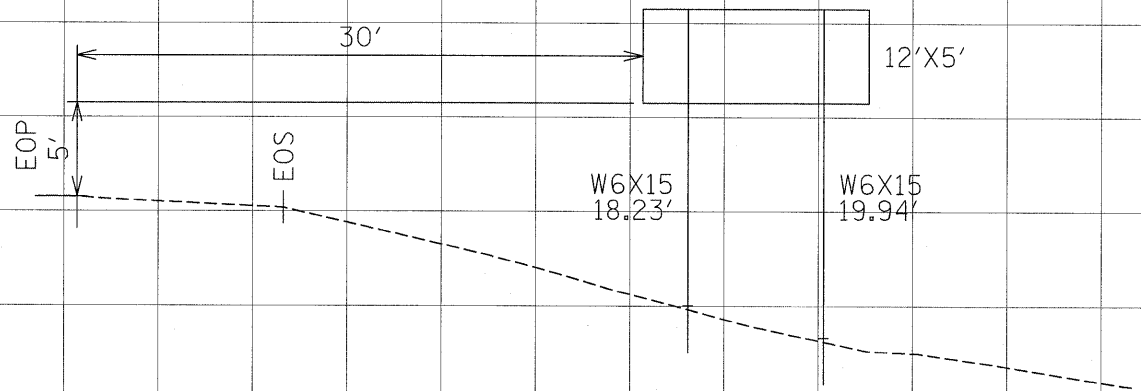

STA. 149+92, LT.
I-57
N=368779.6
E=801118.6

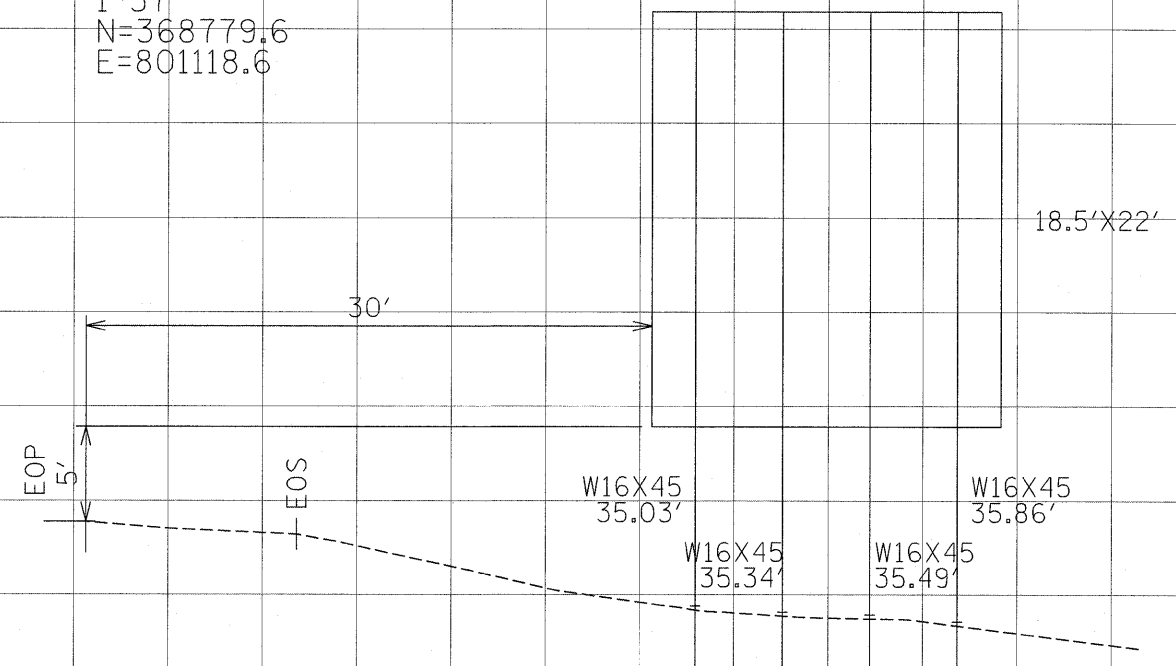

EFK Moen, LLC
Civil Engineering Design

FILE NAME =	USER NAME = Brad Downen	DESIGNED - JD	REVISED -	STATE OF ILLINOIS DEPARTMENT OF TRANSPORTATION	GROUND MOUNT SIGN CROSS SECTIONS	F.A. RTE.	SECTION	COUNTY	TOTAL SHEETS	SHEET NO.
...D978182-sht-sig-108-122-Ground Mount Xsec.dgn	PLLOT SCALE = 5.0000' / IN.	DRAWN - MK	REVISED -			* (X1-6-2)HBK-2,HB-1,2;(X1-1)R-1	WILLIAMSON	968	530	
PLLOT DATE = 10/10/2011	DATE = 10/07/11	CHECKED - SD	REVISED -			* F.A.I. 57 AND F.A.P. 331	CONTRACT NO. 78182			
			REVISED -			ILLINOIS FED. AID PROJECT				
SCALE: 1" = 1'						SHEET NO. 10 OF 15 SHEETS		STA. TO STA.		