

Notes:
 Space reinforcement in cap to miss anchor bolts.
 Pour steps monolithically with cap.
 For details of piles and Concrete Encasement, see sheet 66 of 75.
 For Bar Details, Bill of Material, Footing Plan, Sections A-A, B-B, C-C and D-D, see sheet 54 of 75.
 For Aesthetic Treatment Details, see sheets 61 thru 63 of 75.
 All surfaces of pier above proposed ground line shall be treated with concrete sealer.



PILE DATA

Type: Steel HP 14x89
 Nominal Required Bearing: 659k
 Factored Resistance Available: 363k
 Est. Length: 28'
 No. Production Piles: 42
 No. Test Piles: 0
 Estimated Top of Rock Elevation: 423.10

MIN. BAR LAP

#5 Bar = 3'-8"
 #6 Bar = 4'-5"
 #8 Bar = 7'-8"
 #9 Bar = 9'-8"

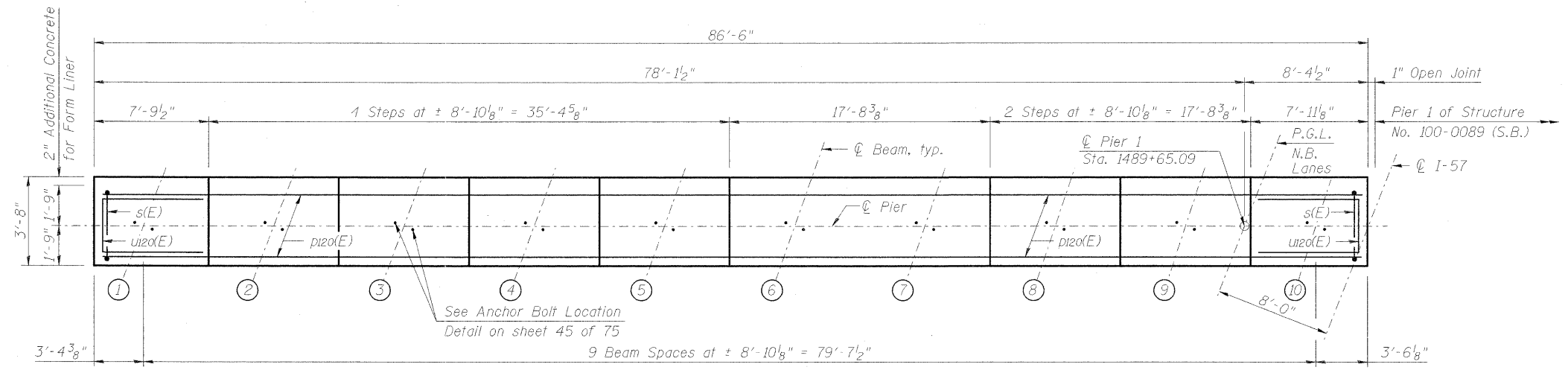

TOP PLAN

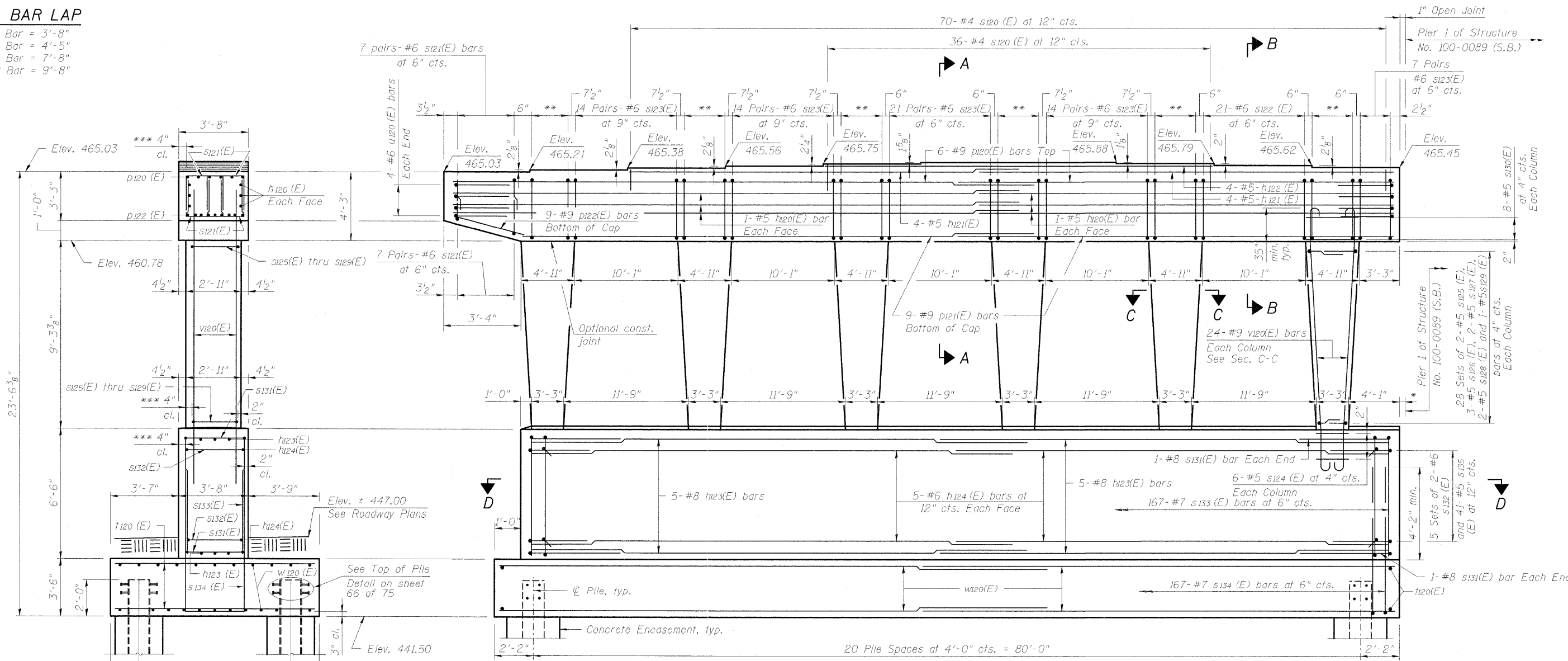

ELEVATION
(Looking South)

END VIEW

*** 2" Additional Concrete for Form Liner.

* 1" P.J.F. between structures, Cost included in Concrete Structures.
 ** 5-#6 s122 (E) at 12" cts.



FILE NAME = ...\\1-57\044\PIER 1.NB.dgn
 USER NAME = Rob Heady
 PLOT SCALE =
 PLOT DATE = 10/7/2011

DESIGNED - JDJ	REVISIONS -
CHECKED - REB	REVISIONS -
DRAWN - GLD	REVISIONS -
CHECKED - REB	REVISIONS -

STATE OF ILLINOIS
DEPARTMENT OF TRANSPORTATION

PIER 1
STRUCTURE NO. 100-0088 (N.B.)
 SHEET NO. 53 OF 75 SHEETS

F.A.I. RTE.	SECTION	COUNTY	TOTAL SHEETS	SHEET NO.
57	(X1-6-2)HBK-2	WILLIAMSON	968	638
CONTRACT NO. 78182			ILLINOIS FED. AID PROJECT	