

Notes:
 Space reinforcement in cap to miss anchor bolts.
 Pour steps monolithically with cap.
 For details of piles and Concrete Encasement,
 see sheet 66 of 75.
 For Bar Details, Bill of Material, Footing Plan,
 Sections A-A, B-B, C-C and D-D, see sheet 56 of 75.
 For Aesthetic Treatment Details, see sheets 61 thru 63 of 75.
 All surfaces of pier above proposed ground line shall be
 treated with concrete sealer.

PILE DATA

Type: Steel HP 14x89
 Nominal Required Bearing: 700k
 Factored Resistance Available: 385k
 Est. Length: 30'
 No. Production Piles: 36
 No. Test Piles: 0
 Estimated Top of Rock Elevation: 415.10

MIN. BAR LAP

- #5 Bar = 3'-8"
- #6 Bar = 4'-5"
- #8 Bar = 7'-8"
- #9 Bar = 9'-8"

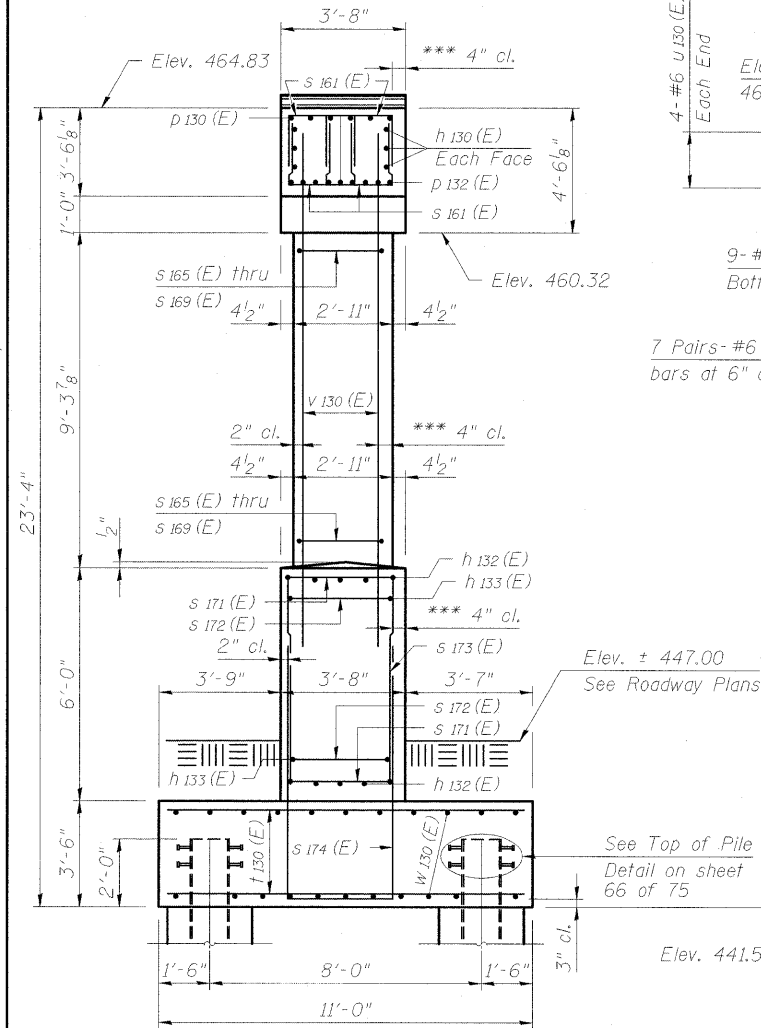

END VIEW

- * 1" P.J.F. between structures. Cost included in Concrete Structures.
- ** 5-#6 s 162(E) at 12" cts.
- *** 2" Additional Concrete For Form Liner.

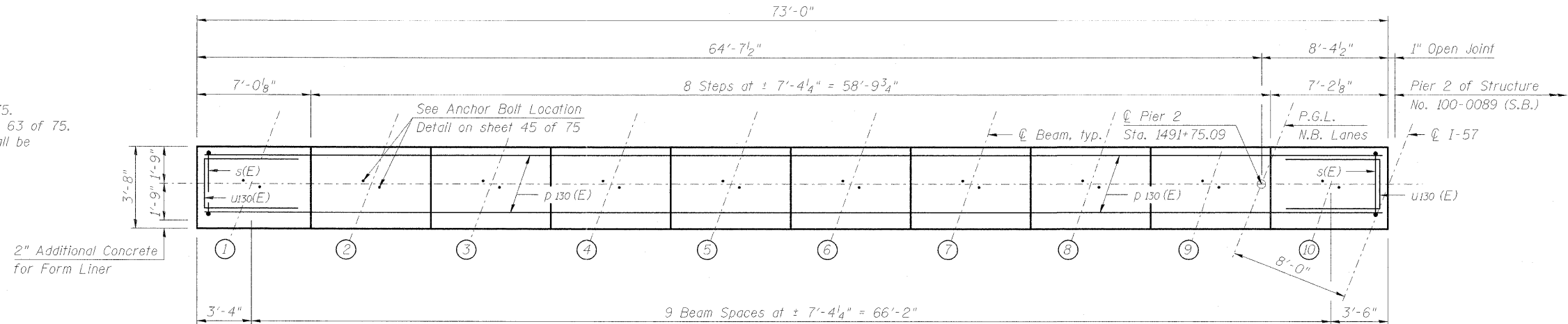

TOP PLAN

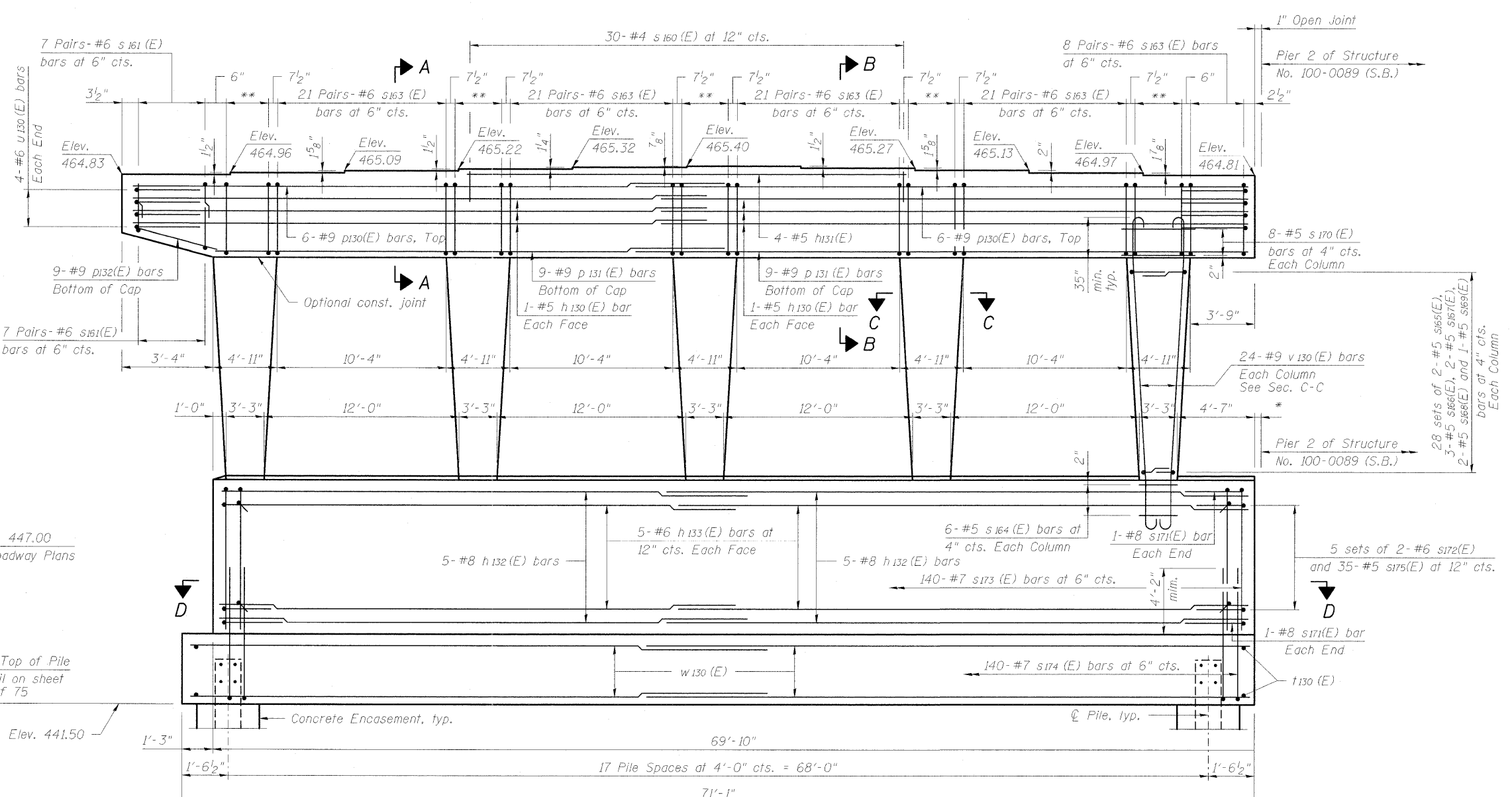

ELEVATION
(Looking South)

CMT
 CRAWFORD MURPHY & TILLY, INC.
 CONSULTING ENGINEERS
 SPRINGFIELD, IL ■ AURORA, IL ■ ST. LOUIS, MO
 ROCKFORD, IL ■ PEORIA, IL ■ CHICAGO, IL

FILE NAME = ...1-57\B45.PIER 2.NB.dgn	USER NAME = Rob Heady	DESIGNED - JDJ	REVISIONS -
PLOT SCALE =		CHECKED - REB	REVISIONS -
PLOT DATE = 10/7/2011		DRAWN - GLD	REVISIONS -
		CHECKED - REB	REVISIONS -

**STATE OF ILLINOIS
 DEPARTMENT OF TRANSPORTATION**

**PIER 2
 STRUCTURE NO. 100-0088 (N.B.)**

SHEET NO. 55 OF 75 SHEETS

F.A.I. RTE. 57	SECTION (X1-6-2)HBK-2	COUNTY WILLIAMSON	TOTAL SHEETS 968	SHEET NO. 640
ILLINOIS FED. AID PROJECT			CONTRACT NO. 78182	