

z:\10035-1-57 and 113 mstrchange\dgn\113 mstrchange\dgn\1000098-78182-007-Super.dgn
 2/18/31 PM 9/7/2011

EFK Moen, LLC
 Civil Engineering Design
 331 Salem Place, Suite 225
 Fairview Heights, IL 62208
 Phone 618-206-4250

FILE NAME = 1000098-78182-007-Super.dgn
 USER NAME = Jm
 DESIGNED - CTW
 CHECKED - CDL
 DRAWN - DP
 DATE - 9/7/2011

MIN BAR LAP
 #5 bars = 2'-7"

* Order a(E) & a₁(E) bars full length. Cut to fit skew and use remainder of bars in opposite end. (East end requires fewer bars due to geometry.)

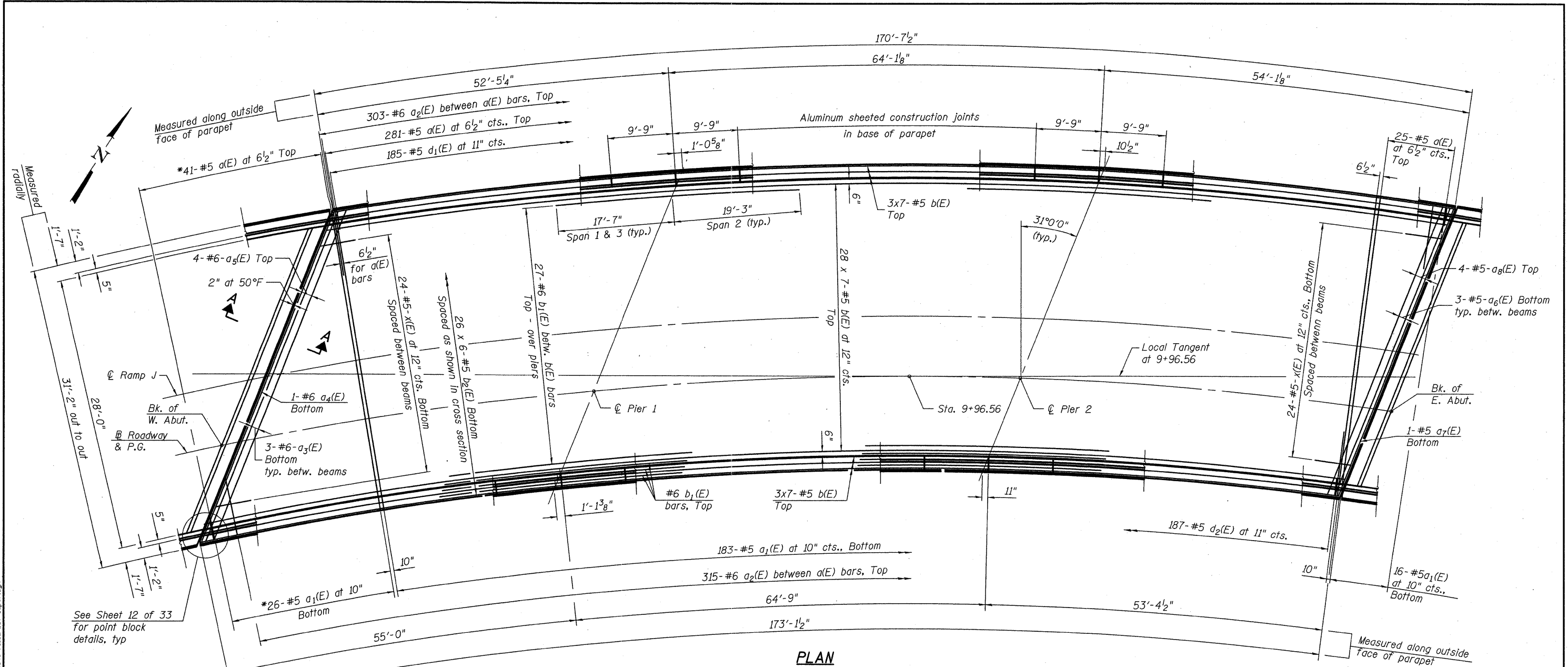

PLAN

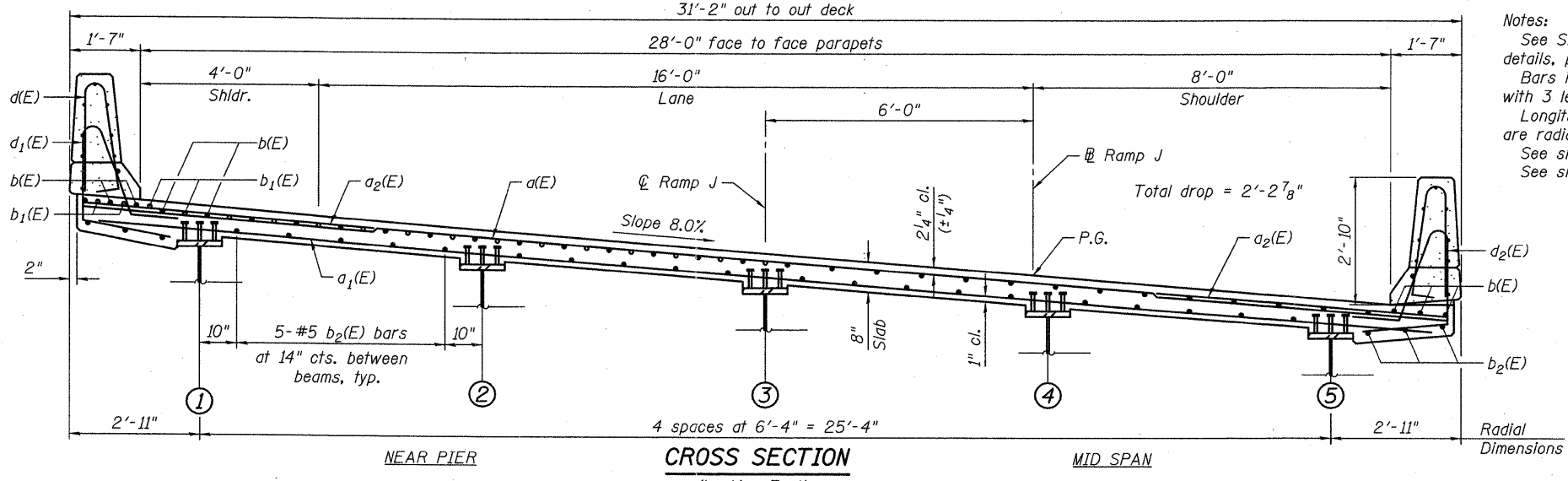

CROSS SECTION
(Looking East)

Notes:
 See Sheet 9 of 33 for Section A-A, Superstructure details, parapet reinforcement and Bill of Material.
 Bars indicated thus 1 x 3-#8 etc, indicates 1 lines of bars with 3 lengths per line.
 Longitudinal bars are parallel to the curve, transverse bars are radial.
 See sheet 1 of 33 for drain scupper locations.
 See sheets 8 and 9 of 33 for parapet details.

STATE OF ILLINOIS
DEPARTMENT OF TRANSPORTATION

SUPERSTRUCTURE
STRUCTURE NO. 100-0098

SHEET NO. 7 OF 33 SHEETS

F.A.I. RTE.	SECTION	COUNTY	TOTAL SHEETS	SHEET NO.
57	(X1-6-2)HB-2	WILLIAMSON	968	690
CONTRACT NO. 78182				

ILLINOIS FED. AID PROJECT