

|              |  |
|--------------|--|
| DATE         |  |
| BY           |  |
| FINAL SURVEY |  |
| SURVEYED     |  |
| PLOTTED      |  |
| DATE         |  |
| NOTE BOOK    |  |
| AREAS        |  |
| CHECKED      |  |
| NO.          |  |

|                 |  |
|-----------------|--|
| DATE            |  |
| BY              |  |
| ORIGINAL SURVEY |  |
| SURVEYED        |  |
| PLOTTED         |  |
| DATE            |  |
| NOTE BOOK       |  |
| AREAS           |  |
| CHECKED         |  |
| NO.             |  |

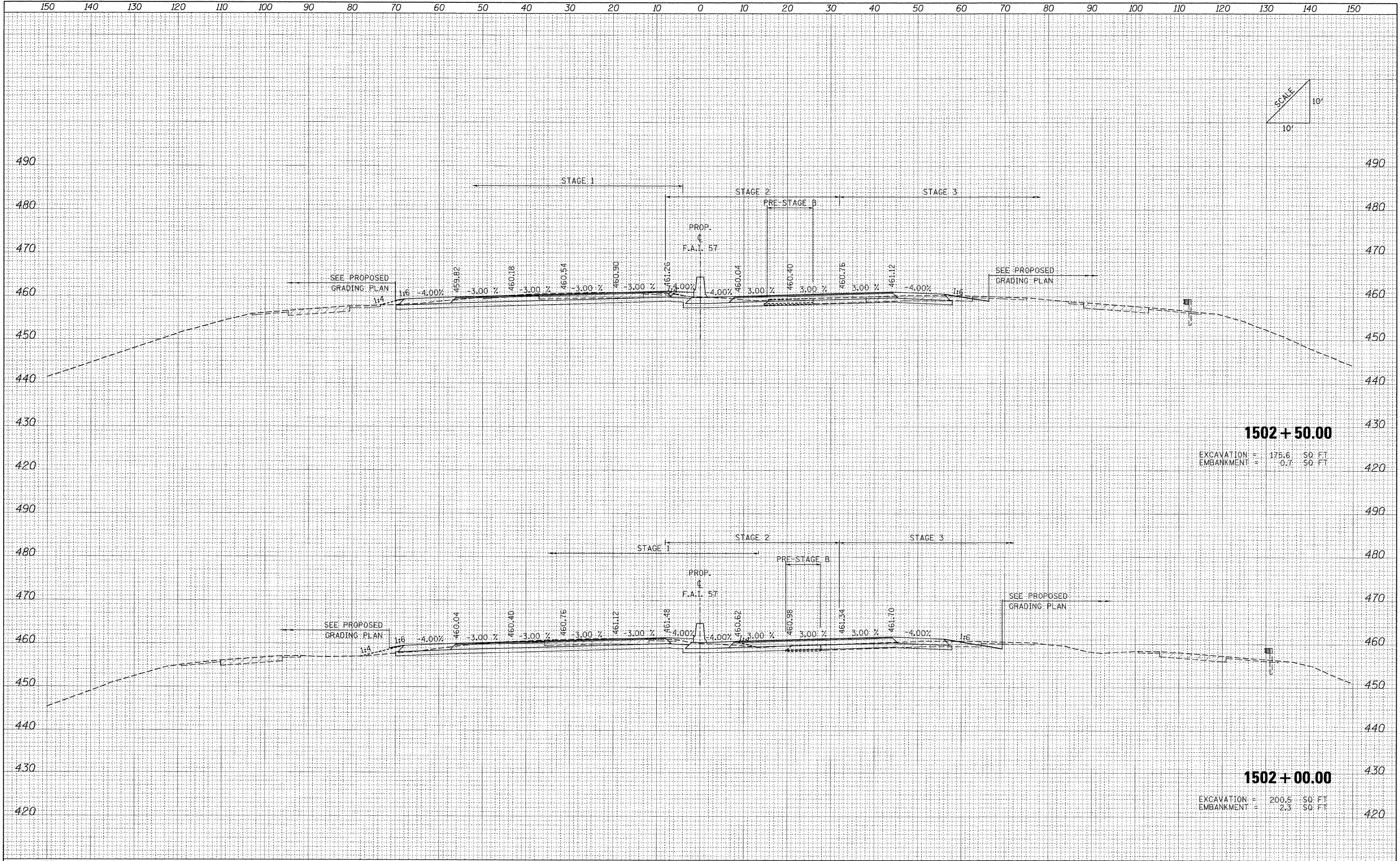

**1502 + 50.00**  
 EXCAVATION = 175.6 SQ. FT.  
 EMBANKMENT = 0.7 SQ. FT.

**1502 + 00.00**  
 EXCAVATION = 200.5 SQ. FT.  
 EMBANKMENT = 2.3 SQ. FT.

FILE NAME = ...\\d978182-sht-XCS.157.dgn

USER NAME = Rob Headly  
 DESIGNED - MJO  
 DRAWN - MJO  
 CHECKED - BJD  
 DATE - 10/07/11

REVISED -  
 REVISED -  
 REVISED -  
 REVISED -

**STATE OF ILLINOIS  
 DEPARTMENT OF TRANSPORTATION**

**CROSS SECTIONS: F.A.I. 57**

SCALE: SHEET NO. OF SHEETS STA. 1502+00.00 TO STA. 1502+50.00

| F.A. RTE.                  | SECTION                         | COUNTY                    | TOTAL SHEETS | SHEET NO. |
|----------------------------|---------------------------------|---------------------------|--------------|-----------|
| *                          | (X1-6-2)HBK-2, HB-1,2; (1X-1R-1 | WILLIAMSON                | 968          | 805       |
| * F.A.I. 57 AND F.A.P. 331 |                                 | CONTRACT NO. 78182        |              |           |
| FED. ROAD DIST. NO.        |                                 | ILLINOIS FED. AID PROJECT |              |           |