

DATE	
BY	
FINAL SURVEY	
NOTED	
NO.	
AREAS CHECKED	

DATE	
BY	
ORIGINAL SURVEY	
NOTED	
NO.	
AREAS CHECKED	

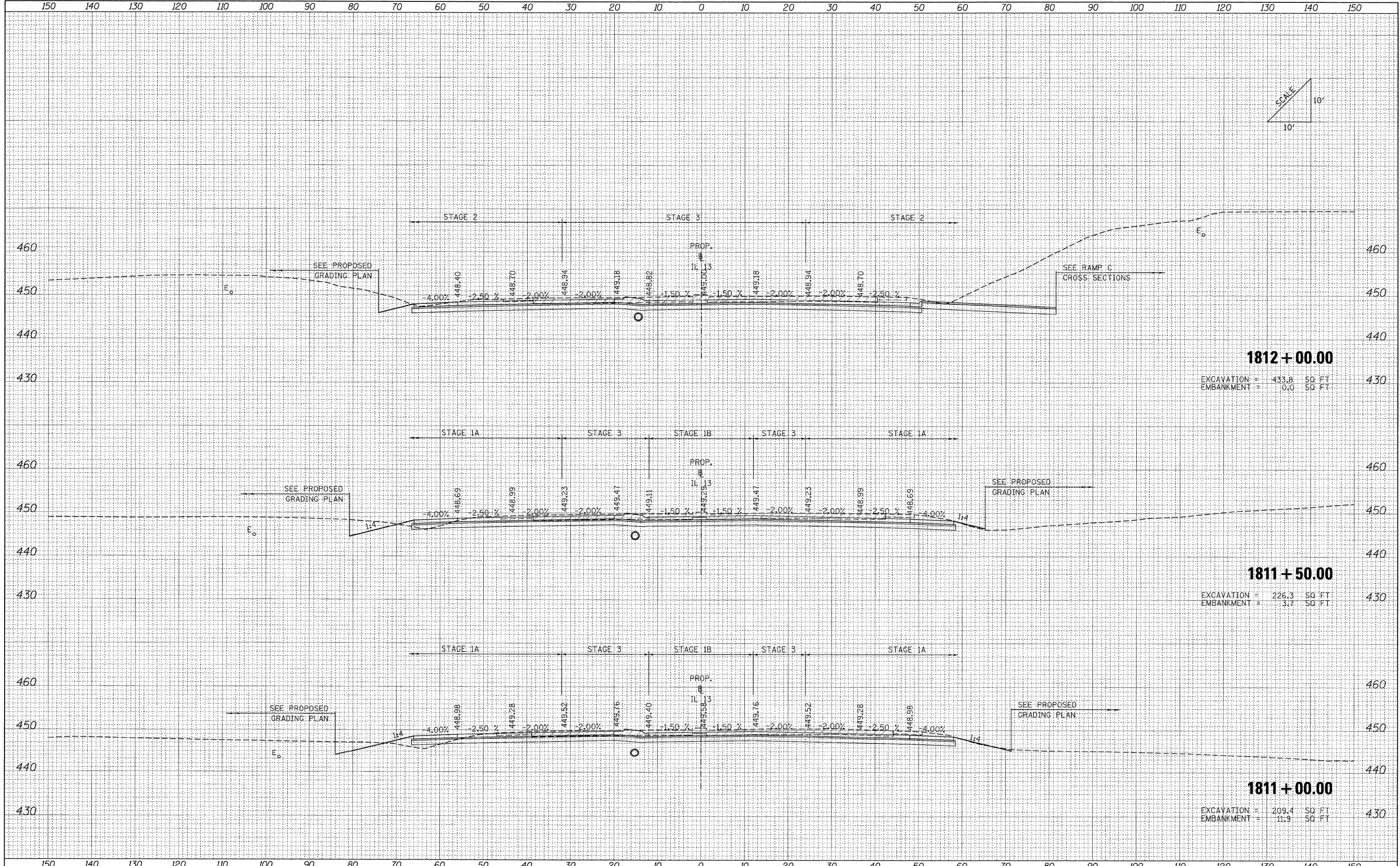
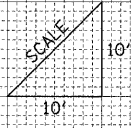

1812+00.00
 EXCAVATION = 433.8 SQ. FT.
 EMBANKMENT = 10.0 SQ. FT.

1811+50.00
 EXCAVATION = 226.3 SQ. FT.
 EMBANKMENT = 3.7 SQ. FT.

1811+00.00
 EXCAVATION = 209.4 SQ. FT.
 EMBANKMENT = 11.9 SQ. FT.

FILE NAME =	USER NAME = Rob Heady	DESIGNED - MJO	REVISED -	STATE OF ILLINOIS DEPARTMENT OF TRANSPORTATION	CROSS SECTIONS: F.A.P 331 (IL 13)			F.A. RTE.	SECTION	COUNTY	TOTAL SHEETS	SHEET NO.
...0978182-sh1-XCS_IL13.dgn		DRAWN - MJO	REVISED -					•	0X1-6-2HBK-2, HB-1,2; (1X-1R-1	WILLIAMSON	968	853
		CHECKED - BJD	REVISED -					•	F.A.I. 57 AND F.A.P. 331			CONTRACT NO. 78182
		DATE - 10/07/11	REVISED -							ILLINOIS FED. AID PROJECT		
				SCALE:	SHEET NO.	OF	SHEETS	STA. 1811+00.00 TO STA. 1812+00.00				