

DATE	
BY	
FINAL SURVEY	
NOTED	
NO.	

DATE	
BY	
ORIGINAL SURVEY	
NOTED	
NO.	

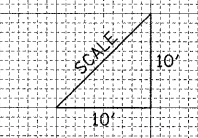
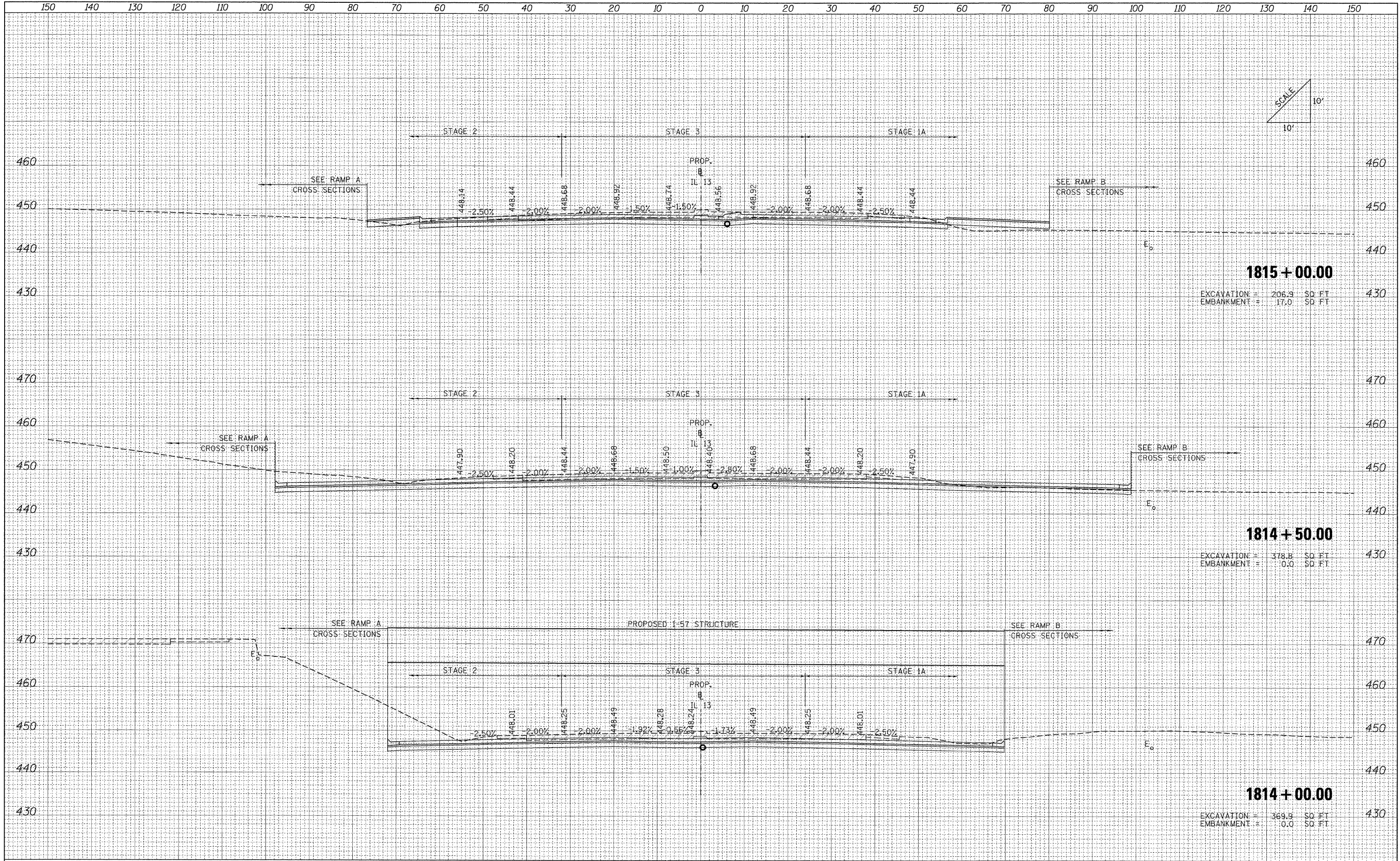

1815 + 00.00

EXCAVATION = 206.9 SQ. FT.
EMBANKMENT = 17.0 SQ. FT.

1814 + 50.00

EXCAVATION = 378.8 SQ. FT.
EMBANKMENT = 10.0 SQ. FT.

1814 + 00.00

EXCAVATION = 369.9 SQ. FT.
EMBANKMENT = 10.0 SQ. FT.

FILE NAME = ...ND978182-sht-XCS-IL13.dgn	USER NAME = Rob Heady	DESIGNED - MJO	REVISED -	STATE OF ILLINOIS DEPARTMENT OF TRANSPORTATION	CROSS SECTIONS: F.A.P 331 (IL 13)				F.A. RTE.	SECTION	COUNTY	TOTAL SHEETS	SHEET NO.
	PLOT SCALE = 10.0000' / IN.	DRAWN - MJO	REVISED -		SCALE:	SHEET NO.	OF	SHEETS	STA. 1814+00.00 TO STA. 1815+00.00	• (X1-6-2)HBK-2, HB-1,2; (IX-1R-1	WILLIAMSON	968	855
	PLOT DATE = 10/10/2011	CHECKED - BJD	REVISED -							• F.A.I. 57 AND F.A.P. 331			
		DATE - 10/07/11	REVISED -							FED. ROAD DIST. NO.	ILLINOIS FED. AID PROJECT		