

FINAL SURVEY	DATE
SURVEYED	BY
PLOTTED	
NOTE BOOK	
AREAS CHECKED	
NO.	

ORIGINAL SURVEY	DATE
SURVEYED	BY
PLOTTED	
NOTE BOOK	
AREAS CHECKED	
NO.	

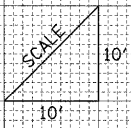
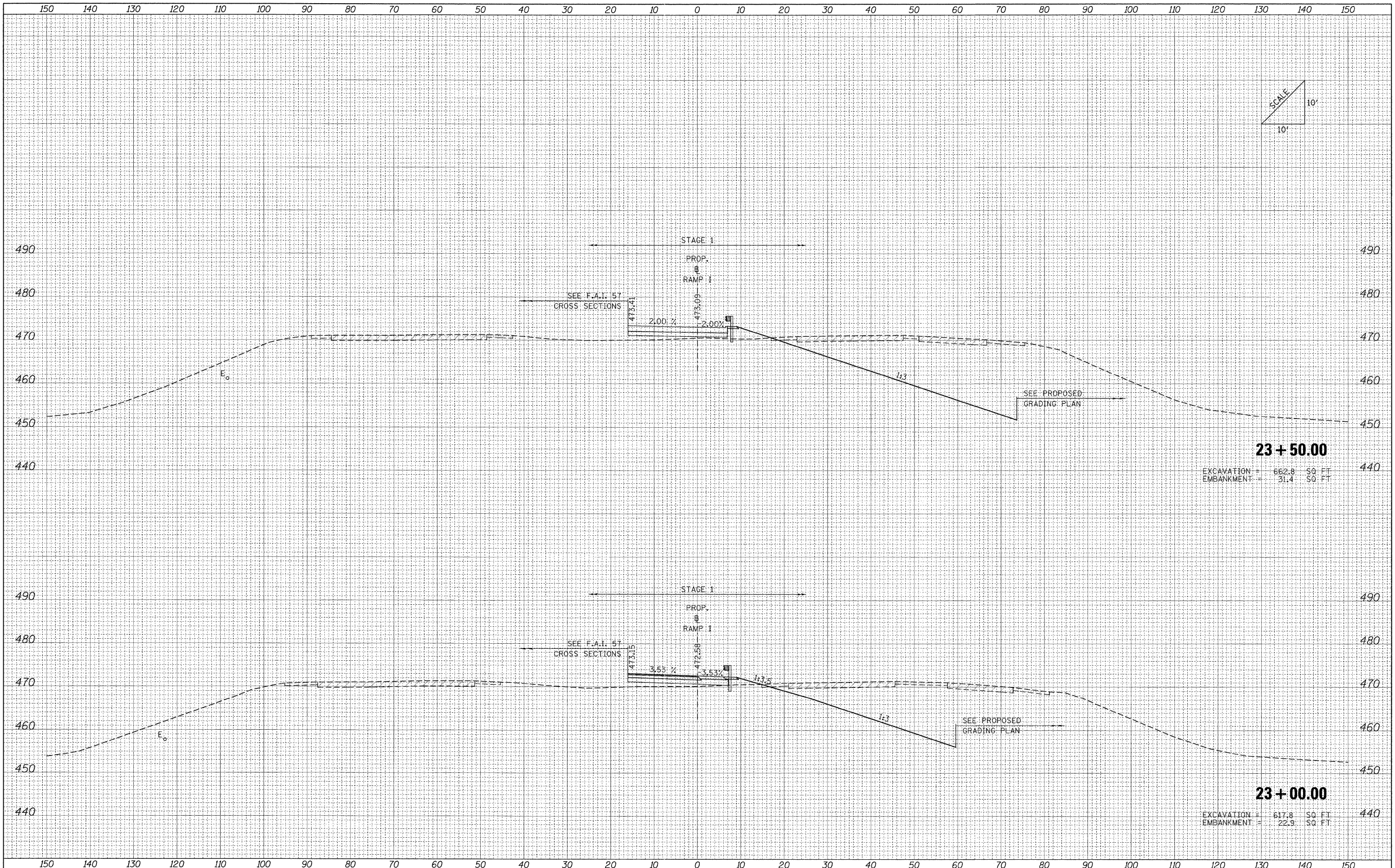

FILE NAME = ...\\D978182-shc-XCS-RAMP1.dgn

USER NAME = Rob Heady	DESIGNED - MJO	REVISED -
	DRAWN - MJO	REVISED -
PLOT SCALE = 10.0000' / 1"	CHECKED - BJD	REVISED -
PLOT DATE = 10/10/2011	DATE - 10/07/11	REVISED -

**STATE OF ILLINOIS  
DEPARTMENT OF TRANSPORTATION**

**CROSS SECTIONS: RAMP I**

SCALE: SHEET NO. OF SHEETS STA. 23+00.00 TO STA. 23+50.00

F.A. RTE.	SECTION	COUNTY	TOTAL SHEETS	SHEET NO.
*	(X1-6-2)HBK-2, HB-1,2 (1X-1R-1)	WILLIAMSON	968	951
*	F.A.I. 57 AND F.A.P. 331			CONTRACT NO. 78182
FED. ROAD DIST. NO. ILLINOIS FED. AID PROJECT				