

GENERAL NOTES

THE THICKNESS OF HMA MIXTURES SHOWN ON THE PLANS IS THE NOMINAL THICKNESS. DEVIATIONS FROM THE NOMINAL THICKNESS WILL BE PERMITTED WHEN SUCH DEVIATIONS OCCUR DUE TO IRREGULARITIES IN THE EXISTING SURFACE OR BASE ON WHICH THE HMA MIXTURE IS PLACED.

THE HMA SURFACE OF ALL MAILBOX TURNOUTS, PRIVATE ENTRANCES, COMMERCIAL ENTRANCES, AND SIDE ROADS SHALL BE MADE NEATLY, IN A WORKMANLIKE MANNER, AND SHALL ACCURATELY CONFORM TO THE SHAPES AND DIMENSIONS SHOWN ON THE PLAN DETAILS. IF REQUIRED BY THE ENGINEER, THE CONTRACTOR SHALL BE REQUIRED TO SAW CUT THE HMA SURFACE TO CONFORM TO THE SHAPES AND DIMENSIONS SHOWN ON THE PLAN DETAILS. THIS WORK SHALL BE INCLUDED IN THE COST OF THE HMA SURFACE.

EXCEPT AS NOTED ON THE PLANS, PAVEMENT GRADES SHOWN ARE AT THE TOP OF PAVEMENT SURFACES.

BEFORE ORDERING PIPE CULVERTS OR PIPE DRAINS, THE CONTRACTOR SHALL CONSULT THE ENGINEER FOR EXACT LENGTHS.

AGGREGATE (PRIME COAT): FA 20 MAY BE USED IN ADDITION TO THE GRADATIONS LISTED IN THE 3RD PARAGRAPH OF ARTICLE 1003.03(c) OF THE STANDARD SPECIFICATIONS.

THE ENGINEER WILL BE THE SOLE JUDGE CONCERNING CURING TIME FOR THE VARIOUS HMA LIFTS.

FOR STABILIZATION, ALL TYPE III BARRICADES SHALL REQUIRE A MINIMUM OF FOUR SAND BAGS PER BARRICADE.

SEEDING SHALL NOT BE PERMITTED AT ANY TIME WHEN THE GROUND IS FROZEN, WET, OR IN AN UNTILLABLE CONDITION. LOCATIONS TO BE SEEDED WILL BE DETERMINED BY THE ENGINEER.

ONLY THOSE TREES DESIGNATED BY THE ENGINEER OR LISTED IN THE TREE REMOVAL SCHEDULE SHALL BE REMOVED. THE CONTRACTOR SHALL PROTECT ALL REMAINING TREES FROM DAMAGE DUE TO HIS OPERATIONS.

THE FINISHED EARTHWORK SHALL HAVE A VEGETATION SUSTAINING SOIL COVERING THE TOP FOUR INCHES IN AREAS TO BE SEEDED OR SODDED. THE VEGETATION SUSTAINING SOIL REQUIRED WILL NOT BE PAID FOR SEPARATELY BUT SHALL BE INCLUDED IN THE COST OF EARTH EXCAVATION.

PLACE CURB RAMP FOR SIDEWALKS (STANDARD 424001) AT ALL LOCATIONS WHERE PROPOSED SIDEWALK ABUTS CURB AT STREET ENTRANCES.

ALL ELEVATIONS REFERRING TO U. S. G. S. MEAN SEA LEVEL DATUM.

ABANDONED UNDERGROUND UTILITIES THAT CONFLICT WITH CONSTRUCTION SHALL BE DISPOSED OF OUTSIDE THE LIMITS OF THE RIGHT OF WAY ACCORDING TO ARTICLE 202.03 OF THE STANDARD SPECIFICATIONS AND AS DIRECTED BY THE ENGINEER. THIS WORK WILL NOT BE PAID FOR SEPARATELY BUT SHALL BE INCLUDED IN THE COST OF EARTH EXCAVATION.

ANY REFERENCE TO A STANDARD IN THESE PLANS SHALL BE INTERPRETED TO MEAN THE EDITION AS INDICATED BY THE SUBNUMBER SHOWN IN THE LIST OF STANDARDS INCLUDED IN THESE PLANS.

THE FOLLOWING RATES OF APPLICATION HAVE BEEN USED IN CALCULATING PLAN QUANTITIES:

GRANULAR MATERIALS	2.05	TONS / CU YD
BITUMINOUS MAT PRIME COAT	0.08	GAL / SQ YD OR
	0.375	GAL / SQ YD
AGGREGATE PRIME COAT	0.002	TONS / SQ YD
BITUMINOUS RESURFACING	112	LBS / SQ YD / IN
SHORT TERM PAVEMENT MARKING	10	FT / 100 FT OF APPLICATION
MIX FOR CRACKS, JTS & FLGWYS	0.0003	TONS / SQ YD
LEVEL BINDER (HAND METHOD)	0.0005	TONS / SQ YD
SUPPLEMENTAL WATERING	3	GAL / SQ YD / APPLICATION
CALCIUM CHLORIDE	2	LB / SQ YD / APPLICATION

ALL DAMAGE TO DEPARTMENT OWNED UNDERGROUND FACILITIES, CAUSED BY THE CONTRACTOR SHALL BE REPAIRED TO THE SATISFACTION OF THE DEPARTMENT AT THE CONTRACTOR'S EXPENSE. THIS SHALL INCLUDE ALL TEMPORARY REPAIRS REQUIRED TO KEEP THE FACILITY OPERATIONAL WHILE MATERIAL IS BEING OBTAINED TO MAKE PERMANENT REPAIRS. SPLICING OF ELECTRIC CABLE SHALL NOT BE ALLOWED. ELECTRIC CABLE SHALL BE REPLACED FROM POLE TO POLE OR CONTROLLER.

THE COST OF MAKING ANY SEWER CONNECTIONS TO AN EXISTING DRAINAGE STRUCTURE OR PIPE SHALL BE INCLUDED IN THE COST OF THE NEW SEWER.

ALL EQUIVALENT ROUND PIPE SHALL BE ARCHES.

MEMBERS OF JULIE KNOWN TO BE WITHIN THE LIMITS OF THE IMPROVEMENT ARE:

AT&T (SBC) 65 W. WEBSTER ST., 4TH FLOOR JOLIET, IL 60431	1-815-727-8049
COMED 1910 SOUTH BRIGGS STREET JOLIET, IL 60431	1-815-724-5170
NICOR GAS 1305 DR. MARTIN LUTHER KING DR. BLOOMINGTON, IL 61701	1-309-828-5002 EXT. 242
COMCAST 1304 MARQUETTE DRIVE ROSEMOUNT, IL 60446	1-847-489-0283
CITY OF MORRIS 700 DIVISION STREET MORRIS, IL 60450	1-815-942-5063

COMMITMENTS: THE CONTRACTOR SHALL NOTIFY ALL APPROPRIATE EMERGENCY SERVICES AND SCHOOL DISTRICTS TWO WEEKS IN ADVANCE OF THE WORK.

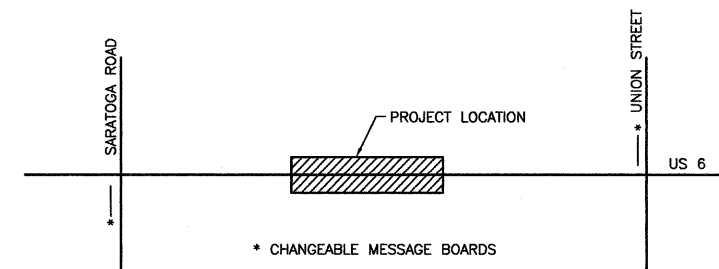

PUBLIC INFORMATION PLAN

- 1) CHANGEABLE MESSAGE BOARDS SHALL BE IN PLACE FOR TWO WEEKS PRIOR TO START OF CONSTRUCTION.
- 2) THE CONTRACTOR SHALL NOTIFY EMERGENCY SERVICES (POLICE, FIRE & AMBULANCE) IN WRITING 2 WEEKS PRIOR TO BEGINNING WORK AND SHALL GIVE 24 HOUR NOTICE OF SIDE STREET CLOSURES/CHANGES.

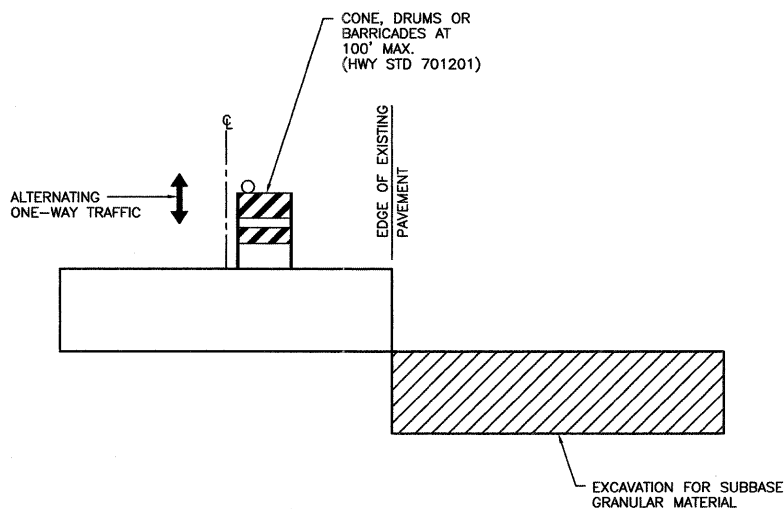

STAGE CONSTRUCTION WIDENING DETAIL

TRAFFIC CONTROL SHALL BE IN ACCORDANCE WITH HIGHWAY STANDARD 701201 DURING WORK TO EXCAVATE FOR SUB-BASE GRANULAR MATERIAL. THE FIRST 4" OF SUB-BASE GRANULAR MATERIAL SHALL BE PLACED PRIOR TO OPENING THE ADJACENT LANE. THEN TRAFFIC CONTROL SHALL BE IN ACCORDANCE WITH HIGHWAY STANDARD 701326.

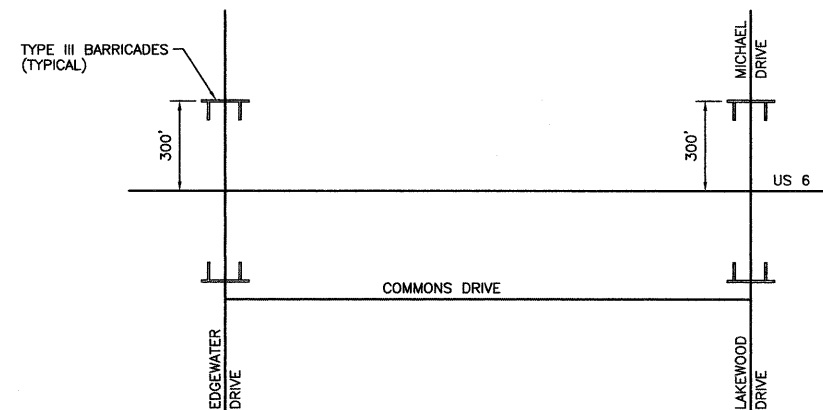

SIDE ROAD CLOSURE DETAIL

ONE SIDE ROAD INTERSECTION AT A TIME MAY BE CLOSED FOR PAVEMENT WIDENING THROUGH THE INTERSECTION. THE CLOSURES SHALL BE LIMITED TO 3 DAYS AT EACH INTERSECTION. TYPE III BARRICADES SHALL BE PLACED AT THE LOCATIONS SHOWN IN ACCORDANCE WITH HIGHWAY STANDARD 701901.

CHAMLIN & ASSOCIATES, INC. © 2010 Drawing Name: 03Users\j\0969-00-Morris-STU\CAD\PLANS-STU\002-DNOTES.dwg User: jchamlin Date: 10/11/11 9:55am Plotted on: Oct 17, 2011 9:55am by: jchamlin

DRAWN BY: CHAMS	REVISIONS					PERU MORRIS ILLINOIS	FAU 5952 (US 6) SECTION 10-00083-00-TL CITY OF MORRIS GRUNDY COUNTY	GENERAL NOTES AND TRAFFIC CONTROL	CONSTRUCTION PLANS	CONTRACT NO. 87486	
	CHECKED BY: JKC	LEVEL	BY	DATE						DESCRIPTION	CURRENT AS OF: 10/11
DATE: 10/11										FILE NO.: 6969.00	Y- OF 70