

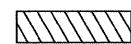

-  HOT-MIX ASPHALT BASE COURSE WIDENING
-  HOT-MIX ASPHALT SURFACE REMOVAL, BUTT JOINT
-  PCC BASE COURSE WIDENING
-  PCC DRIVEWAY, 8"
-  TEMPORARY DITCH CHECK
-  INLET AND PIPE PROTECTION

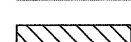
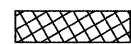
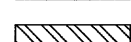

CHAMBLIN & ASSOCIATES, INC. © 2010  
 Drawing Name: CA\Urban VA\8889-00-Morris-STU\CAD\PLANS-STU\016-PP914-520.dwg Last Modified: Sep 22, 2011 - 9:27am Plotted on: Oct 13, 2011 - 10:22am by nancjg

DRAWN BY: CHAMS	REVISIONS		
CHECKED BY: JKC	LEVEL	BY	DATE
DATE: 10/11			

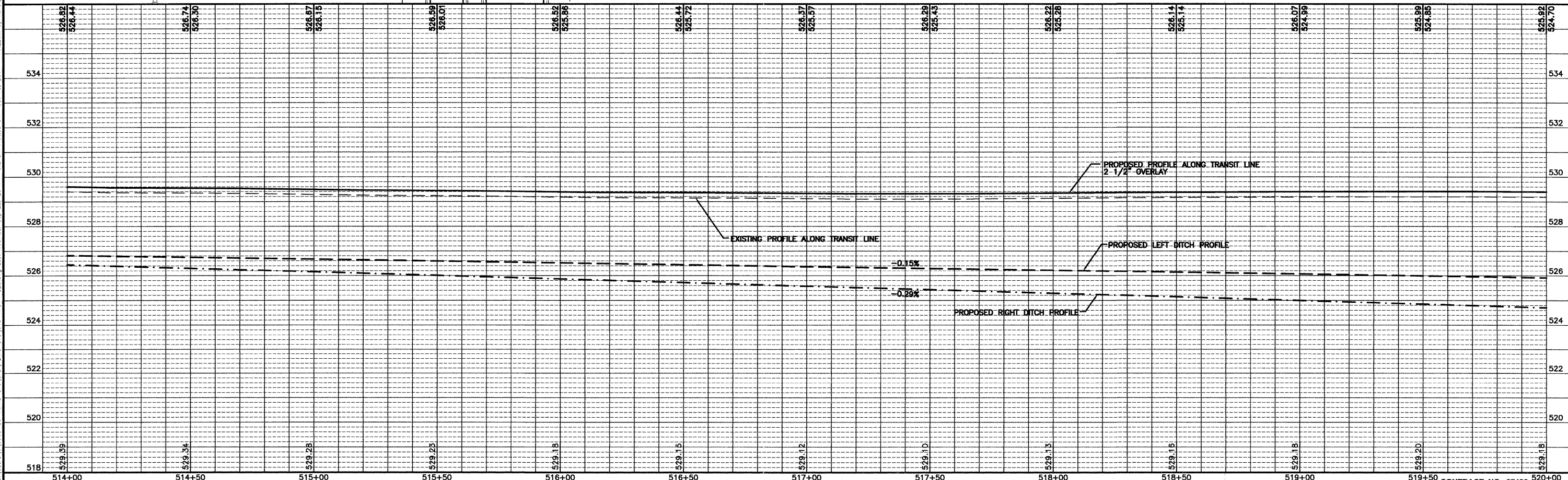
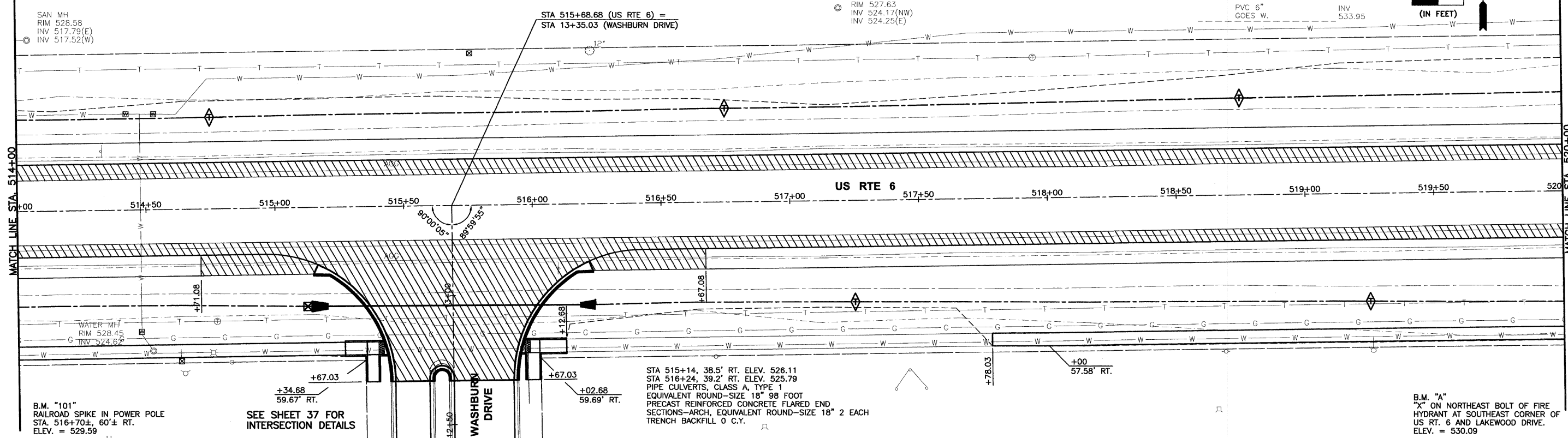
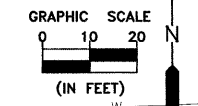
 PERU MORRIS  
 ILLINOIS

FAU 5952 (US 6)  
 SECTION 10-00083-00-TL  
 CITY OF MORRIS  
 GRUNDY COUNTY

PLAN AND PROFILE  
 US 6  
 STA. 514+00 TO STA. 520+00

**CONSTRUCTION PLANS**

CURRENT AS OF: 10/11	
SCALE: AS NOTED	SHEET 16
FILE NO.: 6969.00 Y-	OF 70

CONTRACT NO. 87486