

STA. 526+37, 42.0' LT. ELEV. = 524.96
 STA. 526+99, 39.0' LT. ELEV. = 524.87
 PIPE CULVERTS, CLASS D, TYPE 1
 EQUIVALENT ROUND-SIZE 24" 50 FOOT
 METAL END SECTIONS, EQUIVALENT
 ROUND-SIZE 24" 2 EACH
 TRENCH BACKFILL 9 C.Y.

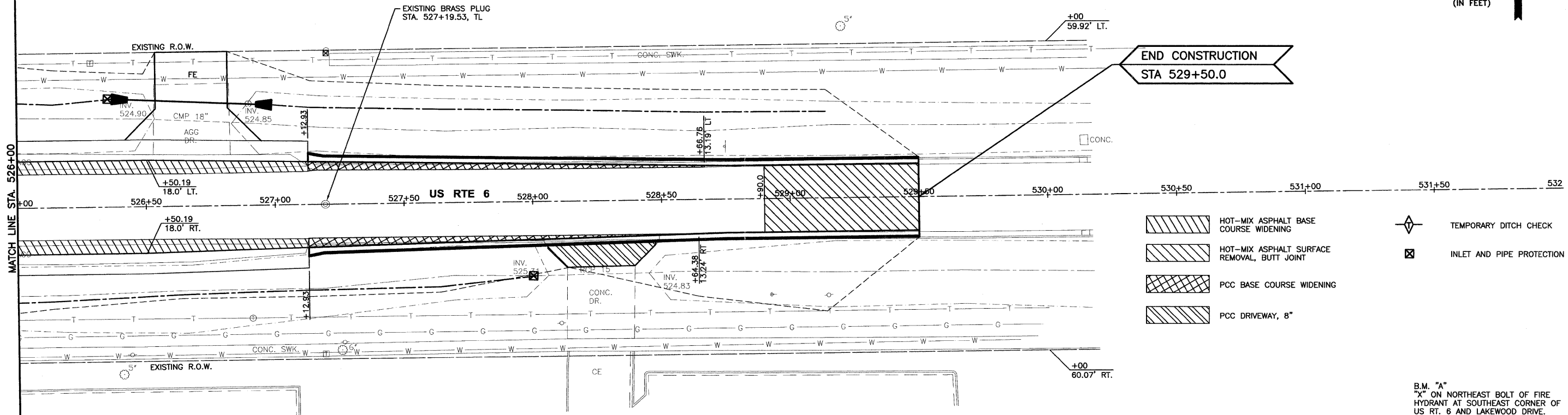

- HOT-MIX ASPHALT BASE COURSE WIDENING
- HOT-MIX ASPHALT SURFACE REMOVAL, BUTT JOINT
- PCC BASE COURSE WIDENING
- PCC DRIVEWAY, 8"
- TEMPORARY DITCH CHECK
- INLET AND PIPE PROTECTION

B.M. "A"
 "X" ON NORTHEAST BOLT OF FIRE
 HYDRANT AT SOUTHEAST CORNER OF
 US RT. 6 AND LAKEWOOD DRIVE.
 ELEV. = 530.09

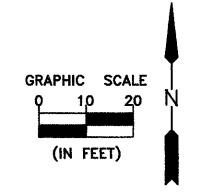
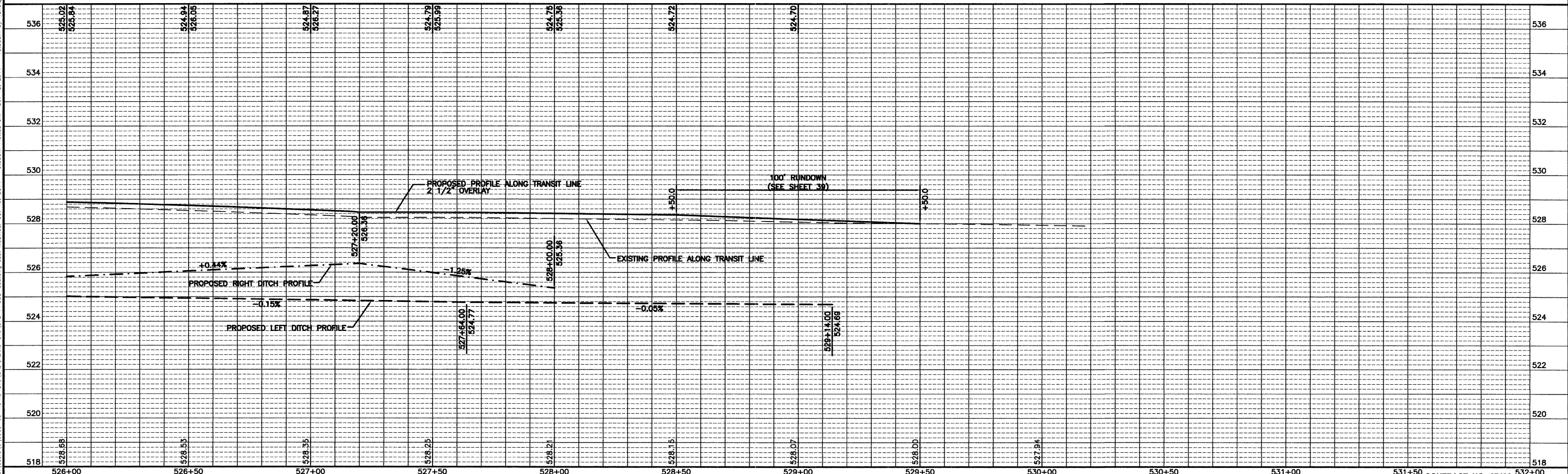

CHAMBLIN & ASSOCIATES, INC. © 2010
 Drawing Name: C:\Users\jchamblin\Documents\10-00083-00-Morris-Stu\CAD\PLANS-STU\018-PP526-532.dwg
 Date: Oct 13, 2011 - 9:53am
 Plotted on: Oct 13, 2011 - 10:30am by nancija

DRAWN BY: CHAMS	REVISIONS		
CHECKED BY: JKC	LEVEL	BY	DATE
DATE: 10/11			

CHAMBLIN & ASSOCIATES
 PERU MORRIS ILLINOIS

FAU 5952 (US 6)
 SECTION 10-00083-00-TL
 CITY OF MORRIS
 GRUNDY COUNTY

PLAN AND PROFILE
 US 6
 STA. 526+00 TO STA. 529+50

CONSTRUCTION PLANS

CURRENT AS OF: 10/11	
SCALE: AS NOTED	SHEET 18
FILE NO.: 6969.00 Y-	OF 70

CONTRACT NO. 87486