

ROUTE	SECTION	COUNTY	TOWNSHIP	TOTAL SHEETS	SHEET NUMBER
FAS 1919	06-00144-00-WR	JACKSON	MAKANDA	91	72
JOB NO. C-99-579-06			PROJECT NO. SR-1919(106)		
BOSKYDELL ROAD			CONTRACT NO. 99338		

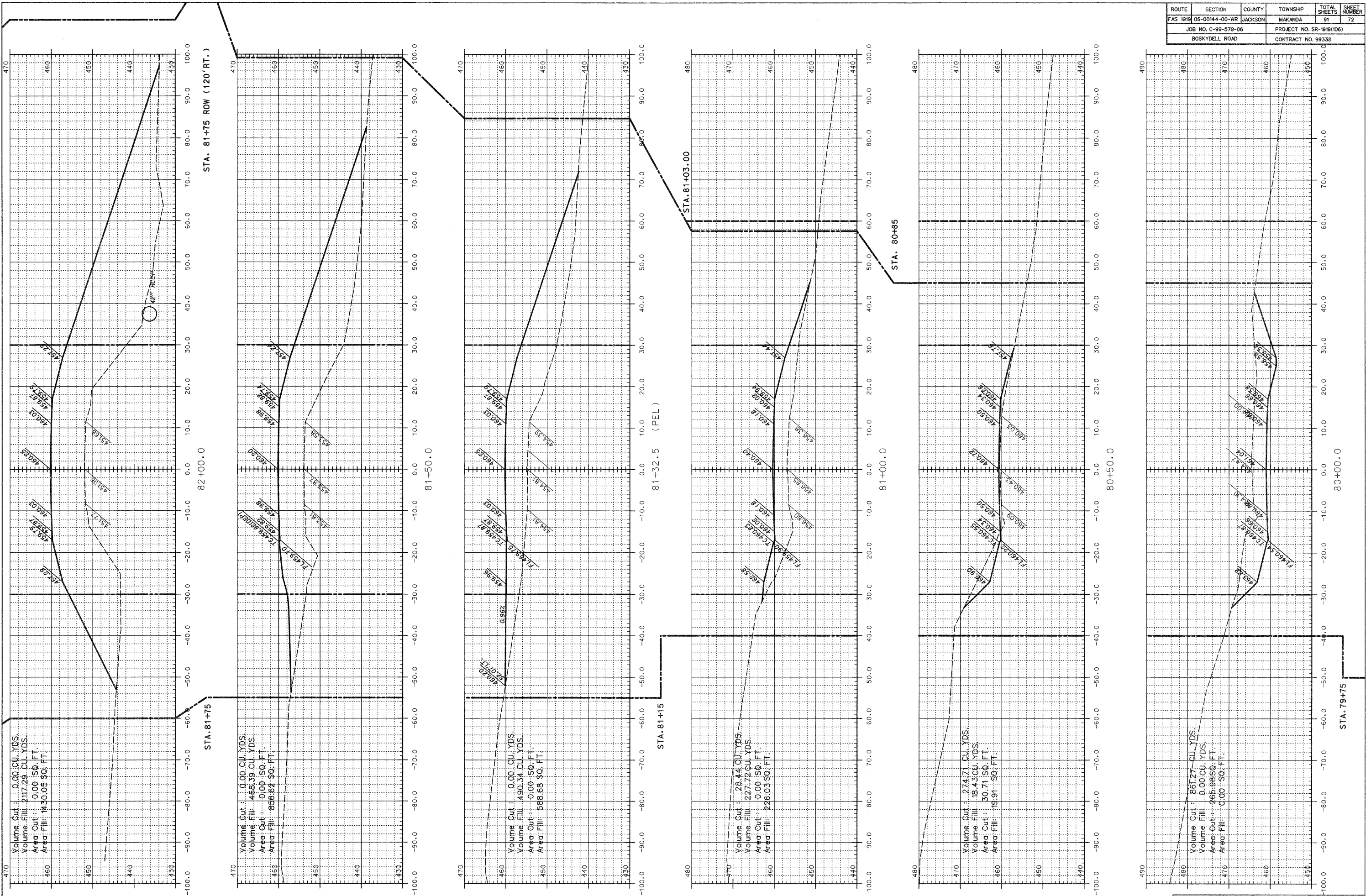

Volume Cut: 0.00 CU. YDS.
 Volume Fill: 217.29 CU. YDS.
 Area Cut: 0.00 SQ. FT.
 Area Fill: 1430.05 SQ. FT.

Volume Cut: 0.00 CU. YDS.
 Volume Fill: 468.39 CU. YDS.
 Area Cut: 0.00 SQ. FT.
 Area Fill: 856.62 SQ. FT.

Volume Cut: 0.00 CU. YDS.
 Volume Fill: 490.34 CU. YDS.
 Area Cut: 0.00 SQ. FT.
 Area Fill: 588.68 SQ. FT.

Volume Cut: 28.44 CU. YDS.
 Volume Fill: 227.72 CU. YDS.
 Area Cut: 0.00 SQ. FT.
 Area Fill: 226.03 SQ. FT.

Volume Cut: 274.71 CU. YDS.
 Volume Fill: 18.43 CU. YDS.
 Area Cut: 30.71 SQ. FT.
 Area Fill: 1931 SQ. FT.

Volume Cut: 861.77 CU. YDS.
 Volume Fill: 0.00 CU. YDS.
 Area Cut: 465.96 SQ. FT.
 Area Fill: 0.00 SQ. FT.

NOTE: QUANTITIES SHOWN ARE TO FINISH GRADE. THE ROADWAY MATERIAL IS INCLUDED IN THE QUANTITIES.

LEGEND
 - - - - - EXISTING RIGHT-OF-WAY
 - - - - - NEW RIGHT-OF-WAY
 - - - - - TEMPORARY USE PERMIT

JACKSON COUNTY HIGHWAY DEPARTMENT
 JACKSON COUNTY, ILLINOIS
 BOSKYDELL ROAD
 CROSS SECTIONS - STA. 80+00 TO STA. 82+00