

ROUTE	SECTION	COUNTY	TOWNSHIP	TOTAL SHEETS	SHEET NUMBER
FAS 1919	06-00144-00-WR	JACKSON	MAKANDA	91	89
JOB NO. C-99-579-06		PROJECT NO. SR-1919(106)			
BOSKYDELL ROAD		CONTRACT NO. 99338			

LEGEND

- PROPOSED RIGHT-OF-WAY
- PROPOSED RIGHT-OF-WAY MARKER
- EXISTING SIGN
- NEW LOCATION FOR EXISTING SIGN
- PROPOSED SIGN
- RAISED REFLECTIVE PAVEMENT MARKER, BIDIRECTIONAL (AMBER/AMBER)

NOTE: PRIVATELY OWNED SIGNS TO BE REMOVED AND REINSTALLED AS DIRECTED BY THE OWNER AND WITH THE APPROVAL OF THE ENGINEER.

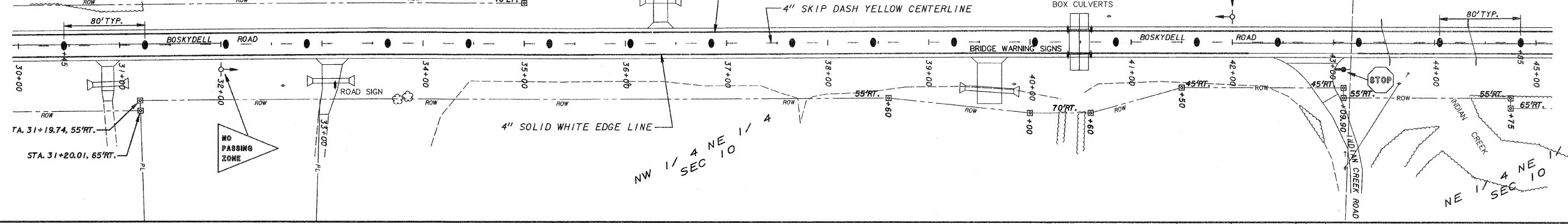

LEGEND

- PROPOSED RIGHT-OF-WAY
- PROPOSED RIGHT-OF-WAY MARKER
- EXISTING SIGN
- NEW LOCATION FOR EXISTING SIGN
- PROPOSED SIGN
- RAISED REFLECTIVE PAVEMENT MARKER, BIDIRECTIONAL (AMBER/AMBER)

NOTE: PRIVATELY OWNED SIGNS TO BE REMOVED AND REINSTALLED AS DIRECTED BY THE OWNER AND WITH THE APPROVAL OF THE ENGINEER.

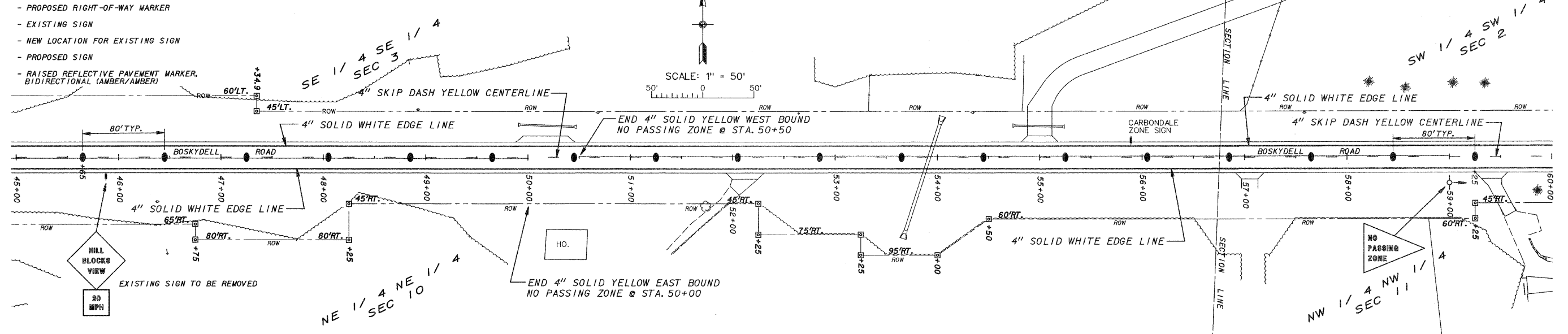

NOTE: PRIVATELY OWNED SIGNS TO BE REMOVED AND REINSTALLED AS DIRECTED BY THE OWNER AND WITH THE APPROVAL OF THE ENGINEER.

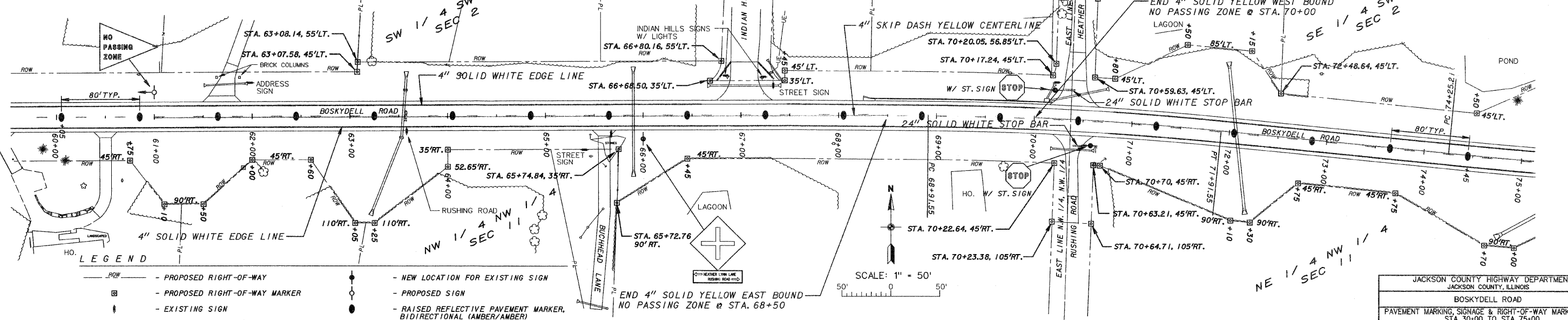

LEGEND

- PROPOSED RIGHT-OF-WAY
- PROPOSED RIGHT-OF-WAY MARKER
- EXISTING SIGN
- NEW LOCATION FOR EXISTING SIGN
- PROPOSED SIGN
- RAISED REFLECTIVE PAVEMENT MARKER, BIDIRECTIONAL (AMBER/AMBER)