

STATE OF ILLINOIS
 DEPARTMENT OF TRANSPORTATION
 OFFICE OF HIGHWAYS PROJECT IMPLEMENTATION

F.A. RTE.	SECTION	COUNTY	TOTAL SHEETS	SHEET NO.
VAR	D9 CRACK SEAL 2017-2	ILLINOIS	7	1
CONTRACT NO. 78541				

*SALINE AND WHITE

D-99-043-16

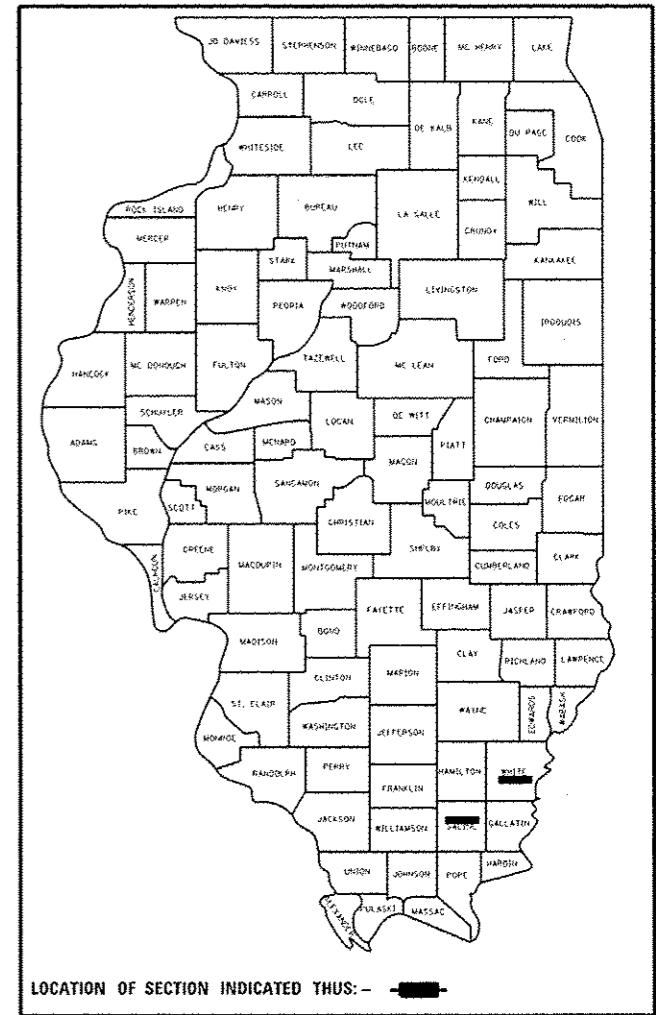

**PROPOSED
 HIGHWAY PLANS**

VARIOUS ROUTES
 SECTION D9 CRACK SEAL 2017-2

**CRACK SEALING
 WHITE AND SALINE COUNTY**

C-99-043-16

FOR INDEX OF SHEETS, SEE SHEET NO. 3
 FOR SUMMARY OF QUANTITIES, SEE SHEET NO. 4

VARIOUS LOCATIONS	
ROUTE	COUNTY
US ROUTE 45	SALINE COUNTY
ILLINOIS ROUTE 13	SALINE COUNTY
ILLINOIS ROUTE 34	SALINE COUNTY
INTERSTATE 64	WHITE COUNTY
ILLINOIS ROUTE 1	WHITE COUNTY
ILLINOIS ROUTE 14	WHITE COUNTY
US ROUTE 45	WHITE COUNTY

TOWNSHIPS

HARRISBURG	GRAY
RALEIGH	ENFIELD
ELDORADO	CARM
	INDIAN CREEK

TRAFFIC DATA

- LOCATION 1 - ADT=9400 TRUCKS=10.1%
- LOCATION 2 - ADT=7150 TRUCKS=12.2%
- LOCATION 3 - ADT=3950 TRUCKS=27.8%
- LOCATION 4 - ADT=4600 TRUCKS=23.9%
- LOCATION 5 - ADT=10,300 TRUCKS=45.1%
- LOCATION 6 - ADT=3800 TRUCKS=15.8%
- LOCATION 7 - ADT=3600 TRUCKS=13.6%
- LOCATION 8 - ADT=2700 TRUCKS=18.9%

COORDINATE SYSTEM : N/A

POSTED SPEED : VARIES

J.U.L.I.E.
 JOINT UTILITY LOCATION INFORMATION FOR EXCAVATION
 1-800-892-0123
 OR 811

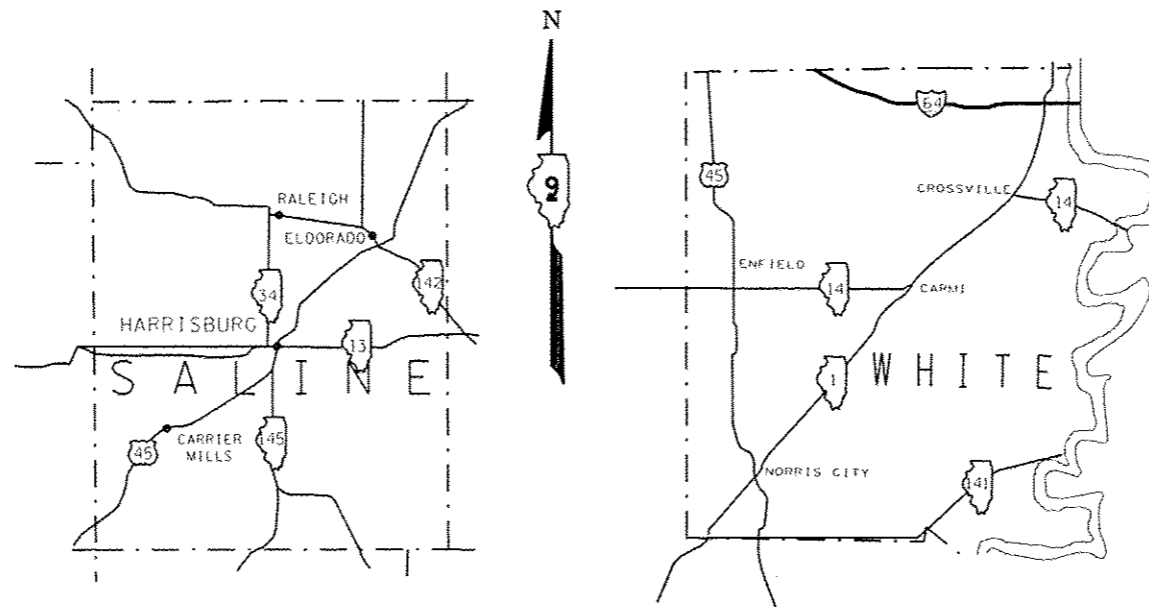

PROJECT ENGINEER CHARLES STEIN (618) 351-5210
 PROJECT DESIGNER ELISE KNOP (618) 351-5212

GROSS LENGTH = 63.4 MILES

CONTRACT NO. 78541

STATE OF ILLINOIS
 DEPARTMENT OF TRANSPORTATION
 OFFICE OF HIGHWAYS PROJECT IMPLEMENTATION

SUBMITTED Oct 18 20 16
Jeffrey L. Keim
 REGION FIVE ENGINEER

Dec 9 20 16
Maureen M. Addis P.E.
 ENGINEER OF DESIGN AND ENVIRONMENT

Dec 9 20 16
James A. [Signature]
 DIRECTOR OF PROGRAM DEVELOPMENT

**PRINTED BY THE AUTHORITY
 OF THE STATE OF ILLINOIS**

Prepared By: [Signature]
 DISTRICT STUDIES & PLANS ENGINEER

Examined By: [Signature]
 DISTRICT LAND ACQUISITION ENGINEER

Examined By: [Signature]
 DISTRICT PROGRAM DEVELOPMENT ENGINEER

Examined By: [Signature]
 DISTRICT OPERATIONS ENGINEER

Examined By: [Signature]
 DISTRICT PROJECT IMPLEMENTATION ENGINEER

Examined By: [Signature]
 DISTRICT CONSTRUCTION ENGINEER

Examined By: [Signature]
 DISTRICT MATERIALS ENGINEER

*SALINE AND WHITE

FILE NAME	USER NAME - knopen	DESIGNED -	REVISED -	STATE OF ILLINOIS DEPARTMENT OF TRANSPORTATION	SIGNATURE SHEET				F.A. RTE.	SECTION	COUNTY	TOTAL SHEETS	SHEET NO.	
Q:\11\10846810\INTEG\Illinois\ga-9\1001\Documents\DOT Offices\District 9\Projects\7854\Drawings\CD\Saline\7854-shr-plan.dgn		CHECKED -	REVISED -		SCALE:	SHEET	OF	SHEETS	STA.	TO STA.	VAR.	D9 CRACK SEAL 2017-2	7	2
MODEL NAME	PLOT SCALE = 100.0000 / in.	DATE	REVISED -											
	PLOT DATE = 10-17-2016													

ILLINOIS FED. AID PROJECT

INDEX OF SHEETS

SHEET NO.	DESCRIPTION
1	COVER SHEET
2	SIGNATURE SHEET
3	INDEX OF SHEETS, GENERAL NOTES, STATION EQUATIONS & OMISSIONS, ILLINOIS HIGHWAY STANDARDS, & COMMITMENTS
4	SUMMARY OF QUANTITIES
5-6	LOCATION MAPS
7	SCHEDULE OF QUANTITIES

GENERAL NOTES

FACTORS USED FOR QUANTITY CALCULATIONS ARE AS FOLLOWS:
JOINT SEALER 0.65 LB/FT

THE QUANTITY USED FOR CRACK FILLING IS AN ESTIMATE. THE ACTUAL AMOUNT USED WILL BE DETERMINED BY THE ENGINEER.

HIGHWAY STANDARDS

- 701301-04_LnClosure2L2W-ShortTimeOp
- ~~701301-03-LnClosure2L2W-SlowMoveOpDayOnly45MPHOrMore~~
- 701411-09_LnClosureMultiLn-EntrOrExitRamp45MPHOrMore
- 701426-09_LnClosureMultiLn-IntermittantOrMovingOp45MPHOrMore
- 701501-06_UrbanLnClosure2L2W-Undivided
- 701502-08_UrbanLnClosure2L2WWithBidirectLeftTurnLn
- 701602-08_UrbanLnClosureMultiLn2WWithBidirectLeftTurnLn
- 701901-06_TrafCntnIDevices

STATION EQUATIONS

IL 14
STA. 0+00 BK = STA. 0+00 AH
STA. 13+34.3 BK = STA. 13+58.6 AH
STA. 44+29.7 BK = STA. 44+45.6 AH
STA. 348+41.58 BK = STA. 348+41.7 AH
STA. 445+16.65 BK = STA. 445+18.7 AH

IL 1
STA. 498+70. BK = STA. 497+94.74 AH

STATION OMISSIONS

I-64
STA. 5763+58. TO STA. 5764+72.

IL 1
STA. 581+27.9 TO STA. 583+19.9

IL 34
STA. 1370+00. TO STA. 1481+00.
STA. 1541+73.2 TO STA. 1542+26.72
STA. 1560+92.4 TO STA. 1562+47.6
STA. 1573+62.1 TO STA. 1574+37.9
STA. 1581+78.5 TO STA. 1582+81.5

US 45 WHITE COUNTY
STA. 83+18. TO STA. 86+10.

COMMITMENTS

NONE.

FILE NAME =				USER NAME = knopen				DESIGNED -				REVISOR -				STATE OF ILLINOIS DEPARTMENT OF TRANSPORTATION				INDEX OF SHEETS, STATION EQUATIONS & OMISSIONS, GENERAL NOTES, & HIGHWAY STANDARDS				*SALINE AND WHITE			
F.A. RTE.		SECTION		COUNTY		TOTAL SHEETS		SHEET NO.		SCALE:		SHEET OF SHEETS		STA. TO STA.		CONTRACT NO. 78541		ILLINOIS FED. AID PROJECT									
p:\11L084E01\INTEC\Illinois.gov\FWIDOT\Documents\DOT Offices\District 9\Projects\78541\78541-03-CAD\Sheet\78541-03-Plan.dgn		PLLOT SCALE = 100.0000' / 1" / in.		CHECKED -		REVISOR -		DATE -		REVISOR -		SCALE:		SHEET OF SHEETS		STA. TO STA.		CONTRACT NO. 78541		ILLINOIS FED. AID PROJECT							

SUMMARY OF QUANTITIES

CODE NUMBER	ITEM DESCRIPTION	UNIT	TOTAL	WHITE CO.	SALINE CO.
				100% STATE RURAL ROADWAY 0005	100% STATE RURAL ROADWAY 0005
45100100	CRACK ROUTING (PAVEMENT)	FOOT	334,834	167,417	167,417
45100200	CRACK FILLING	POUND	217,642	108,821	108,821
67100100	MOBILIZATION	L SUM	1	0.5	0.5
70100420	TRAFFIC CONTROL AND PROTECTION, STANDARD 701411	EACH	2	1	1
70100460	TRAFFIC CONTROL AND PROTECTION, STANDARD 701306	L SUM	1	0.5	0.5
70102622	TRAFFIC CONTROL AND PROTECTION, STANDARD 701502	L SUM	1	0.5	0.5
70102632	TRAFFIC CONTROL AND PROTECTION, STANDARD 701602	L SUM	1	0.5	0.5

7

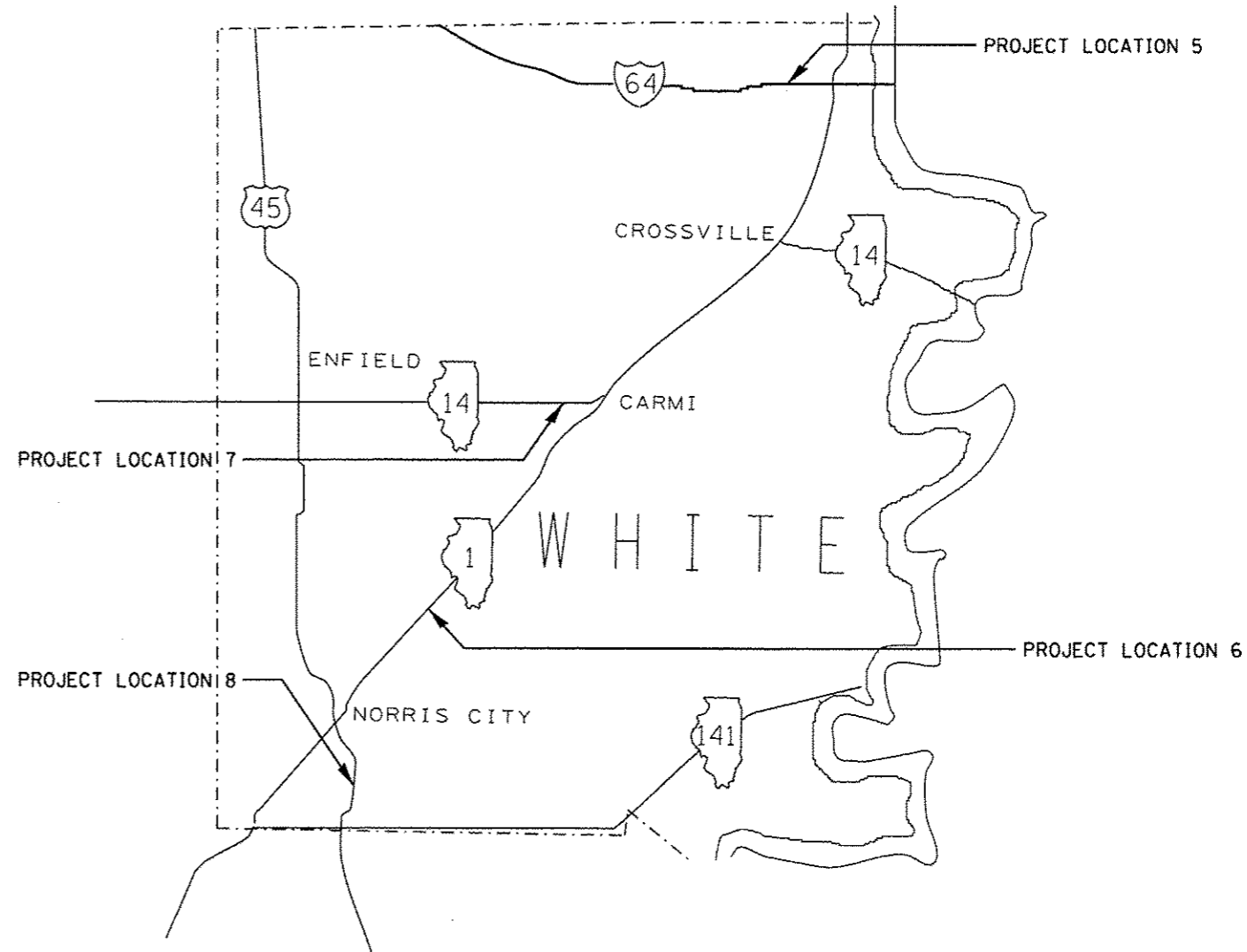
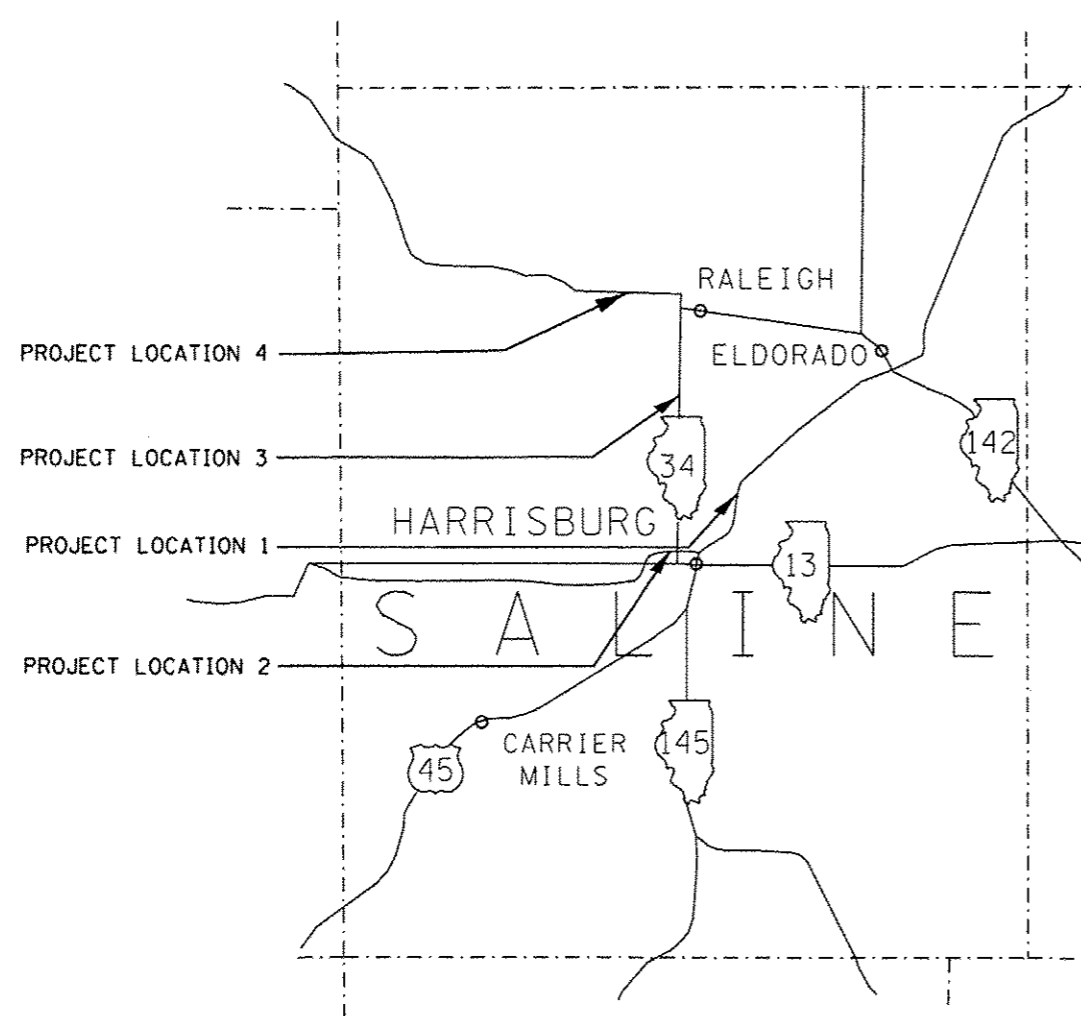

PROJECT LOCATIONS

#	ROUTE	COUNTY	START	END
1	US ROUTE 45	SALINE COUNTY	NORTH OF SMALL STREET	WEST OF BANTERRA BANK IN ELDORADO
2	ILLINOIS ROUTE 13	SALINE COUNTY	ILLINOIS ROUTE 34	WEST OF LOVERS LANE HARRISBURG
3	ILLINOIS ROUTE 34	SALINE COUNTY	HARRISBURG LEVY	NORTH ENTRANCE LITTLE CHAPEL CHURCH
4	ILLINOIS ROUTE 34	SALINE COUNTY	NORTH OF RALEIGH ROAD	MINE ENTRANCE ROAD
5	INTERSTATE 64	WHITE COUNTY	MM 122.5 E	WABASH RIVER BRIDGE
6	ILLINOIS ROUTE 1	WHITE COUNTY	OLD NORRIS CITY RD	NORTH COMMERCE STREET CARM
7	ILLINOIS ROUTE 14	WHITE COUNTY	WHITE COUNTY LINE	ILLINOIS ROUTE 1 CARM
8	US ROUTE 45	WHITE COUNTY	NORTH OF 141	ROUTE 1 AND US 45 INTERSECTION

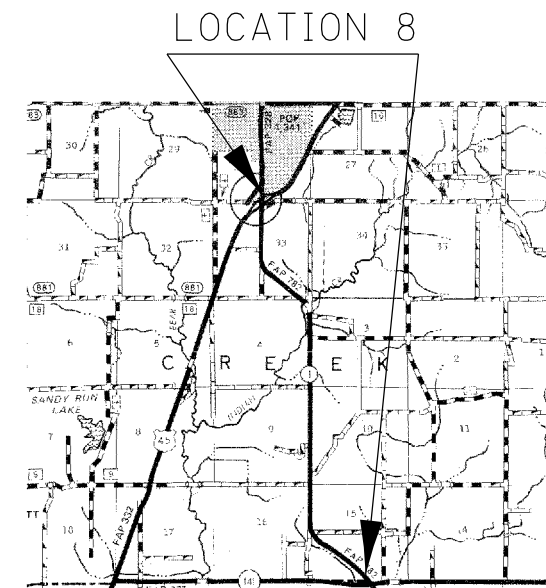
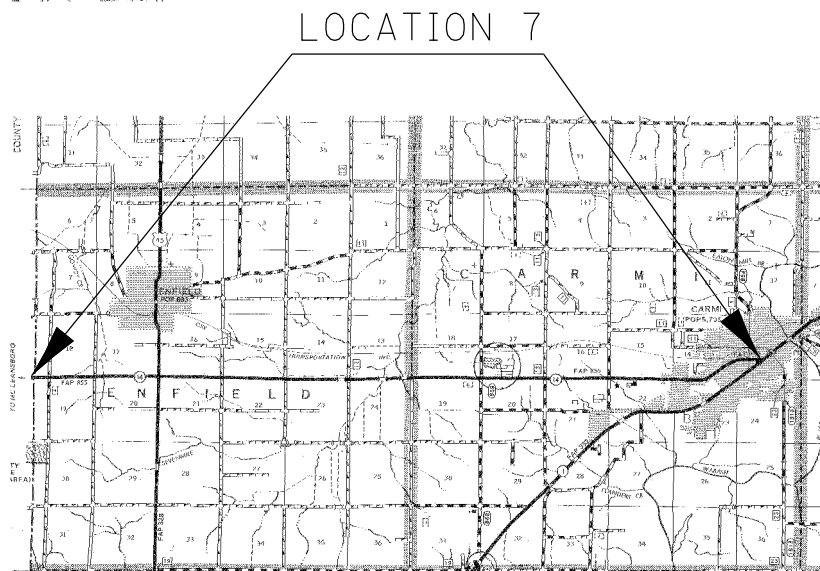
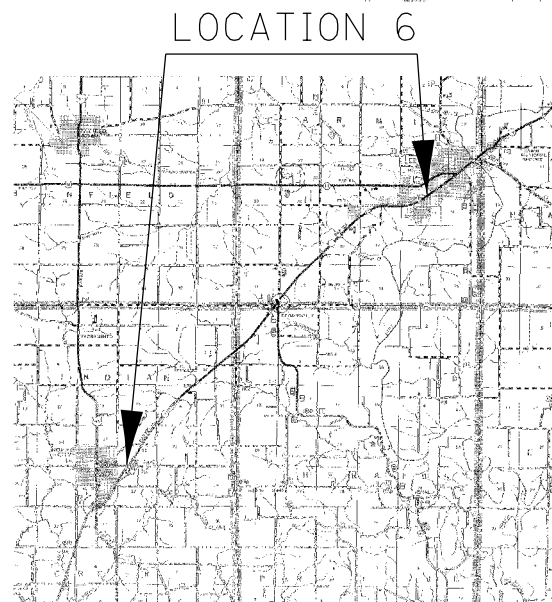
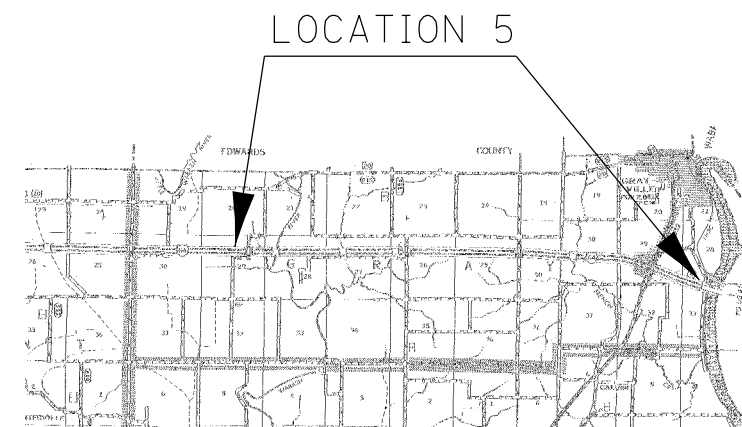
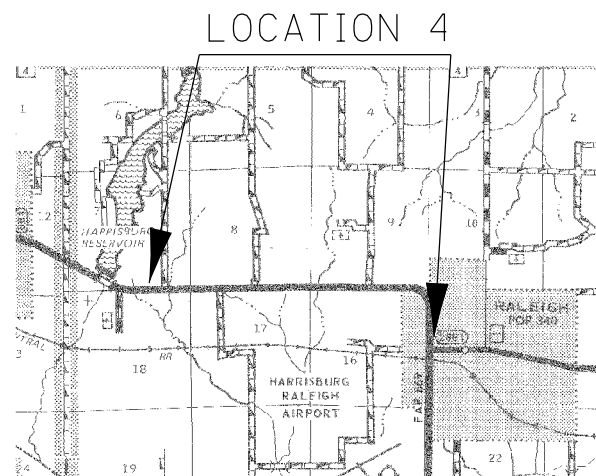
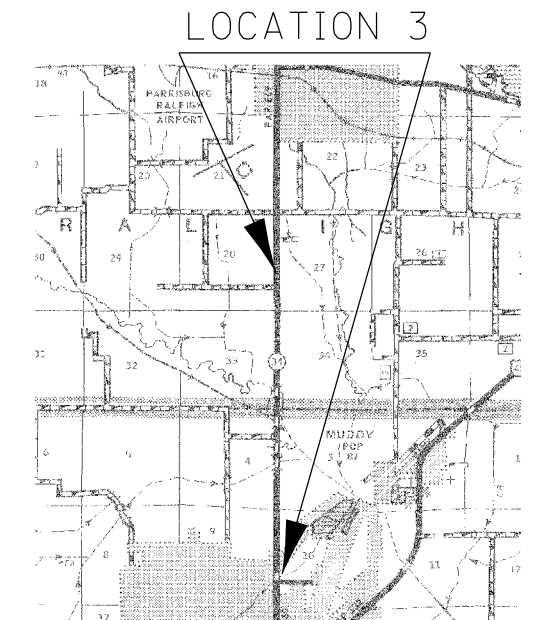
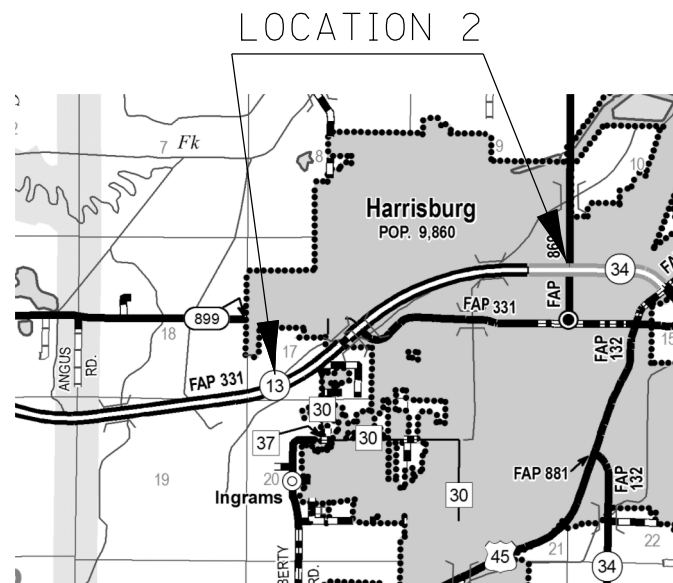
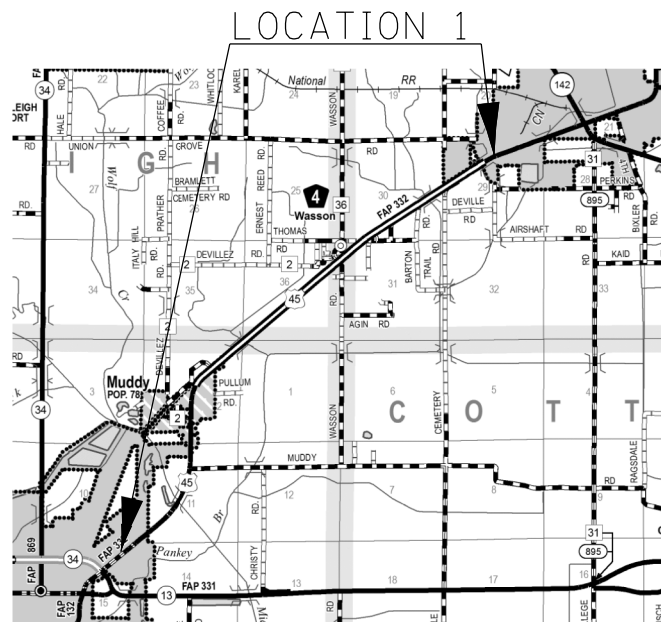

FILE NAME =	USER NAME = knopen	DESIGNED -	REVISED -
pw:\IL\084EBID\INTEG\illinois.gov\PI\DOT\Documents\DOT Offices\District 9\Projects\78541\Drawings\CAD\Sheets\78541-sht-plen.dgn		REVISED -	REVISED -
Default	PLOT SCALE = 100.0000' / in.	CHECKED -	REVISED -
	PLOT DATE = 10/18/2016	DATE -	REVISED -

**STATE OF ILLINOIS
DEPARTMENT OF TRANSPORTATION**

LOCATION MAPS

SCALE: SHEET OF SHEETS STA. TO STA.

*SALINE AND WHITE

F.A. RTÉ.	SECTION	COUNTY	TOTAL SHEETS	SHEET NO.
VAR.	D9 CRACK SEAL 2017-2	*	7	6
			CONTRACT NO. 78541	
ILLINOIS FED. AID PROJECT				

LOCATION	ROUTE	COUNTY	STA.	TO	STA.	LENGTH (FT)	CENTER OF ROADWAY LONGITUDINAL CRACKS ONLY		COMMENTS
							CRACK ROUTING (FT)	CRACK FILLING (POUND)	
1	US 45	SALINE	66+00	TO	134+35	6, 835	27, 340	17, 771	5 LANES - 4 CENTERLINE JOINTS
1	US 45	SALINE	134+35	TO	330+00	19, 565	39, 130	25, 435	4 LANES - 2 CENTERLINE JOINTS
1	US 45	SALINE	330+00	TO	332+00	200	800	520	5 LANES - 4 CENTERLINE JOINTS
2	IL 13	SALINE	1053+59	TO	945+50	10, 809	21, 618	14, 051	4 LANES - 2 CENTERLINE JOINTS
3	IL 34	SALINE	1637+00	TO	1481+00	15, 213	15, 213	9, 888	2 LANES - 1 CENTERLINE JOINT
4	IL 34	SALINE	1370+00	TO	1216+00	15, 400	15, 400	10, 010	2 LANES - 1 CENTERLINE JOINT
5	I-64	WHITE	MM 122.5	TO	MM 130	39, 486	78, 972	51, 332	4 LANES - 2 CENTER LINE JOINTS
6	IL 1	WHITE	998+92	TO	478+30	51, 795	51, 795	33, 667	2 LANES - 1 CENTERLINE JOINT
7	IL 14	WHITE	597+06	TO	6A+95	60, 359	60, 359	39, 233	2 LANES - 1 CENTERLINE JOINT
8	US 45	WHITE	10+00	TO	255+00	24, 208	24, 208	15, 735	2 LANES - 1 CENTERLINE JOINT
TOTAL							334, 834	217, 642	

***SALINE AND WHITE**