

80% FED
20% STATE

SUMMARY OF QUANTITIES			TOTAL QUANTITIES	CONSTRUCTION TYPE CODE		
CODE NO	ITEM	UNIT		0047		
70400100	TEMPORARY CONCRETE BARRIER	FOOT	562.5	562.5		
70400125	PINNING TEMPORARY CONCRETE BARRIER	EACH	36	36	⚠	
70400200	RELOCATE TEMPORARY CONCRETE BARRIER	FOOT	562.5	562.5		
70600250	IMPACT ATTENUATORS, TEMPORARY (NON-REDIRECTIVE), TEST LEVEL 3	EACH	2	2		
70600350	IMPACT ATTENUATORS, RELOCATE (NON-REDIRECTIVE), TEST LEVEL 3	EACH	2	2		
* 78001110	PAINT PAVEMENT MARKING - LINE 4"	FOOT	1381	1381		
Z0004552	APPROACH SLAB REMOVAL	SQ YD	107	107		
Z0012111	BRIDGE DECK FLY ASH OR GGBF SLAG CONCRETE OVERLAY, 2 1/2"	SO YD	742	742		
Z0012144	BRIDGE DECK SCARIFICATION 2 1/2"	SO YD	742	742		
Z0012754	STRUCTURAL REPAIR OF CONCRETE (DEPTH EQUAL TO OR LESS THAN 5 INCHES)	SO FT	22	22		
Z0016001	DECK SLAB REPAIR (FULL DEPTH, TYPE I)	SO YD	25	25		
Z0016002	DECK SLAB REPAIR (FULL DEPTH, TYPE II)	SO YD	13	13		

* SPECIALTY ITEM

⚠ REVISED 1-3-2023

REV. - MS

MODEL: Default
FILE NAME: p:\wildebeew_bentley.com\p\id\DOT\Documents\DOT_Offices\District_7\Projects\74A91\CADD\Drawings\CAD\Sheets\074A91-SP-S00.dgn

USER NAME = Jessica.Hille	DESIGNED -	REVISED -
	DRAWN -	REVISED -
PLOT SCALE = 100.0000' / in.	CHECKED -	REVISED -
PLOT DATE = 10/13/2022	DATE -	REVISED -

STATE OF ILLINOIS
DEPARTMENT OF TRANSPORTATION

SUMMARY OF QUANTITIES

SCALE: SHEET 2 OF 2 SHEETS STA. TO STA.

F.A.P. RTE.	SECTION	COUNTY	TOTAL SHEETS	SHEET NO.
322	D7 BRIDGE REPAIRS 2023-5	FAYETTE	23	4
			CONTRACT NO. 74A91	
ILLINOIS FED. AID PROJECT				

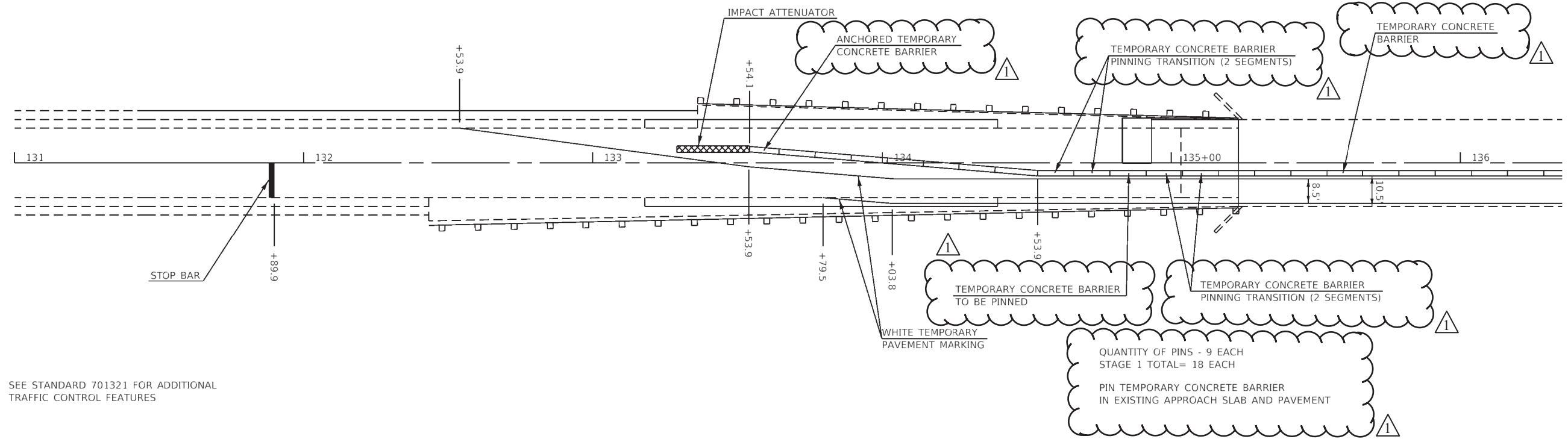

SEE STANDARD 701321 FOR ADDITIONAL TRAFFIC CONTROL FEATURES

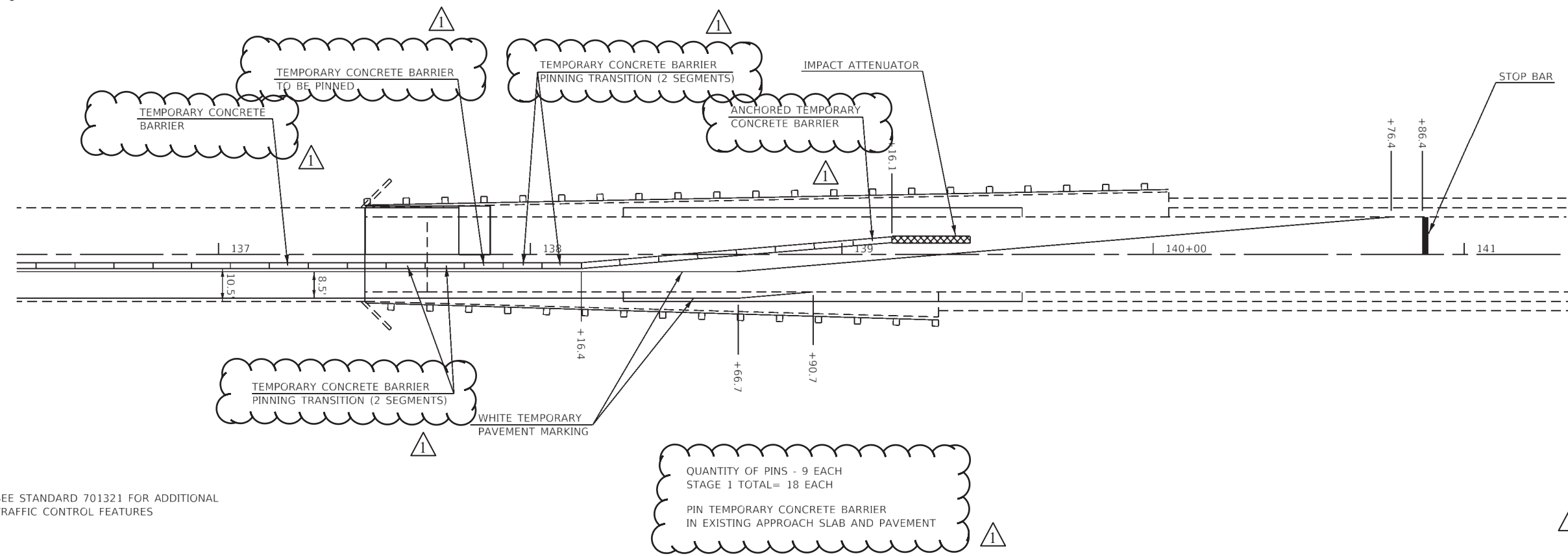

SEE STANDARD 701321 FOR ADDITIONAL TRAFFIC CONTROL FEATURES

△ REVISED 1-3-2023

MODEL - \$MODELNAME\$
FILE NAME - \$FILE\$

USER NAME = \$USERS	DESIGNED -	REVISED -
	DRAWN -	REVISED -
PLOT SCALE = \$SCALE\$	CHECKED -	REVISED -
PLOT DATE = \$DATE\$	DATE -	REVISED -

**STATE OF ILLINOIS
DEPARTMENT OF TRANSPORTATION**

**STAGE I TRAFFIC CONTROL
PLAN SHEET**

SCALE: SHEET 1 OF 1 SHEETS STA. TO STA.

F.A.P. RTE.	SECTION	COUNTY	TOTAL SHEETS	SHEET NO.
322	D7 BRIDGE REPAIR 2023-5	FAYETTE	23	10
ILLINOIS FED. AID PROJECT			CONTRACT NO. 74A91	

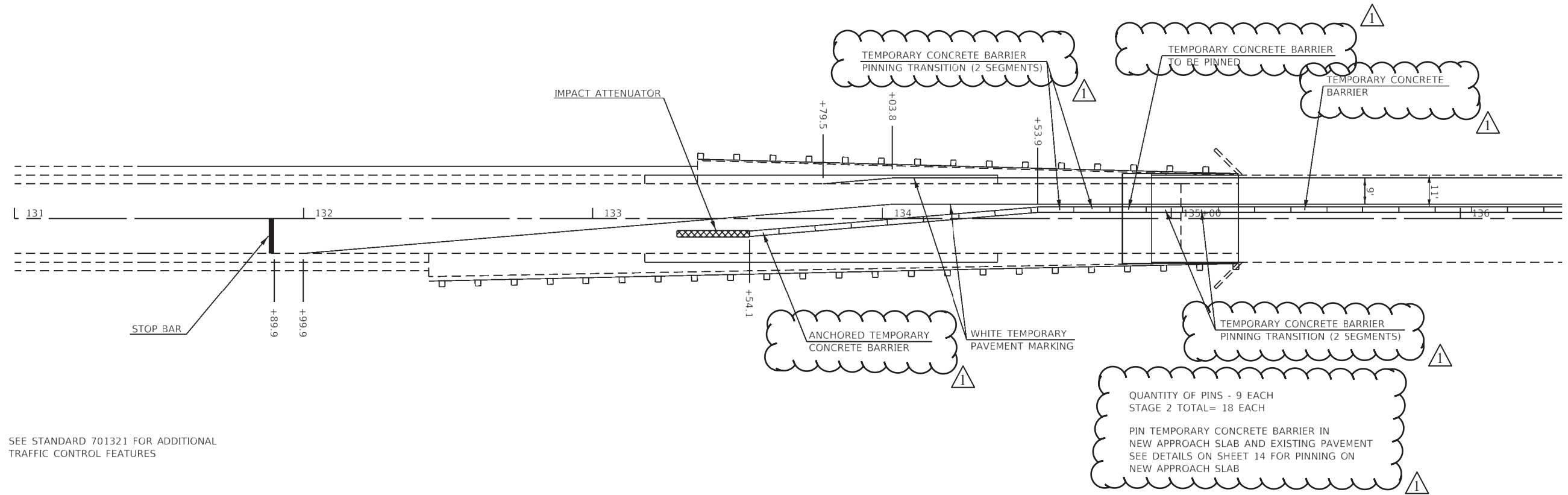

SEE STANDARD 701321 FOR ADDITIONAL TRAFFIC CONTROL FEATURES

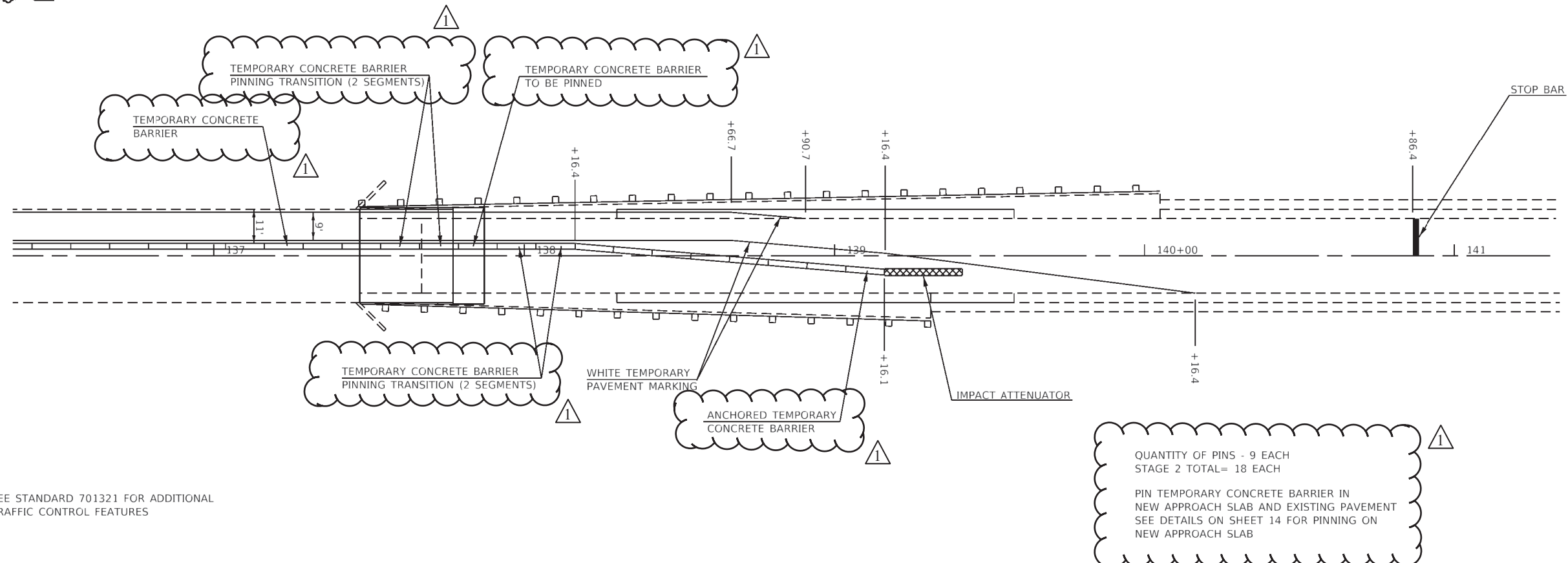

SEE STANDARD 701321 FOR ADDITIONAL TRAFFIC CONTROL FEATURES

1 REVISED 1-3-2023

MODEL - \$MODELNAME\$
FILE NAME - \$FILE\$

USER NAME = \$USERS	DESIGNED -	REVISED -
	DRAWN -	REVISED -
PLOT SCALE = \$SCALE\$	CHECKED -	REVISED -
PLOT DATE = \$DATE\$	DATE -	REVISED -

**STATE OF ILLINOIS
DEPARTMENT OF TRANSPORTATION**

**STAGE II TRAFFIC CONTROL
PLAN SHEET**

SCALE: SHEET 1 OF 1 SHEETS STA. TO STA.

F.A.P. RTE.	SECTION	COUNTY	TOTAL SHEETS	SHEET NO.
322	D7 BRIDGE REPAIR 2023-5	FAYETTE	23	11
CONTRACT NO. 74A91				
ILLINOIS FED. AID PROJECT				