

STATE OF ILLINOIS  
DEPARTMENT OF TRANSPORTATION

F.A.I. RTE.	SECTION	COUNTY	TOTAL SHEETS	SHEET NO.
55, 72	D6 PATCHING 2023	SANGAMON	6	1
		ILLINOIS	CONTRACT NO. 72069	

FOR INDEX OF SHEETS, SEE SHEET NO. 2

# PROPOSED HIGHWAY PLANS

FAI ROUTE 55, 72 (I 55, 72)  
SECTION D6 PATCHING 2023

PAVEMENT PATCHING  
SANGAMON COUNTY

C-96-019-23

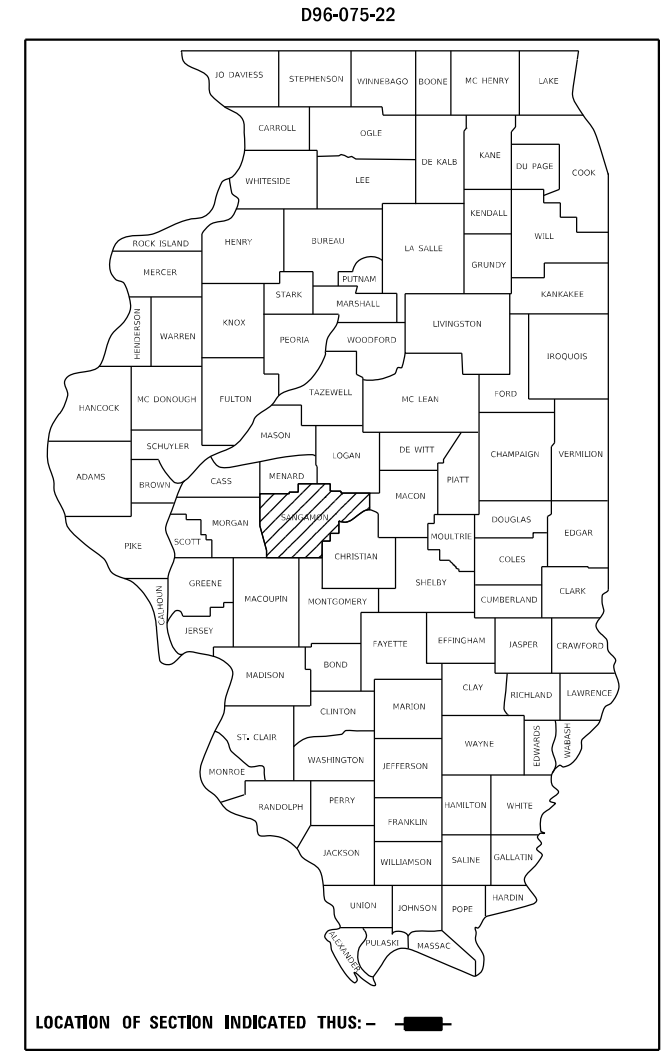

ADT = 27,100  
SU = 800  
MU = 5,500

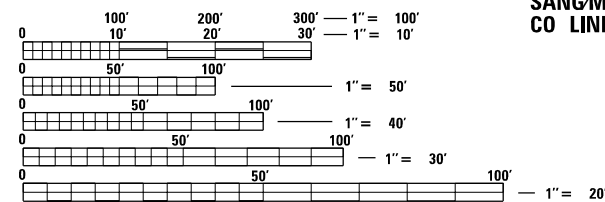

FULL SIZE PLANS HAVE BEEN PREPARED USING STANDARD ENGINEERING SCALES. REDUCED SIZED PLANS WILL NOT CONFORM TO STANDARD SCALES. IN MAKING MEASUREMENTS ON REDUCED PLANS, THE ABOVE SCALES MAY BE USED.

J.U.L.I.E.  
JOINT UTILITY LOCATION INFORMATION FOR EXCAVATORS  
1-800-892-0123  
OR 811

PROJECT ENGINEER: MIKE HAMBY (217)524-7765  
PROJECT MANAGER TIM SHARP (217)524-9160

CONTRACT NO. 72069

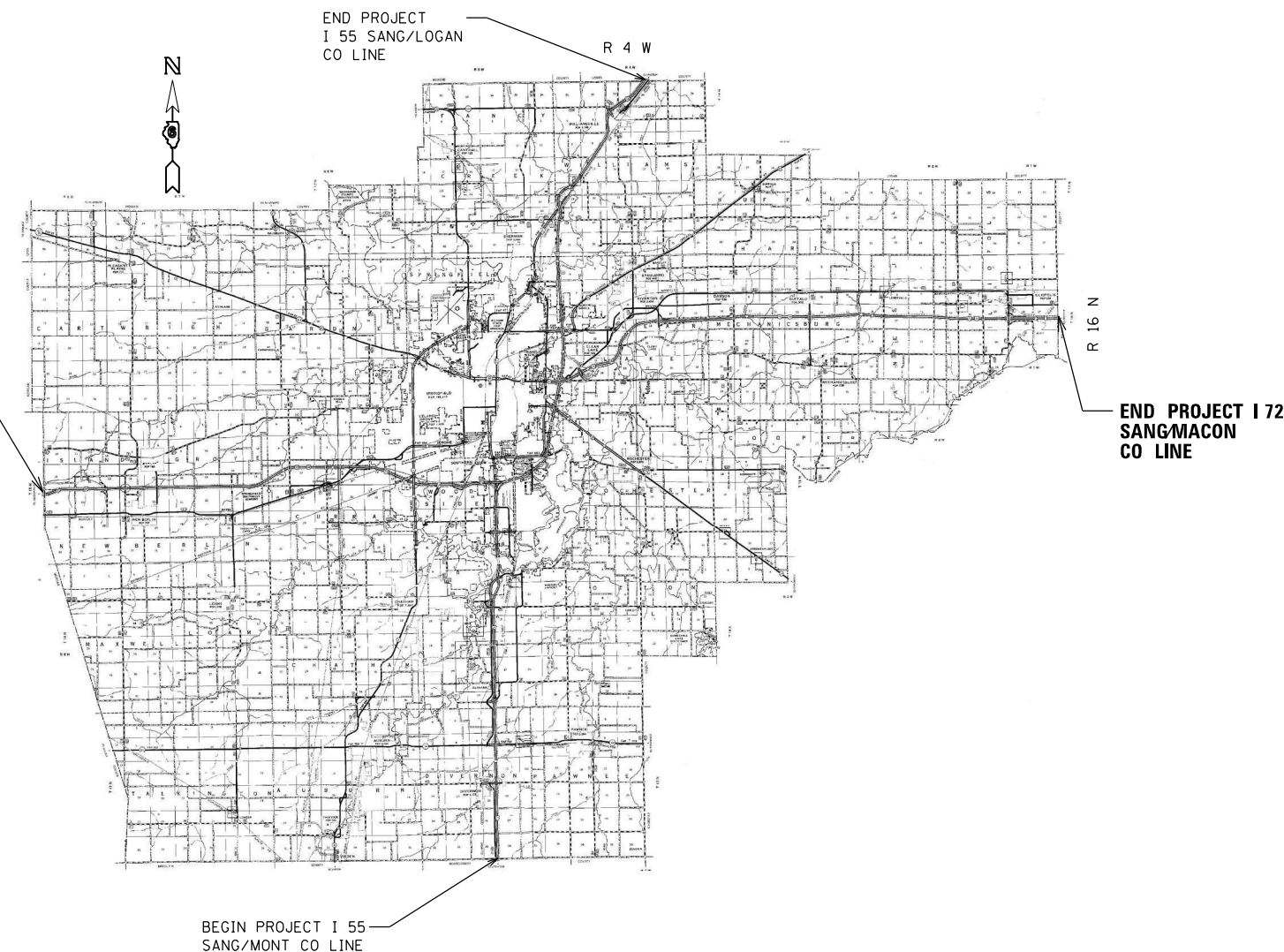

STATE OF ILLINOIS  
DEPARTMENT OF TRANSPORTATION

SUBMITTED October 27, 2022

*John P. Meyer*  
REGIONAL ENGINEER  
December 9, 2022

*Steph M. Spauld*  
ENGINEER OF DESIGN AND ENVIRONMENT  
December 9, 2022  
DIRECTOR OF HIGHWAYS PROJECT IMPLEMENTATION



PRINTED BY THE AUTHORITY  
OF THE STATE OF ILLINOIS

**INDEX OF SHEETS**

SHEET NO.	DESCRIPTION
1.	COVER SHEET
2.	INDEX OF SHEETS, STANDARDS, GENERAL NOTES & SIGNATURE
3.	SUMMARY OF QUANTITIES
4.	PATCHING SCHEDULE
5.	PROJECT LOCATION MAP
6.	PROJECT TYPICAL SECTIONS

**STANDARDS**

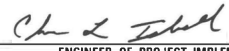
STANDARD NO.	DESCRIPTION
442001-04	CLASS A PATCHES
442101-09	CLASS B PATCHES
701101-05	OFF-RD OPERATIONS, MULTILANE, 15' TO 24" FROM EDGE OF PAVEMENT
701106-02	OFF-RD OPERATIONS, MULTILANE, MORE THAN 15" AWAY
701400-11	APPROACH TO LANE CLOSURE, FREEWAY/EXPRESSWAY
701401-13	LANE CLOSURE, FREEWAY/EXPRESSWAY
701411-09	LANE CLOSURE, MULTILANE AT ENTRANCE OR EXIT RAMP FOR SPEEDS $\geq$ 45 MPH
701446-11	TWO LANE CLOSURE, FREEWAY/EXPRESSWAY
701901-08	TRAFFIC CONTROL DEVICES
000001-08	STANDARD SYMBOLS, ABBREVIATIONS AND PATTERNS
001006	DECIMAL OF AN INCH AND OF A FOOT
420001-10	PAVEMENT JOINTS
420701-03	PAVEMENT WELDED WIRE REINFORCEMENT

<b>STATE OF ILLINOIS DEPARTMENT OF TRANSPORTATION DIVISION OF HIGHWAYS DISTRICT 6</b>	
EXAMINED	October 27, 2022
 ENGINEER OF OPERATIONS	
EXAMINED	October 27, 2022
 ENGINEER OF PROJECT IMPLEMENTATION	
EXAMINED	October 27, 2022
 ENGINEER OF PROGRAM DEVELOPMENT	

REV. - MS

FILE NAME =	USER NAME = Timothy.Sharp	DESIGNED -	REVISED -	<b>STATE OF ILLINOIS DEPARTMENT OF TRANSPORTATION</b>	<b>INDEX OF SHEETS, STANDARDS GENERAL NOTES, SIGNATURES</b>	F.A.I. RTE.	SECTION	COUNTY	TOTAL SHEETS	SHEET NO.
S:\CONTRMAINT.CAD\72069 - FAI 55,72 (15,72) - D6 PATCHING 2023 - Sangamon Co. (1-20-2022) - DMS gennote.dgn	CHECKED -	REVISED -	55, 72			D6 PATCHING 2023	SANGAMON	6	2	
Default	PLOT SCALE = 80.0000' / in.	DATE -	REVISED -			CONTRACT NO. 72069		ILLINOIS FED. AID PROJECT		

SCALE: \_\_\_\_\_ SHEET \_\_\_\_\_ OF \_\_\_\_\_ SHEETS STA. \_\_\_\_\_ TO STA. \_\_\_\_\_

0-02177-6022  
 100% STATE  
 SANGAMON  
 ROADWAY  
 0006  
 URBAN

CODE NO.	ITEM	UNIT	TOTAL QUANTITY	
44200050	WELDED WIRE REINFORCEMENT	SQ YD	23	23
44200577	CLASS A PATCHES, TYPE II, 12 INCH	SQ YD	8	8
44200610	CLASS A PATCHES, TYPE II, 13 INCH	SQ YD	599	599
44200612	CLASS A PATCHES, TYPE III, 13 INCH	SQ YD	55	55
44200614	CLASS A PATCHES, TYPE IV, 13 INCH	SQ YD	140	140
44200645	CLASS A PATCHES, TYPE II, 16 INCH	SQ YD	8	8
44201043	CLASS B PATCHES, TYPE II, 16 INCH	SQ YD	135	135
44201047	CLASS B PATCHES, TYPE III, 16 INCH	SQ YD	23	23
44201299	DOWEL BARS 1 1/2"	EACH	290	290
44213000	PATCHING REINFORCEMENT	SQ YD	810	810
44213200	SAW CUTS	FOOT	5,986	5,986
44213204	TIE BARS 3/4"	EACH	90	90
67100100	MOBILIZATION	L SUM	1	1
70100420	TRAFFIC CONTROL AND PROTECTION, STANDARD 701411	EACH	10	10
70100800	TRAFFIC OCONTROL AND PROTECTION, STANDARD 701401	L SUM	1	1
70100815	TRAFFIC OCONTROL AND PROTECTION, STANDARD 701446	L SUM	1	1
70107025	CHANGEABLE MESSAGE SIGN	CAL DAY	60	60
70200100	NIGHTTIME WORK ZONE LIGHTING	L SUM	1	1

MODEL: D:\dtp\h...  
 FILE NAME: S:\CONTRACTMAINT\_CADD\72069 - FAI 55.72 (I 55.72) - D6 PATCHING 2023 - Sangamon Co. (1-20-2023)\plans\72069-hh-3-500.dgn

USER NAME = Timothy,Sharp	DESIGNED - _____	REVISED - _____
PLOT SCALE = 2,0000 ' / in.	CHECKED - _____	REVISED - _____
PLOT DATE = 10/27/2022	DATE - _____	REVISED - _____

**STATE OF ILLINOIS  
 DEPARTMENT OF TRANSPORTATION**

**SUMMARY OF QUANTITIES**

SCALE: \_\_\_\_\_ SHEET \_\_\_ OF \_\_\_ SHEETS STA. \_\_\_\_\_ TO STA. \_\_\_\_\_

F.A.I. RTE.	SECTION	COUNTY	TOTAL SHEETS	SHEET NO.
55.72	D6 PATCHING 2023	SANGAMON	6	3
			CONTRACT NO. 72069	
			ILLINOIS FED. AID PROJECT	

MILE	LANE	LENGTH	WIDTH	AREA	CLASS A, 12 INCH				CLASS A, 13 INCH				CLASS A, 16 INCH		SAW CUTS	TIE BARS 3/4"	DOWEL BARS 1 1/2"	PATCHING REINF.	WELDED WIRE REINF.
					TY II	TY II	TY III	TY IV	TY II	TY II	TY II	TY III							
					(S.Y.)	(S.Y.)	(S.Y.)	(S.Y.)	(S.Y.)	(S.Y.)	(S.Y.)	(S.Y.)							
MARKER	DU/ML/PL	(FT)	(FT)	(S.Y.)	(S.Y.)	(S.Y.)	(S.Y.)	(S.Y.)	(S.Y.)	(S.Y.)	(S.Y.)	(S.Y.)	(S.Y.)	(S.Y.)	(EA)	(EA)	(S.Y.)	(S.Y.)	
<b>I-55 NORTHBOUND - SANGAMON COUNTY</b>																			
77.1	SANGAMON/MONTGOMERY COUNTY LINE																		
80.2	DIVERNON OVERHEAD																		
81.7	STRUCTURE 084-0110 (OVER IL 104)																		
82.0	BEGIN 3 LANES																		
82.5	STRUCTURE 084-0107																		
83.5	OLD ROUTE 66 OVERHEAD (GLENARM EXIT)																		
84.5	STRUCTURE 084-0113																		
85.7	PULLIAM ROAD OVERHEAD																		
87.3	NEW CITY ROAD OVERHEAD																		
88.5	EAST LAKE DRIVE OVERHEAD (CHATHAM EXIT)																		
89.2	LAKE SPRINGFIELD BRIDGE																		
92.7	EXIT 98 (I-72/CLEAR LAKE AVE.)																		
99.2	RIDGLEY AVENUE OVERHEAD																		
99.8	EXIT 100 (IL 54/SANGAMON AVE.)																		
100.7	BISSELL ROAD OVERHEAD																		
100.8	DL	6	12	8.0	--	--	--	--	--	8.0	--	66.0	--	20	--	--	--	--	
101.1	DL	8	6	5.3	--	--	--	--	--	5.3	--	48.0	--	10	--	--	--	--	
101.3	CROSSOVER																		
101.4	DL	6	12	8.0	--	--	--	--	--	8.0	--	66.0	--	20	--	--	--	--	
101.6	PL	6	12	8.0	--	--	--	--	--	8.0	--	66.0	--	20	--	--	--	--	
102.2	NORTHBOUND REST AREA																		
102.4	SN 084-0018 (SANGAMON RIVER)																		
103.8	DL	8	12	8.0	--	--	--	--	--	8.0	--	66.0	--	20	--	--	--	--	
104.0	DL	8	12	10.7	--	--	--	--	--	10.7	--	72.0	--	20	--	--	--	--	
104.2	ANDREW ROAD (CH 1) OVERHEAD																		
104.1	DL	10	12	13.3	--	--	--	--	--	13.3	--	78.0	--	20	--	--	--	--	
104.1	DL	10	12	13.3	--	--	--	--	--	13.3	--	78.0	--	20	--	--	--	--	
104.3	CROSSOVER																		
104.8	EXIT 105 (BUS. 55/SHERMAN)																		
105.3	SUDDUTH ROAD OVERHEAD																		
106.0	DL	6	12	8.0	--	8.0	--	--	--	--	--	60.0	--	--	8.0	--	--	--	
106.0	BEGIN 3 LANES																		
106.2	DL	70	6	46.7	--	--	--	46.7	--	--	--	164.0	23	--	46.7	--	--	--	
106.2	CROSSOVER																		
106.2	DL	30	6	20.0	--	--	20.0	--	--	--	--	84.0	9	--	20.0	--	--	--	
106.3	DL	8	6	5.3	--	5.3	--	--	--	--	--	40.0	--	--	5.3	--	--	--	
106.5	DL	8	6	5.3	--	5.3	--	--	--	--	--	40.0	--	--	5.3	--	--	--	
106.5	DL	60	6	40.0	--	--	40.0	--	--	--	--	144.0	19	--	40.0	--	--	--	
106.5	DL	8	6	5.3	--	5.3	--	--	--	--	--	40.0	--	--	5.3	--	--	--	
106.5	DL	8	6	5.3	--	5.3	--	--	--	--	--	40.0	--	--	5.3	--	--	--	
106.6	DL	17	6	11.3	--	11.3	--	--	--	--	--	58.0	--	--	11.3	--	--	--	
106.7	DL	15	6	10.0	--	10.0	--	--	--	--	--	54.0	--	--	10.0	--	--	--	
106.7	DL	8	6	5.3	--	5.3	--	--	--	--	--	40.0	--	--	5.3	--	--	--	
106.8	DL	8	6	5.3	--	5.3	--	--	--	--	--	40.0	--	--	5.3	--	--	--	
106.8	DL	8	6	5.3	--	5.3	--	--	--	--	--	40.0	--	--	5.3	--	--	--	
106.8	DL	10	6	6.7	--	6.7	--	--	--	--	--	44.0	--	--	6.7	--	--	--	
106.9	DL	8	6	5.3	--	5.3	--	--	--	--	--	40.0	--	--	5.3	--	--	--	
107.1	DL	22	6	14.7	--	14.7	--	--	--	--	--	68.0	7	--	14.7	--	--	--	
107.1	DL	8	6	5.3	--	5.3	--	--	--	--	--	40.0	--	--	5.3	--	--	--	
107.1	DL	8	6	5.3	--	5.3	--	--	--	--	--	40.0	--	--	5.3	--	--	--	
107.1	DL	15	6	10.0	--	10.0	--	--	--	--	--	54.0	--	--	10.0	--	--	--	
107.3	DL	8	6	5.3	--	5.3	--	--	--	--	--	40.0	--	--	5.3	--	--	--	
107.3	DL	8	6	5.3	--	5.3	--	--	--	--	--	40.0	--	--	5.3	--	--	--	
107.3	DL	8	6	5.3	--	5.3	--	--	--	--	--	40.0	--	--	5.3	--	--	--	
107.4	DL	15	6	10.0	--	10.0	--	--	--	--	--	54.0	--	--	10.0	--	--	--	
107.4	DL	23	6	15.3	--	15.3	--	--	--	--	--	70.0	7	--	15.3	--	--	--	
107.5	DL	8	6	5.3	--	5.3	--	--	--	--	--	40.0	--	--	5.3	--	--	--	
107.6	DL	10	6	6.7	--	6.7	--	--	--	--	--	44.0	--	--	6.7	--	--	--	
107.6	DL	8	6	5.3	--	5.3	--	--	--	--	--	40.0	--	--	5.3	--	--	--	
107.6	DL	8	6	5.3	--	5.3	--	--	--	--	--	40.0	--	--	5.3	--	--	--	
107.7	DL	8	6	5.3	--	5.3	--	--	--	--	--	40.0	--	--	5.3	--	--	--	
107.7	DL	40	12	53.3	--	--	53.3	--	--	--	--	128.0	13	--	53.3	--	--	--	
107.7	DL	20	6	13.3	--	13.3	--	--	--	--	--	64.0	6	--	13.3	--	--	--	
107.7	DL	8	6	5.3	--	5.3	--	--	--	--	--	40.0	--	--	5.3	--	--	--	
107.7	DL	8	6	5.3	--	5.3	--	--	--	--	--	40.0	--	--	5.3	--	--	--	
107.7	DL	8	6	5.3	--	5.3	--	--	--	--	--	40.0	--	--	5.3	--	--	--	
107.7	DL	8	6	5.3	--	5.3	--	--	--	--	--	40.0	--	--	5.3	--	--	--	
107.7	DL	8	6	5.3	--	5.3	--	--	--	--	--	40.0	--	--	5.3	--	--	--	
107.7	DL	8	6	5.3	--	5.3	--	--	--	--	--	40.0	--	--	5.3	--	--	--	
107.7	DL	8	6	5.3	--	5.3	--	--	--	--	--	40.0	--	--	5.3	--	--	--	
107.9	DL	8	6	5.3	--	5.3	--	--	--	--	--	40.0	--	--	5.3	--	--	--	
107.9	DL	6	12	8.0	--	8.0	--	--	--	--	--	60.0	--	--	8.0	--	--	--	
108.0	DL	10	6	6.7	--	6.7	--	--	--	--	--	44.0	--	--	6.7	--	--	--	
108.2	DL	8	6	5.3	--	5.3	--	--	--	--	--	40.0	--	--	5.3	--	--	--	
108.6	DL	9	6	6.0	--	6.0	--	--	--	--	--	42.0	--	--	6.0	--	--	--	
108.9	DL	8	6	5.3	--	5.3	--	--	--	--	--	40.0	--	--	5.3	--	--	--	
108.9	DL	8	6	5.3	--	5.3	--	--	--	--	--	40.0	--	--	5.3	--	--	--	
109.0	DL	8	6	5.3	--	5.3	--	--	--	--	--	40.0	--	--	5.3	--	--	--	
109.0	DL	8	6	5.3	--	5.3	--	--	--	--	--	40.0	--	--	5.3	--	--	--	
109.0	DL	8	6	5.3	--	5.3	--	--	--	--	--	40.0	--	--	5.3	--	--	--	
109.1	DL	8	6	5.3	--	5.3	--	--	--	--	--	40.0	--	--	5.3	--	--	--	
109.1	DL	8	6	5.3	--	5.3	--	--	--	--	--	40.0	--	--	5.3	--	--	--	
109.2	EXIT 109 (IL 123/WILLIAMSVILLE)																		
109.2	DL	8	8	7.1	--	7.1	--	--	--	--	--	48.0	--	--	7.1	--	--	--	
109.2	DL	8	6	5.3	--	5.3	--	--	--	--	--	40.0	--	--	5.3	--	--	--	
109.2	DL	20	6	13.3	--	13.3	--	--	--	--	--	64.0	6	--	13.3	--	--	--	
109.5	DL	6	12	8.0	--	8.0	--	--	--	--	--	60.0	--	--	8.0	--	--	--	
109.6	DL	6	12	8.0	--	8.0	--	--	--	--	--	60.0	--	--	8.0	--	--	--	
109.6	DL	6	12	8.0	--	8.0	--	--	--	--	--	60.0	--	--	8.0	--	--	--	
110.0	DL	8	12	10.7	--	10.7	--	--	--	--	--	64.0	--	--	10.7	--	--	--	
110.3	DL	10	6	6.7	--	6.7	--	--	--	--	--	44.0	--	--	6.7	--	--	--	
110.3	DL	8	6	5.3	--	5.3	--	--	--	--	--	40.0	--	--	5.3	--	--	--	
111.1	LOGAN - SANGAMON COUNTY LINE																		

MILE	LANE	LENGTH	WIDTH	AREA	CLASS A, 12 INCH				CLASS A, 13 INCH				CLASS A, 16 INCH		SAW CUTS	TIE BARS 3/4"	DOWEL BARS 1 1/2"	PATCHING REINF.	WELDED WIRE REINF.
					TY II	TY II	TY III	TY IV	TY II	TY II	TY III								
					(S.Y.)	(S.Y.)	(S.Y.)	(S.Y.)	(S.Y.)	(S.Y.)	(S.Y.)								
MARKER	DU/ML/PL	(FT)	(FT)	(S.Y.)	(S.Y.)	(S.Y.)	(S.Y.)	(S.Y.)	(S.Y.)	(S.Y.)	(S.Y.)	(S.Y.)	(S.Y.)	(S.Y.)	(EA)	(EA)	(S.Y.)	(S.Y.)	
<b>I-55 SOUTHBOUND -- SANGAMON COUNTY</b>																			
111.1	LOGAN - SANGAMON COUNTY LINE																		
110.7	DL	8	6	5.3	--	5.3	--	--	--	--	--	40.0	--	--	5.3	--	--	--	
109.5	ML	8	6	5.3	--	5.3	--	--	--	--	--	40.0	--	--	5.3	--	--	--	
108.4	EXIT 109 (IL 123/WILLIAMSVILLE)																		
108.9	DL	6	12	8.0	--	8.0	--	--	--	--	--	60.0	--	--	8.0	--	--	--	
108.8	DL	8	6	5.3	--	5.3	--	--	--	--	--	40.0	--	--	5.3	--	--	--	
108.7																			

END PROJECT ON I-55  
SANG/LOGAN CO LINE

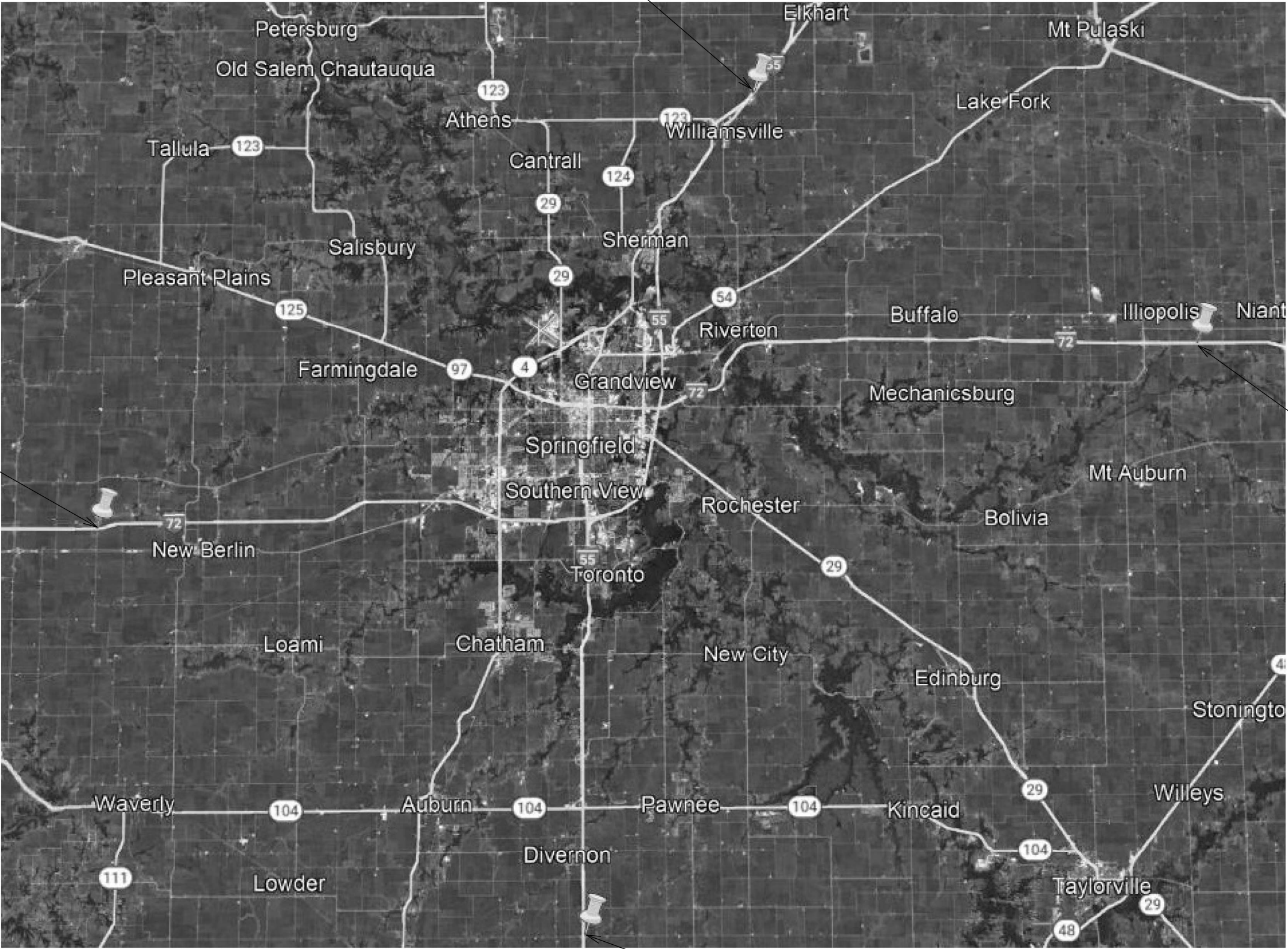

BEGIN PROJECT  
ON I-72  
SANG/MORGAN  
CO LINE

END PROJECT  
ON I-72  
SANG/MACON  
CO LINE

BEGIN PROJECT ON I-55  
SANG/MONT CO. LINE

MODEL: D:\p1\p1\CONTRMNT\_CAD\72069 - FAI 55.72 - D6 PATCHING 2023 - Sangamon Co. (1-20-2023)\plans\72069-pts-5-plans.dgn  
 FILE NAME: S:\CONTRMNT\_CAD\72069 - FAI 55.72 (I 55.72) - D6 PATCHING 2023 - Sangamon Co. (1-20-2023)\plans\72069-pts-5-plans.dgn

USER NAME = Timothy,Sharp	DESIGNED - _____	REVISED - _____
DRAWN - _____	REVISIONS - _____	REVISIONS - _____
PLOT SCALE = 2,000' / in.	CHECKED - _____	REVISIONS - _____
PLOT DATE = 10/27/2022	DATE - _____	REVISIONS - _____

**STATE OF ILLINOIS  
DEPARTMENT OF TRANSPORTATION**

<b>PLAN</b>	
SCALE: _____	SHEET ____ OF ____ SHEETS STA. _____ TO STA. _____

F.A.I. RTE.	SECTION	COUNTY	TOTAL SHEETS	SHEET NO.
55, 72	D6 PATCHING 2023	SANGAMON	6	5
CONTRACT NO. 72069				
ILLINOIS FED. AID PROJECT				



MODEL: D:\p\h\l...  
 FILE NAME: S:\CONTRACTMAINT\_CADD\72069 - FAI 55.72 - D6 PATCHING 2023 - Sangamon Co. (1-20-2023)\plans\72069-sh-6-cyp\clic.dgn

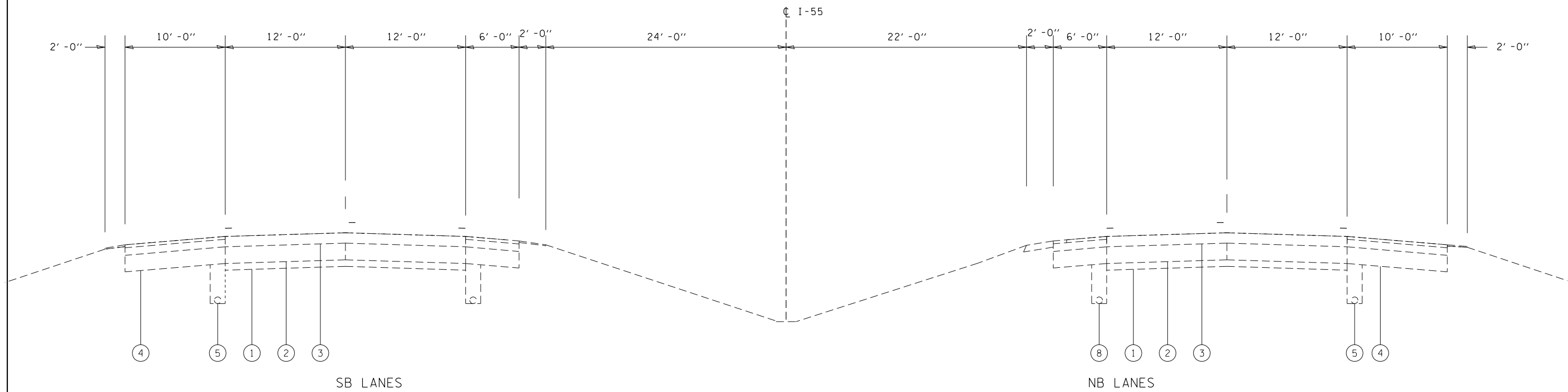

FAI 55  
TWO LANE SECTION  
FAI 72

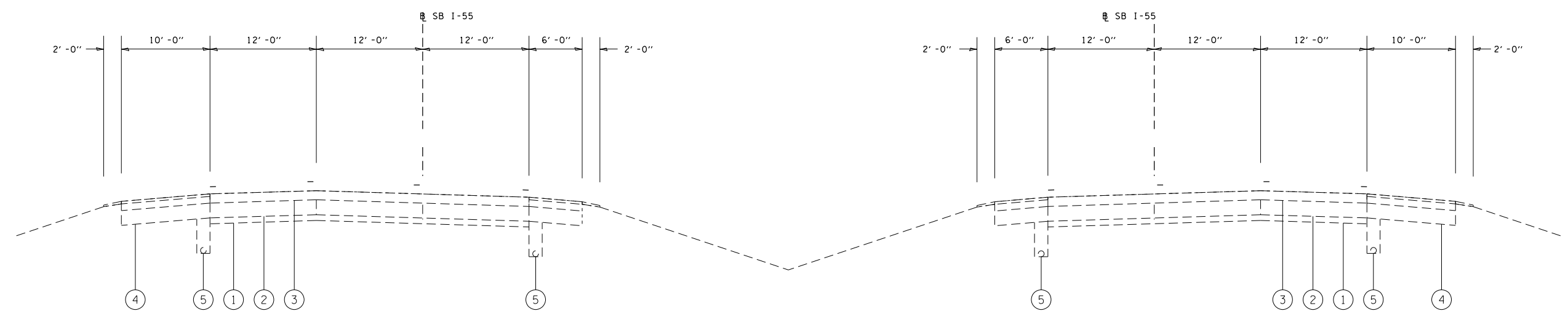

FAI 55  
THREE LANE SECTION

LEGEND

- ① EX AGGREGATE SUB-BASE 4"
- ② EX PCC PAVEMENT
- ③ EX HOT -MIX ASPHALT SURFACE COURSE (VARIABLE THICKNESS)
- ④ EX HOT-MIX ASPHALT SHOULDERS
- ⑤ EX PIPE UNDERDRAIN

USER NAME = Timothy,Sharp	DESIGNED - _____	REVISED - _____
PLOT SCALE = 5,0000' / in.	DRAWN - _____	REVISED - _____
PLOT DATE = 10/27/2022	CHECKED - _____	REVISED - _____
	DATE - _____	REVISED - _____

STATE OF ILLINOIS  
DEPARTMENT OF TRANSPORTATION

<b>TYPICALS</b>	
SCALE: _____	SHEET ____ OF ____ SHEETS
STA. _____	TO STA. _____

F.A.I. RTE.	SECTION	COUNTY	TOTAL SHEETS	SHEET NO.
55, 72	D6 PATCHING 2023	SANGAMON	6	6
CONTRACT NO. 72069				
ILLINOIS FED. AID PROJECT				