

PROPOSED IL ROUTE 159
STA. 674+31.00.00 TO STA. 684+92.00

DELETE

FROM

PROJECT

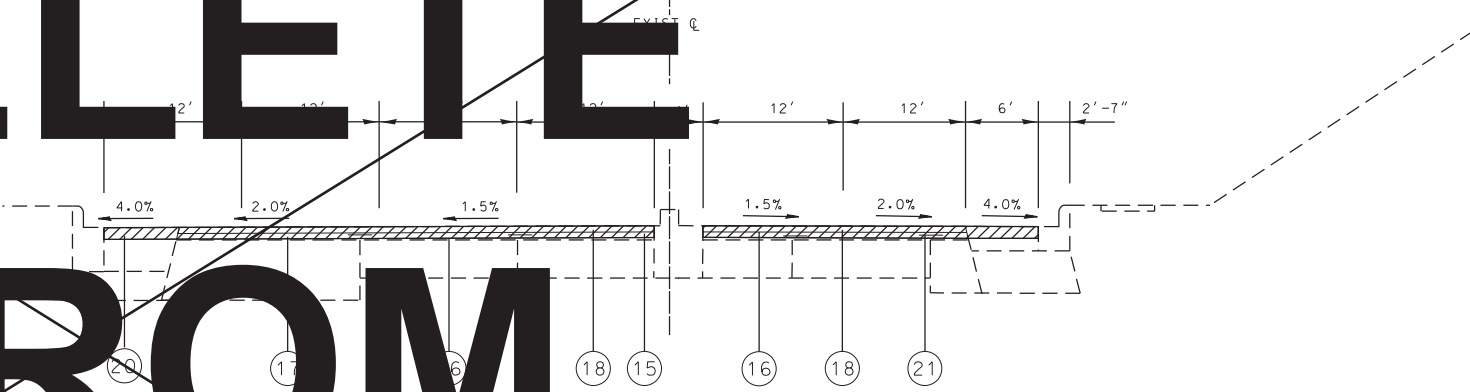

PROPOSED IL ROUTE 159
STA. 684+92.00 TO STA. 688+21.00

LEGEND

- ① EXISTING CONCRETE PAVEMENT-10"
 - ② EXISTING COMBINATION CONCRETE CURB AND GUTTER, TYPE B6-24
 - ③ EXISTING HMA RESURFACING-2'1/2" AND VARIES
 - ④ EXISTING CONCRETE MEDIAN
 - ⑤ EXISTING HMA WIDENING
 - ⑥ EXISTING SIDEWALK
 - ⑦ EXISTING ISLAND
 - ⑧ EXISTING HMA SHOULDER
 - ⑨ EXISTING AGGREGATE SHOULDER
 - ⑩ EXISTING GUTTER, TYPE B
 - ⑪ EXISTING SUBBASE
 - ⑫ EXISTING HMA BINDER COURSE-11 3/4" AND VARIES
 - ⑬ EXISTING PIPE UNDERDRAINS 4"
 - ⑭ EXISTING FULL DEPTH HMA PAVEMENT
 - ⑮ PROPOSED HMA SURFACE REMOVAL -2 3/4"
 - ⑯ PROPOSED BITUMINOUS MATERIALS (TACK COAT)
 - ⑰ PROPOSED HMA BINDER CSE, IL-9.5FG, N70-1 1/4"
 - ⑱ PROPOSED HMA SURFACE COURSE, IL-9.5, MIX"D", N70-1 1/2"
 - ⑲ PROPOSED AGGREGATE SHOULDER, TYPE B
 - ⑳ PROPOSED HMA SHOULDER -2 3/4"
 - ㉑ PROPOSED HMA SURFACE REMOVAL -2"
 - ㉒ PROPOSED INCIDENTAL HMA SURFACING-2"
- PROPOSED LONGITUDINAL JOINT SEALANT TO BE USED THROUGHOUT THE LIMITS OF THE PROJECT

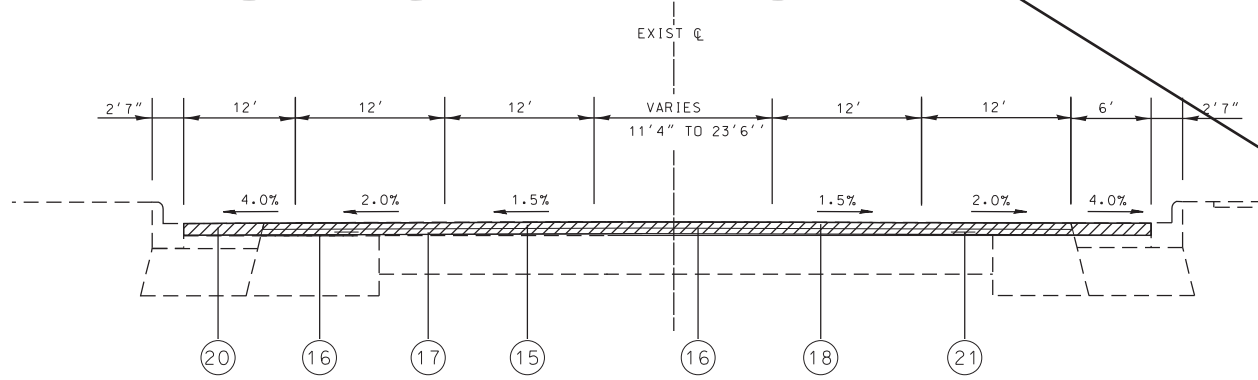

PROPOSED IL ROUTE 159
STA. 688+21.00 TO STA. 691+03.00

REVISI REVISION SYMBOL 1-5-2023

MODEL: \\MODEL\MMF5... FILE: \\MMF5... \\\\c:\programdata\autodesk\lisp\autocad\lisp\acad\lisp\acadtbl.dwg

USER NAME = eolison.zohfonyi DRAWN - PLOT SCALE = 100.0000' / in. PLOT DATE = 10/26/2022	DESIGNED - CHECKED - DATE -	REVISED - REVISED - REVISED - REVISED -	STATE OF ILLINOIS DEPARTMENT OF TRANSPORTATION	PROPOSED TYPICALS			F.A.P/U RTE. + (122,122-1,30)RS-4 *600/8887	SECTION COUNTY MADISON	TOTAL SHEETS 328	SHEET NO. 17A	CONTRACT NO. 76M87
				SCALE: NONE	SHEET 11 OF 18 SHEETS	STA. TO STA.					

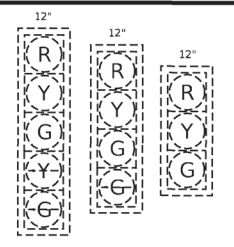
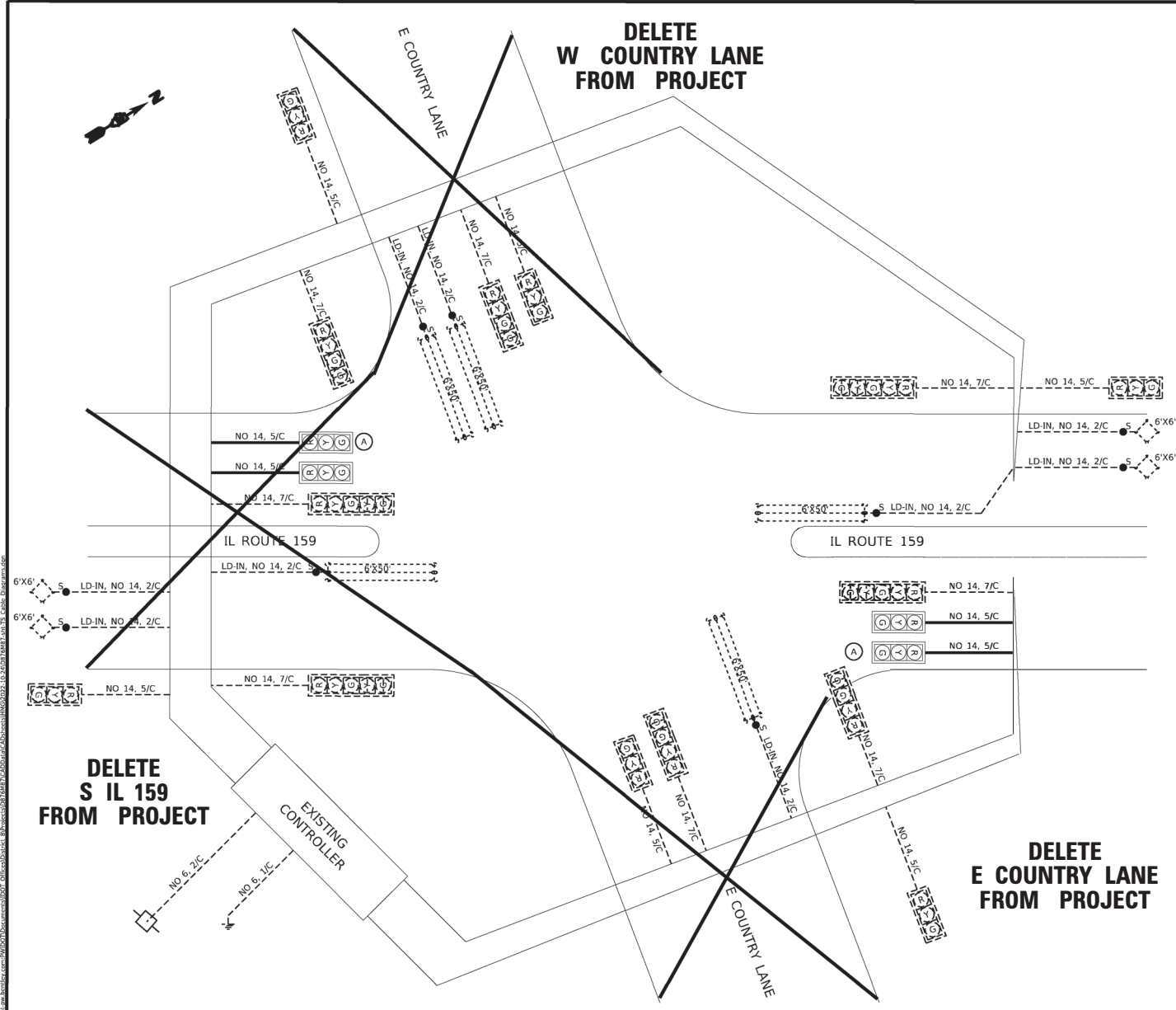

EXISTING TRAFFIC SIGNAL FACES

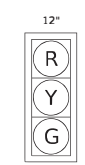

PROPOSED TRAFFIC SIGNAL FACES

(A) EXISTING SIGNAL HEAD AND BACK PLATE TO BE RELOCATED

CABLE DIAGRAM LEGEND

- PROPOSED ELECTRIC CABLE IN CONDUIT
- 2/C INDICATES NUMBER OF CONDUCTORS IN CABLE
- NO. 6 INDICATES AMERICAN WIRE (AWG) SIZE 6
- - - EXISTING ELECTRIC CABLE IN CONDUIT
- EXISTING PEDESTRIAN PUSH BUTTON
- EXISTING SERVICE INSTALLATION
- S CABLE SPLICE

⚠ REVISION 1-5-2023

⚠

MODEL: P:\CADD\PLANS\...
FILE NAME: ...

USER NAME = Default	DESIGNED -	REVISED - AMM-102622
	DRAWN -	REVISED -
PLOT SCALE = 15.4545' / in.	CHECKED -	REVISED -
PLOT DATE = 10/26/2022	DATE -	REVISED -

**STATE OF ILLINOIS
DEPARTMENT OF TRANSPORTATION**

CABLE DIAGRAM	
IL ROUTE 159 & E COUNTRY LANE	
SCALE: NTS	SHEET TS 19 OF 31 SHEETS STA. TO STA.

F.A.P. NO. 600	SECTION (122.122-1.30)RS-4	COUNTY MADISON	TOTAL SHEETS 328	SHEET NO. 253
				CONTRACT NO. 76MB7
ILLINOIS FED. AID PROJECT				