

F.A.P. RTE. NO.	SECTION NUMBER	COUNTY	NO. SHEETS	SHEET NO.
796	21-00028-03-RS	Kankakee	3	1
PROJECT S7HV (364)				

01-20-2023 LETTING ITEM 070
INDEX OF SHEETS

STATE OF ILLINOIS DEPARTMENT OF TRANSPORTATION

PLANS FOR A PROPOSED FEDERAL AID HIGHWAY RESURFACING F.A.P. 796 (CH.18) STR & COVID Funds SECTION 21-00028-03-RS PROJECT NUMBER S7HV (364) KANKAKEE COUNTY C-93-012-23

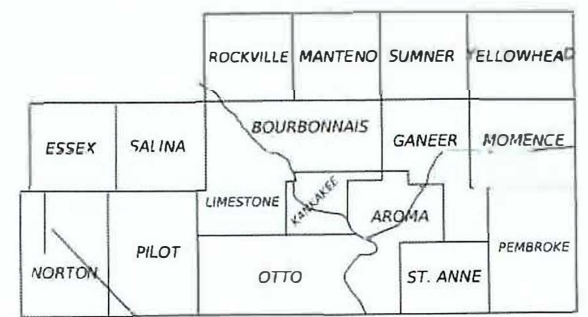

PROJECT LOCATION

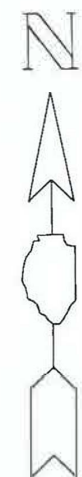

THE ACCEPTANCE OF THIS PROJECT IS BASED ON THE MINIMUM DESIGN CRITERIA FOR LOCAL AGENCY FUNCTIONAL OVERLAY POLICY (LAFO) PROJECTS

CLASS III ROADWAY
CURRENT 2022 ADT = 855
DESIGN 2042 ADT = 950
DESIGN SPEED = 55 M.P.H.

Sheet No.	Description
1	COVER SHEET
2	TYPICAL CROSS SECTION AND DETAILS
3	DETAIL

STANDARDS

- 000001 - 08 STANDARD SYMBOLS ,ABBREVIATIONS AND PATTERNS
- 701301 - 04 LANE CLOSURE 2L2W - SHORT TIME OPERATION
- 701306 - 04 LANE CLOSURE 2L2W SLOW MOVING OP ONE DAY ONLY >45 MPH
- 701901 - 08 TRAFFIC CONTROL DEVICES

SUMMARY OF QUANTITIES

40600370 LONGITUDINAL JOINT SEALANT	22137 FOOT
● 40600982 HOT-MIX ASPHALT SURFACE REMOVAL - BUTT JOINT	689 SQYD
40600990 TEMPORARY RAMP	68 SQ YD
● 40602965 HOT-MIX ASPHALT BINDER COURSE, IL-9.5FG, N50	3726 TON
● 40604000 HOT-MIX ASPHALT SURFACE COURSE, IL 9.5FG MIX "C", N50	4471 TON
● 40800029 BITUMINOUS MATERIALS (TACK COAT)	35155 POUND
● 40800050 INCIDENTAL HOT-MIX ASPHALT SURFACING	179 TON
● 48101200 AGGREGATE SHOULDERS, TYPE B	4661 TON
67100100 MOBILIZATION	1 L SUM
● 70100460 TRAFFIC CONTROL AND PROTECTION, STANDARD 701306	1 L SUM
● 70300100 SHORT TERM PAVEMENT MARKING	8858 FOOT
● Z0034105 MATERIAL TRANSFER DEVICE	8197 TON
Z0048665 RAILROAD PROTECTIVE LIABILITY INSURANCE	1 L SUM
● Special Provisions	Construction Code 0005

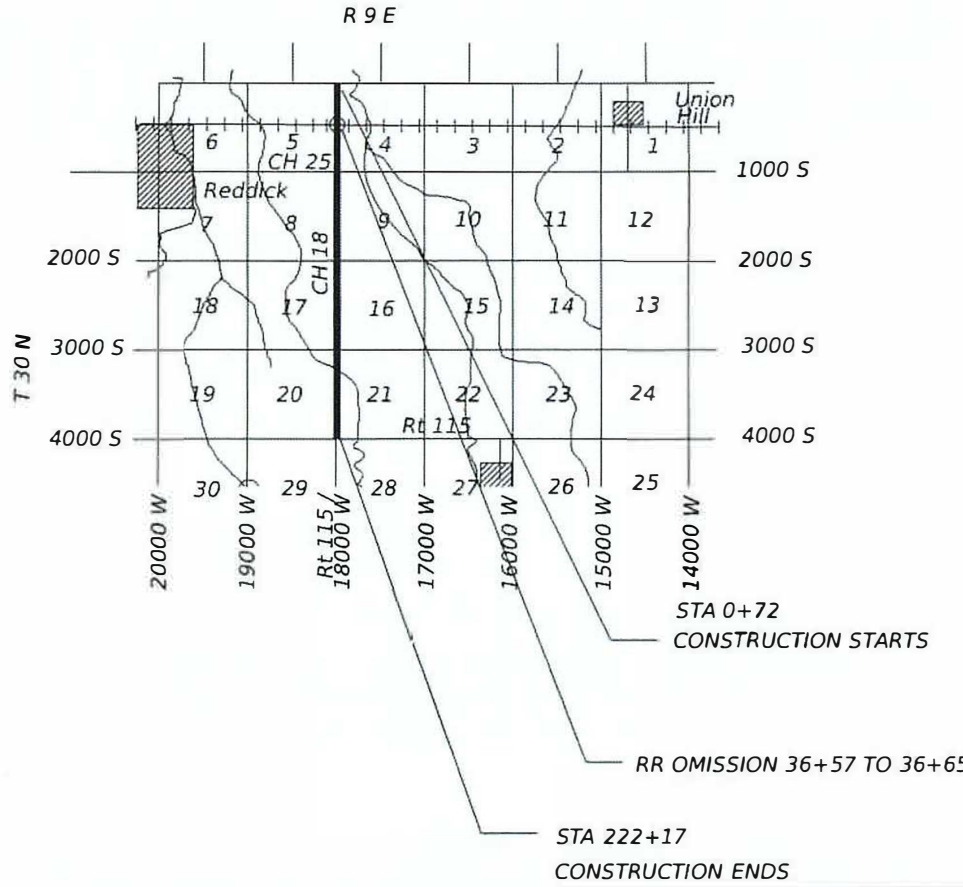

NET LENGTH = 22137 LIN. FT. = 4.19 MILES

PRINTED BY THE AUTHORITY
OF THE STATE OF ILLINOIS

CONTRACT NO. 87799

(J.U.L.I.E.) 1-800-892-0123

KANKAKEE COUNTY HIGHWAY DEPARTMENT

GREGORY HEIDEN
APPROVED
062-046886

2022

Greg Heiden

GREG HEIDEN P.E. KANKAKEE COUNTY ENGINEER

PASSED November 9, 2022

Steve Chery

STEVE CHERY P.E. DISTRICT B LOCAL ROADS & STREETS ENGINEER

RELEASING FOR BID
BASED ON LIMITED
REVIEW November 9, 2022

Paul Stumpe

REGION 2 ENGINEER

SECTION	COUNTY	TOTAL SHEETS	SHEET NO.
21-00028-03-RS	KANKAKEE	3	2

PROJECT # S7HV (364)
 JOB # C - 93 -012- 23
 C 87799

TYPICAL ENTRANCE DETAIL

W : WIDTH OF APPROACH PADS IS ESTIMATED AT 20' PER ENTRANCE . THE ACTUAL CONSTRUCTED WIDTH MAY VARY AS DIRECTED BY THE ENGINEER TO FIT EXISTING ENTRANCES .

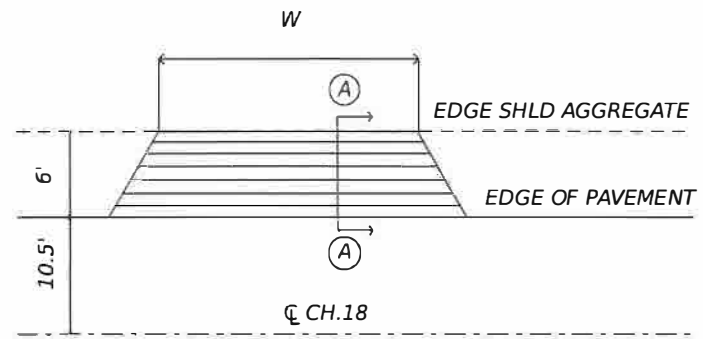

FIELD ENTRANCES SHALL NOT RECEIVE HMA SURFACING

Quantities are included in Incidental HMA total. Placement will be Machine Method using an approved road widener.

ESTIMATED QUANTITIES-7 ENTRANCES		
ITEM	UNIT	QUANTITY
BIT. MATERIALS (TACK COAT)	POUND	81
HMA SURFACE CSE. IL 9.5 FG MIX C , N50	TON	44

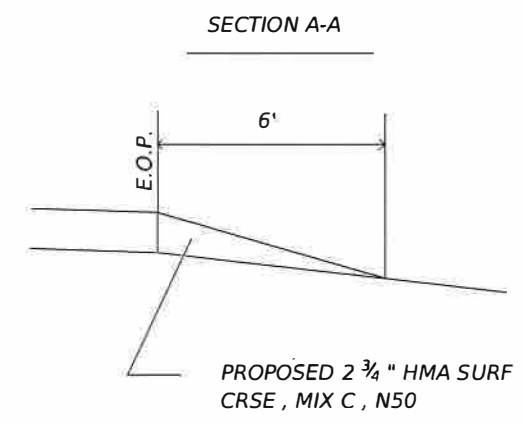

TYPICAL CROSS SECTION

STA 0+72 TO 222+17
 (RR OMISSION STA 36+57 TO 36+65)

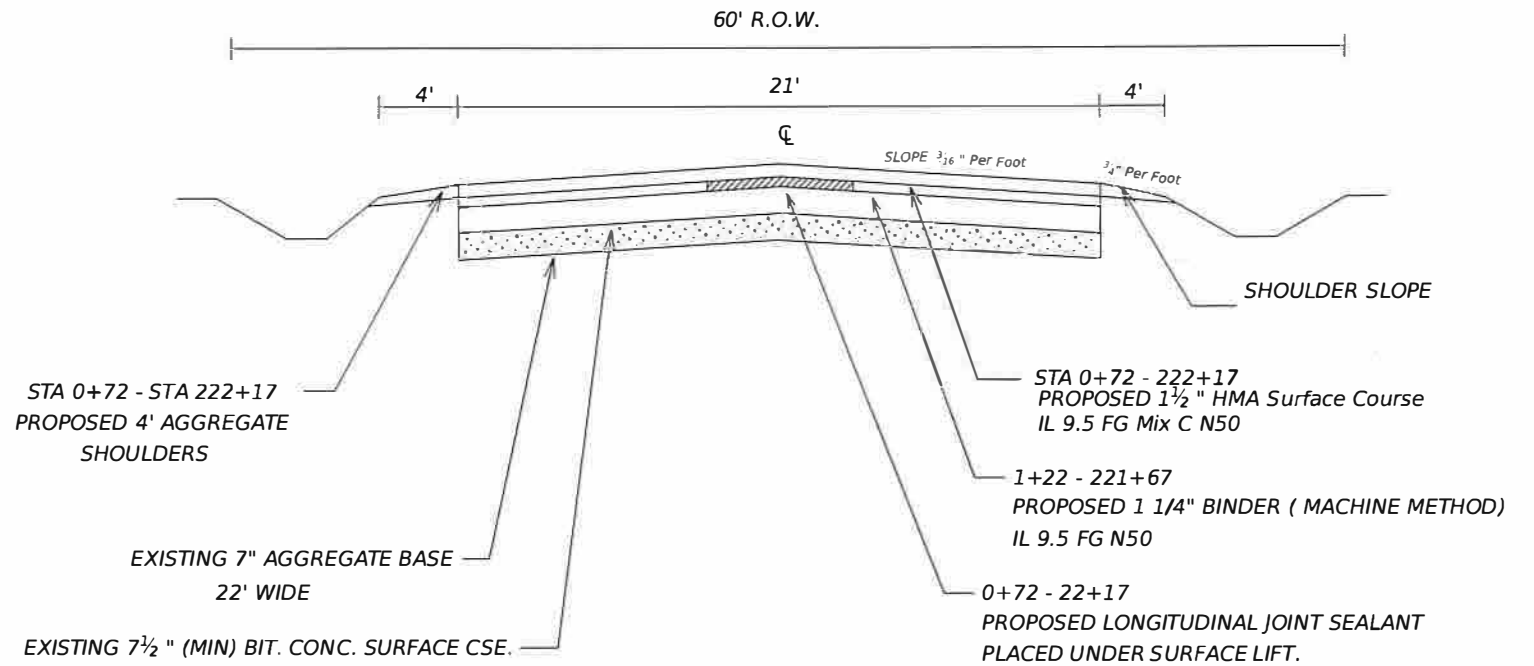

TYPICAL MAILBOX TURNOUT DETAIL

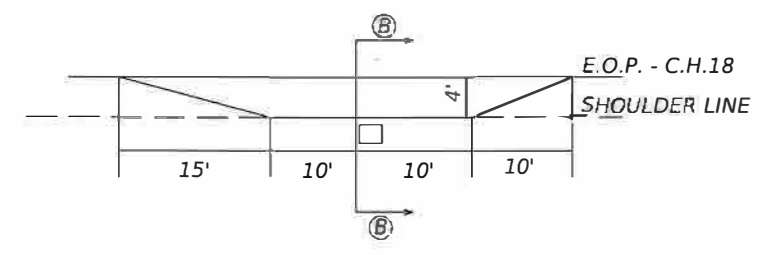

MAILBOX TURNOUT SCHEDULE	
STATION	SIDE
9+96	LT
73+38	LT
98+54	LT
99+90	LT
212+96	LT

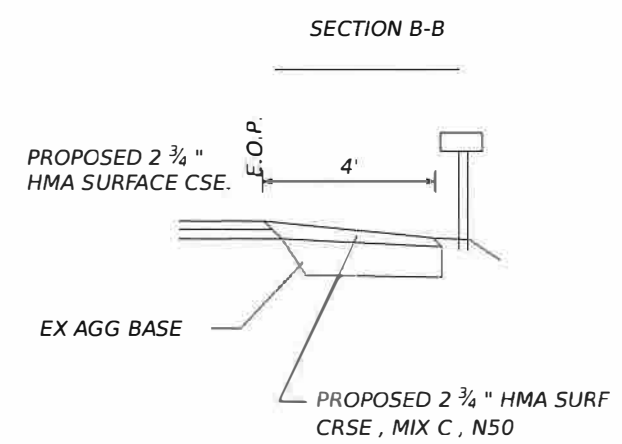

ESTIMATED QUANTITIES - 5 MAILBOX TURNOUTS		
ITEM	UNIT	QUANTITY
BIT. MATERIALS (TACK COAT)	POUND	40
HMA SURFACE CSE. IL 9.5 FG MIX C , N50	TON	25

Quantities are included in Incidental HMA total. Placement will be Machine Method using an approved road widener.

ESTIMATED QUANTITIES ON TANGENTS

ITEM	UNIT	QUANTITY
AGGREGATE SHOULDERS TY.B	TON	4661
BITUMINOUS MATERIALS (TACK COAT)	POUND	34878
BINDER (MM) IL 9.5 FG N50	TON	3726
HMA SURFACE COURSE IL 9.5 FG ,MIX C , N50	TON	4471
LONGITUDINAL JOINT SEALANT	FOOT	22137
SHORT TERM PAVEMENT MARKING	FOOT	8858
MATERIAL TRANSFER DEVICE	TON	8197

INTERSECTION DETAIL

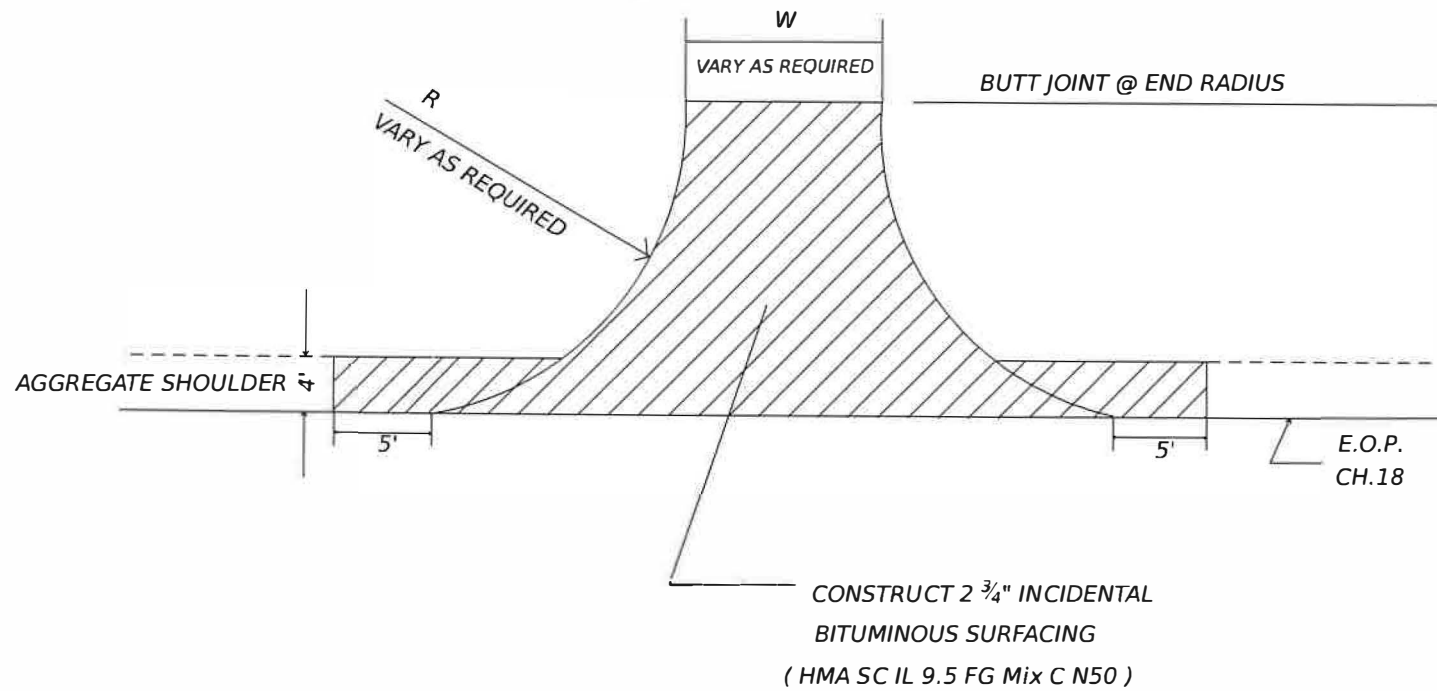

SECTION	COUNTY	TOTAL SHEETS	SHEET NO.
21-00028-03-RS	KANKAKEE	3	3

PROJECT # S7HV (364)
 JOB # C - 93 -012- 23
 C 87799

TYPICAL BUTT JOINT DETAIL

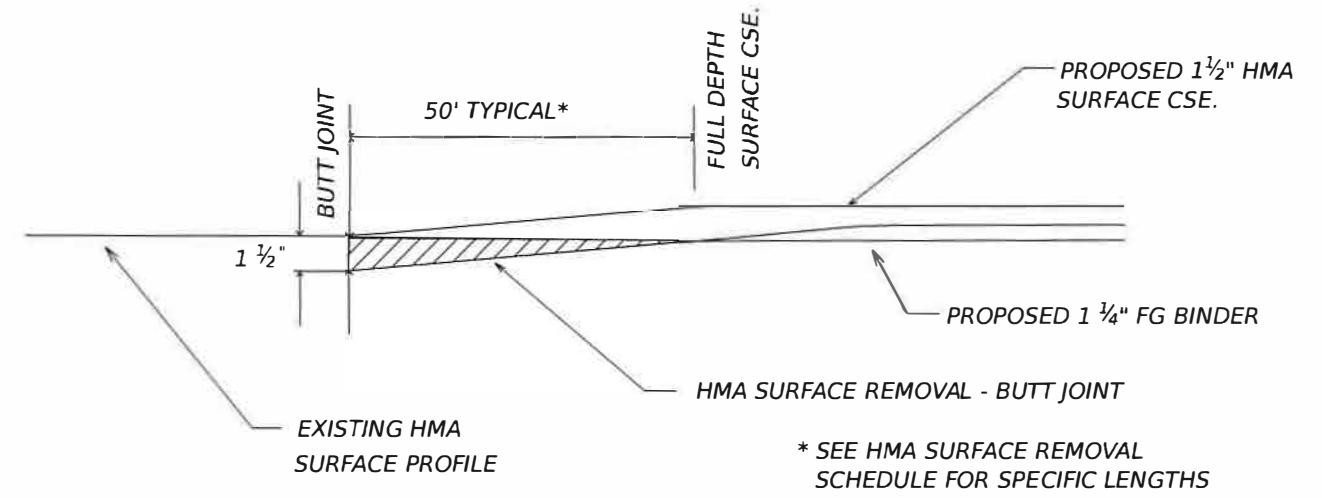

INTERSECTION QUANTITY SCHEDULE

LOCATION	STATION	SIDE	WIDTH	RADIUS	INCIDENTAL HMA SURFACING	BIT. MATRLS. (TACK COAT)
CO HWY 25 1000S	63+37	LT	22	30	20	29
CO HWY 25 1000S	63+37	RT	22	30	20	29
TWP RD 2000S	116+48	LT	18	30	15	20
TWP RD 2000S	116+48	RT	18	30	15	20
TWP RD 3000S	169+71	LT	20	30	20	29
TWP RD 3000S	169+71	RT	20	30	20	29
TOTALS					110 TONS	156 POUND

BITUMINOUS SURFACE REMOVAL & TEMPORARY RAMP SCHEDULE

STATION	BUTT JOINT SQUARE YARDS	TEMPORARY RAMP *** SQUARE YARDS	FEATURE
0+72	116	7	BUTT JOINT IL RTE. 17 *
36+57	116	7	BUTT JT. RR
36+65	116	7	BUTT JT. RR
63+37 (22'X30')	73	7	CO HWY 25 1000S RT
63+37 (22'X14')	34	7	TWP RD 1000S LT
116+48 (18'x14')	28	6	TWP RD 2000S RT
116+48 (18'x14')	28	6	TWP RD 2000S LT
169+71 (20'X14')	31	7	TWP RD 3000S RT
169+71 (20'X14')	31	7	TWP RD 3000S LT
221+77	116	7	BUTT JOINT IL RTE. 115 * *
TOTALS	689	68	

PAVEMENT DESIGN DATA

DESIGN PERIOD = 20 YEARS
 ADT 855 (2022) 950 (2042)
 PV 88% = 836 SU 7% = 67 MU 5% = 48
 TF 0.129
 SNf 3.35
 PAVEMENT STRUCTURE NUMBER
 Ex 7" TY B (CRUSHED) 7 X 0.08 = 0.56
 Ex 6" HMA BIT CL I SURFACE 6 X 0.23 = 1.38
 Ex 1.5" IL 9.5 HMA SURFACE 1.5 X 0.30 = 0.45
 2.39

* BUTT JOINT AT 60' SOUTH OF E.O.P. OF IL RTE 17
 ** BUTT JOINT AT NORTH END OF RADIUS OF IL RTE. 115
 *** TEMP RAMPS 3' WIDE ,FULL WIDTH