

TRAFFIC SIGNAL LEGEND

- CONTROLLER
- SERVICE INSTALLATION
- SIGNAL HEAD ("P" - PROGRAMMED)
- SIGNAL HEAD WITH BACKPLATE
- SIGNAL HEAD, PEDESTRIAN
- SIGNAL POST
- MAST ARM ASSEMBLY AND POLE, ALUMINUM HANDHOLE
- 6.S. CONDUIT IN TRENCH OR PUSHED
- PULL ELECTRIC CABLE FROM CONDUIT
- DETECTOR LOOP
- COMMON TRENCH
- MAGNETIC DETECTOR, TYPE I OR TYPE II
- DEMOTES NUMBER OF CONDUCTORS (NEW). ALL LOOP DETECTOR CABLE TO BE TWISTED, SHIELDED, ALL CABLE NO. 14 EXCEPT AS INDICATED.
- INDICATES EXISTING CABLE
- SIGNAL FACE WITH BACKPLATE
- "P" INDICATES PROGRAMMED

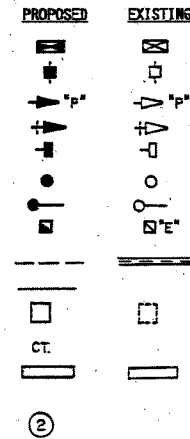

R
Y
G
G

EXISTING SIGNAL SECTION

R

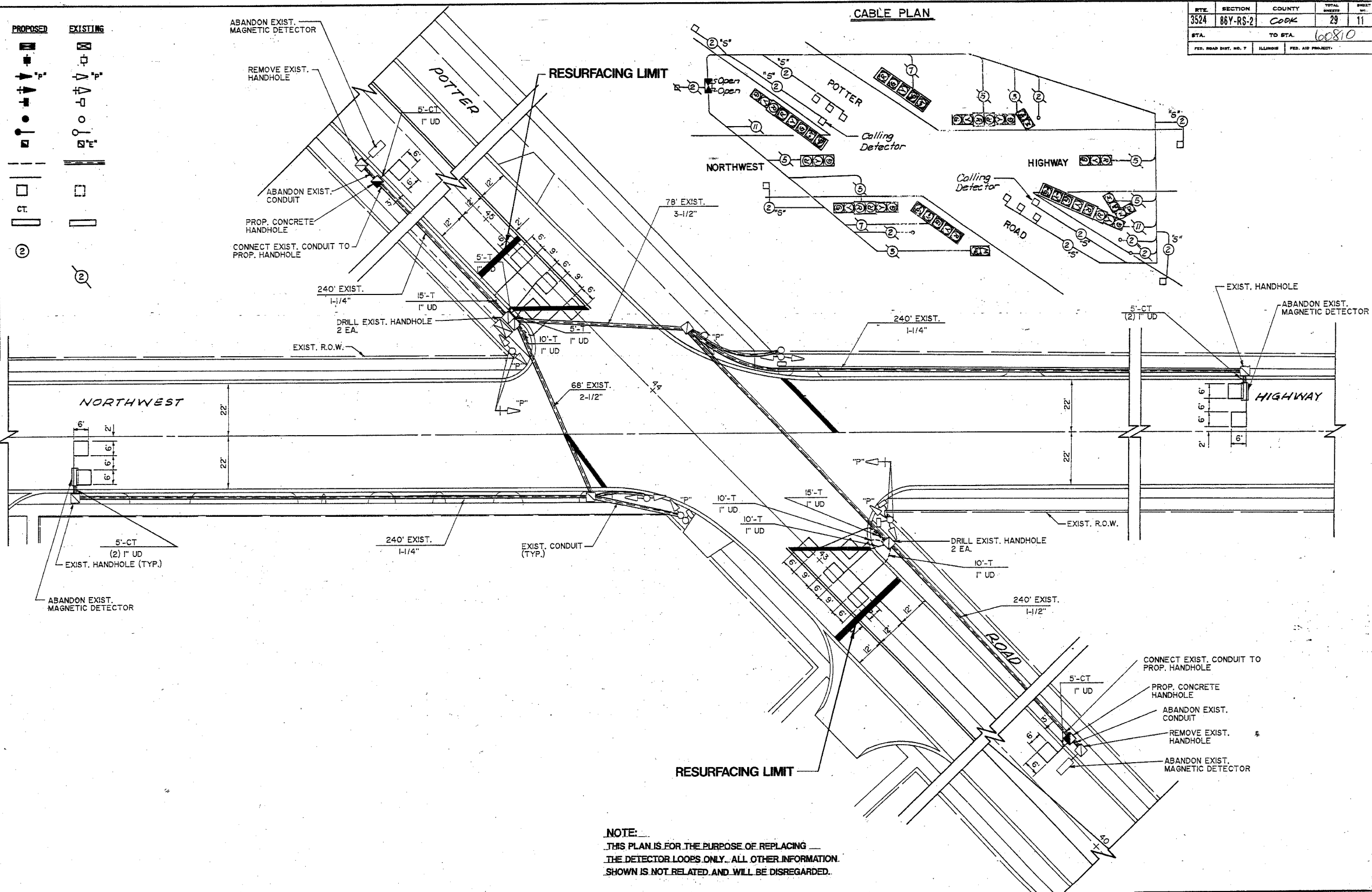

NOTE:
THIS PLAN IS FOR THE PURPOSE OF REPLACING THE DETECTOR LOOPS ONLY. ALL OTHER INFORMATION SHOWN IS NOT RELATED AND WILL BE DISREGARDED.

REPLACE ALL DETECTOR LOOPS AS SHOWN
(WITHIN THE RESURFACING LIMITS)

QUANTITY	UNIT	ITEM
472	Foot	Detector Loop Replacement

REVISIONS	
NAME	DATE

DEPARTMENT OF TRANSPORTATION
DETECTOR LOOP REPLACEMENT

NORTHWEST HIGHWAY @ POTTER ROAD

DATE _____
CHECKED BY _____

SCALE 1" = 20'

ROUTE	SECTION	COUNTY	TOTAL SHEETS	SHEET NO.
3524	86Y-RS-2	COOK	29	11

STA. TO STA. 60810
FED. ROAD DIST. NO. 7 ILLINOIS FED. AID PROJECT