

D-91-487-00

P. A. B. I. NO.	SECTION	COUNTY	TOTAL SHEETS	SHEET NO.
1587	2001-049RS	COOK	27	8
STA. 257+00	TO STA. 286+00			
FED. ROAD DIST. NO. 1	ELIMIS	FED. AID PROJECT		
62058				

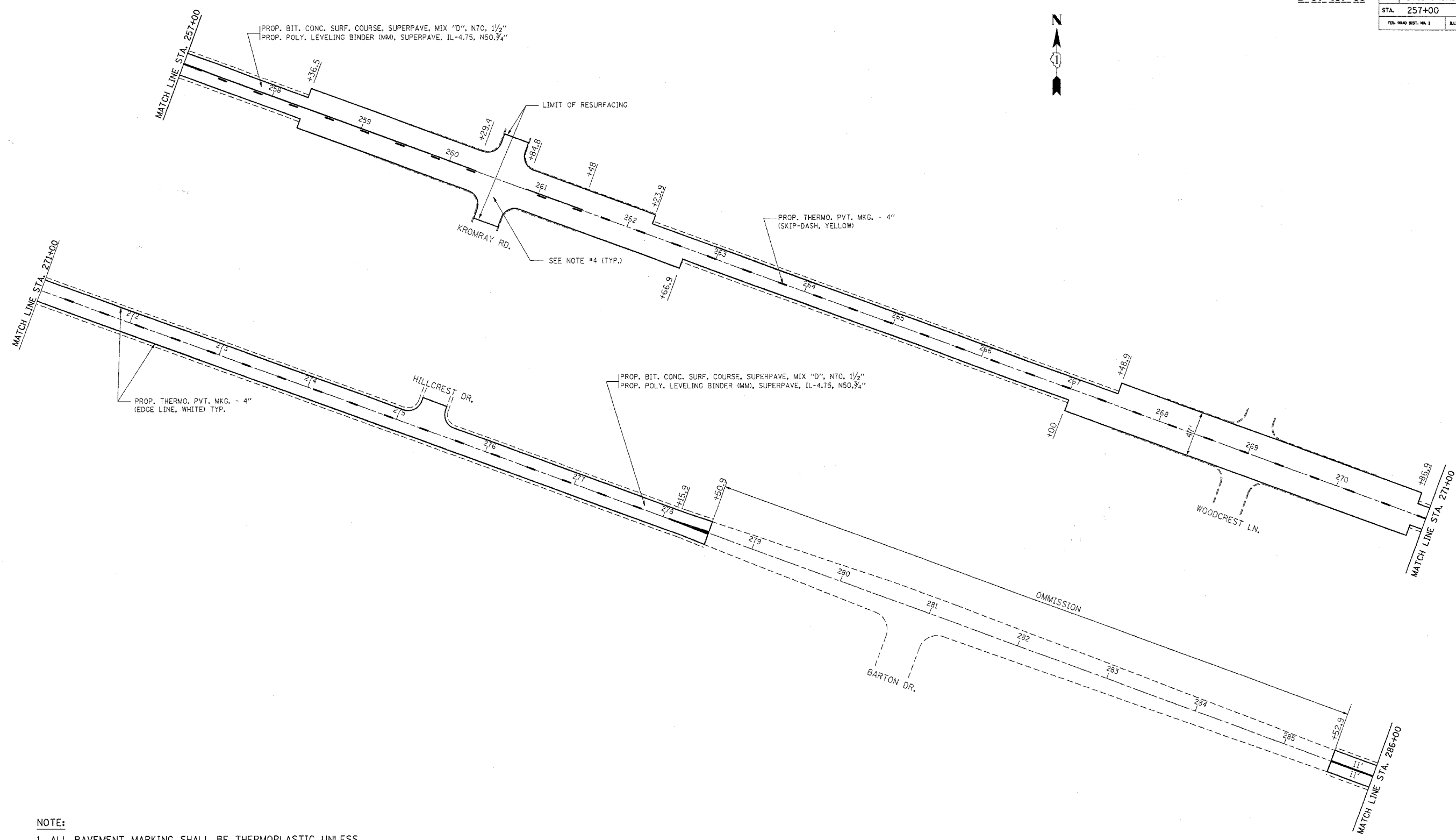

NOTE:

1. ALL PAVEMENT MARKING SHALL BE THERMOPLASTIC UNLESS OTHERWISE NOTED. SEE DISTRICT DETAIL TC-13.
2. RAISED REFLECTIVE PAVEMENT MARKERS SHALL BE USED THROUGHOUT THE IMPROVEMENT LIMITS. DOUBLE LANE LINE MARKERS SHALL BE INSTALLED, SEE DIST. DETAIL TC-11.
3. MILLING AND RESURFACING ACCROSS SIDE STREETS WILL BE SAME AS PARKING LANES
4. MILLING AND RESURFACING SHOULD BE SAME AS MAINLINE

REVISIONS	
NAME	DATE

ILLINOIS DEPARTMENT OF TRANSPORTATION

McCARTHY RD.

ILLINOIS ST. TO BELL RD.

PROP. ROADWAY & PAV'T MARKING PLAN

SCALE: VERT. 1"=50'
 HORIZ. 1"=50'
 DATE 9/24/2004

DRAWN BY _____
 CHECKED BY _____

9/24/2004
 c:\projects\stl48700\dl48700ca.m32
 REF:

VI=