

D-91-487-00

P.A. DIST.	SECTION	COUNTY	TOTAL SHEETS	SHEET NO.
1587	2001-049RS	COOK	27	13
STA.	2+45	TO STA.	29+88	
FED. ROAD DIST. NO. 1	BLINKS	FED. AID PROJECT		
		62058		

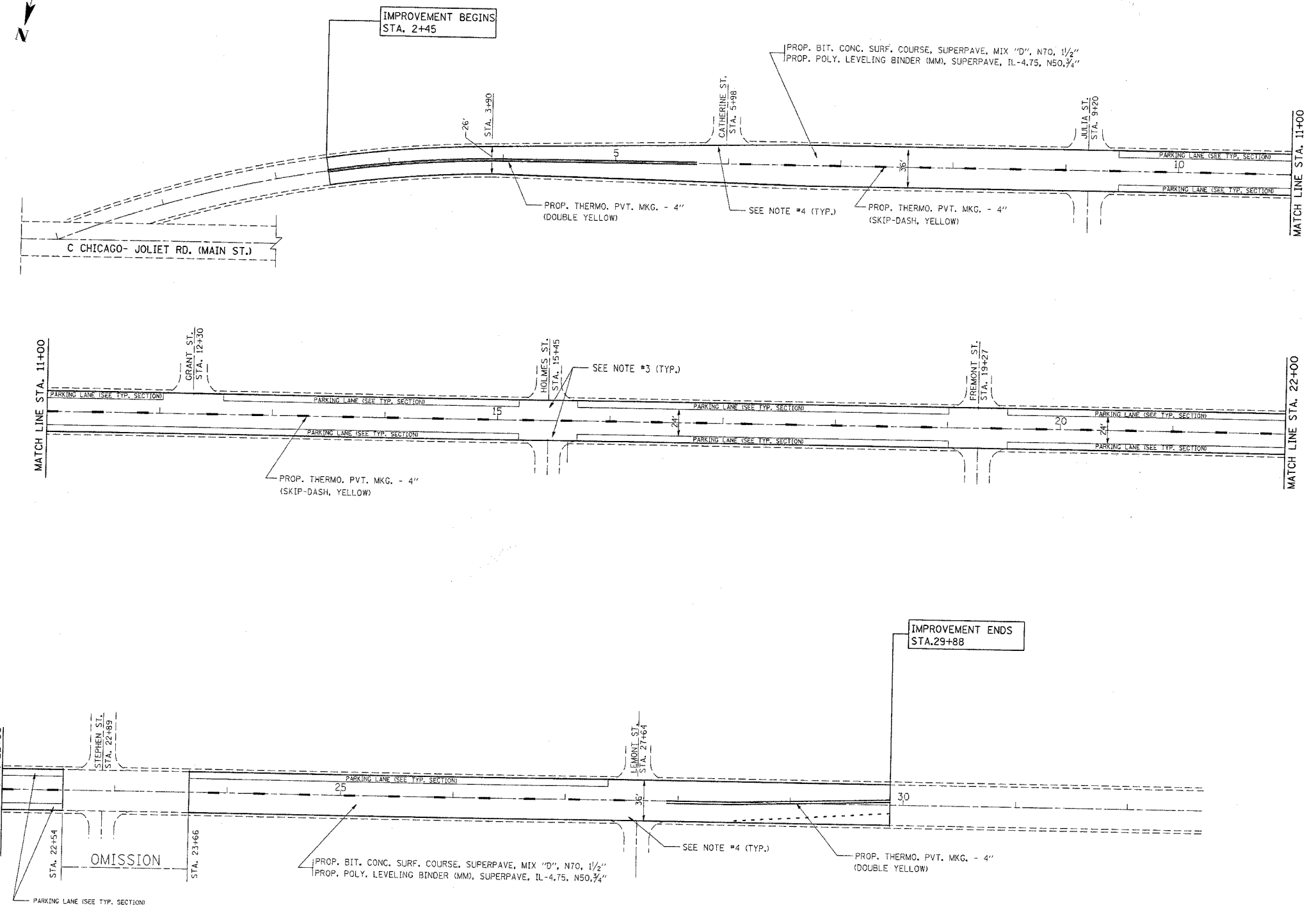

- NOTE:**
1. ALL PAVEMENT MARKING SHALL BE THERMOPLASTIC UNLESS OTHERWISE NOTED. SEE DISTRICT DETAIL TC-13.
 2. RAISED REFLECTIVE PAVEMENT MARKERS SHALL BE USED THROUGHOUT THE IMPROVEMENT LIMITS. DOUBLE LANE LINE MARKERS SHALL BE INSTALLED, SEE DIST. DETAIL TC-11.
 3. MILLING AND RESURFACING ACCROSS SIDE STREETS WILL BE SAME AS PARKING LANES
 4. MILLING AND RESURFACING SHOULD BE SAME AS MAINLINE

REVISIONS	
NAME	DATE

ILLINOIS DEPARTMENT OF TRANSPORTATION

**ILLINOIS ST.
STATE ST. TO MAIN ST.
PROP. ROADWAY & PAV'T MARKING PLAN**

SCALE: VERT. 1"=50'
HORIZ. 1"=50'
DATE 9/24/2004

DRAWN BY
CHECKED BY

9/24/2004
 c:\p\o\bc\rs\gd\48700\gd\48700.dwg
 REF