

F.A. RTE.	SECTION	COUNTY	TOTAL SHEETS	SHEET NO.
1516, 1717 & 1818-6		Cook	195	162
STA.	TO STA.			
FED. ROAD DIST. NO.	ILLINOIS FED. AID PROJECT			

62872

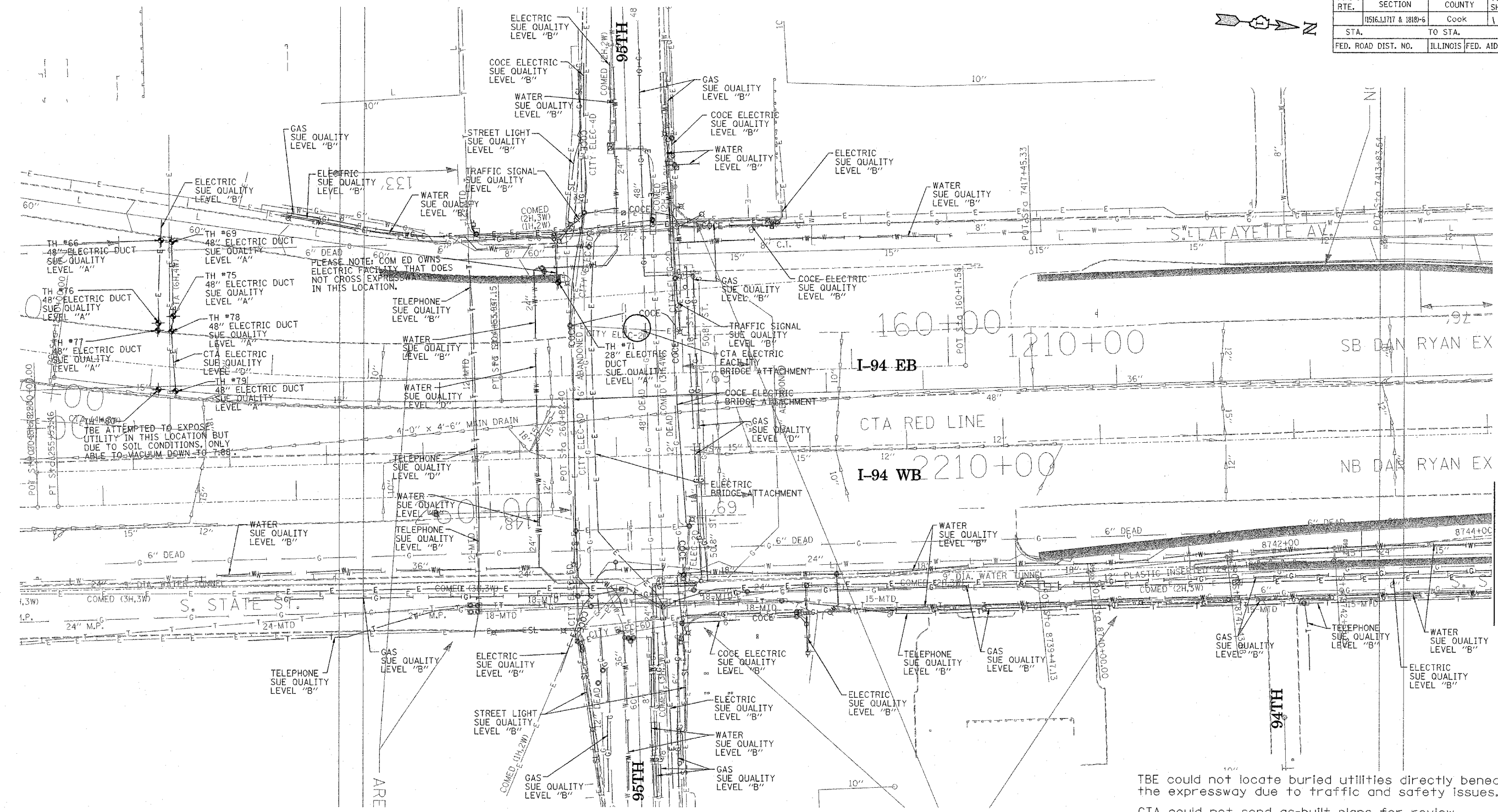

TBE GROUP, INC.
 CIVIL ENGINEERING * TRANSPORTATION * ENVIRONMENTAL
 * PLANNING * UTILITY ENGINEERING/LOCATING
 SOUTHERN REGION: FL, GA, SC, NC
 NORTHERN REGION: IL, IN, MI, OH, MD, NJ, NY
 PA, VA, CANADA
 WESTERN REGION: AZ, NV, NM, TX, CA, OR, UT, WA
 IL09500167, 168, 170, 171, 179, 180, 204, 205,
 206, 211, 212, 219, 221, 225
 TBE SUE PAGE NO: 6 of 30
 Checked by: *Sandra [Signature]*
 SUE Quality Level "A" : Test Holes
 SUE Quality Level "B" : Designating

—TS—	—TS—	TRAFFIC SIGNAL
—SL—	—SL—	STREET LIGHT
—COCE—	—COCE—	CITY OF CHICAGO ELECTRIC
—T—	—T—	TELEPHONE
—W—	—W—	WATER
—G—	—G—	GAS
—CTV—	—CTV—	CABLE TELEVISION
—FO—	—FO—	FIBER OPTIC
—E—	—E—	ELECTRIC
⊙	⊙	TEST HOLE

Utilities shown on these plans as depicted in the legend have been investigated by TBE Group, Inc in accordance with SUE Industry Standards. All other information shown has been provided to TBE Group, Inc by others.

TBE could not locate buried utilities directly beneath the expressway due to traffic and safety issues.
 CTA could not send as-built plans for review. TBE met with Leo Bazelewski, Testing Engineer for CTA regarding their facilities.
 Size given for Electric Duct is width only.

 205 W. WACKER DRIVE SUITE 1020 CHICAGO, IL 60606 (312) 704-1970	REVISIONS NAME DATE		ILLINOIS DEPARTMENT OF TRANSPORTATION SUE Investigation of Underground Utilities I-94 NB & SB of Dan Ryan Expressway From I-57 to 43rd Street Contract No: 62586, 62589, 62590, 62594, 62693 SOL "A" DATE : 10/23/04 DRAWN BY : KLC SOL "B" DATE : 7/22/04 SCALE : 1" = 50'