

64157

F.A.P. R.T.E.	SECTION	COUNTY	TOTAL SHEETS	SHEET NO.
742	37R-2	OGLE	389	1
			+4	
			= 393	Total Sheets

STATE OF ILLINOIS  
DEPARTMENT OF TRANSPORTATION  
DIVISION OF HIGHWAYS

**PROPOSED  
HIGHWAY PLANS**

FAP ROUTE 742  
SECTION 37R-2  
PROJECT F-0742 (124)  
OGLE COUNTY

C-92-008-03

FOR INDEX OF SHEETS, SEE SHEET NO. 02

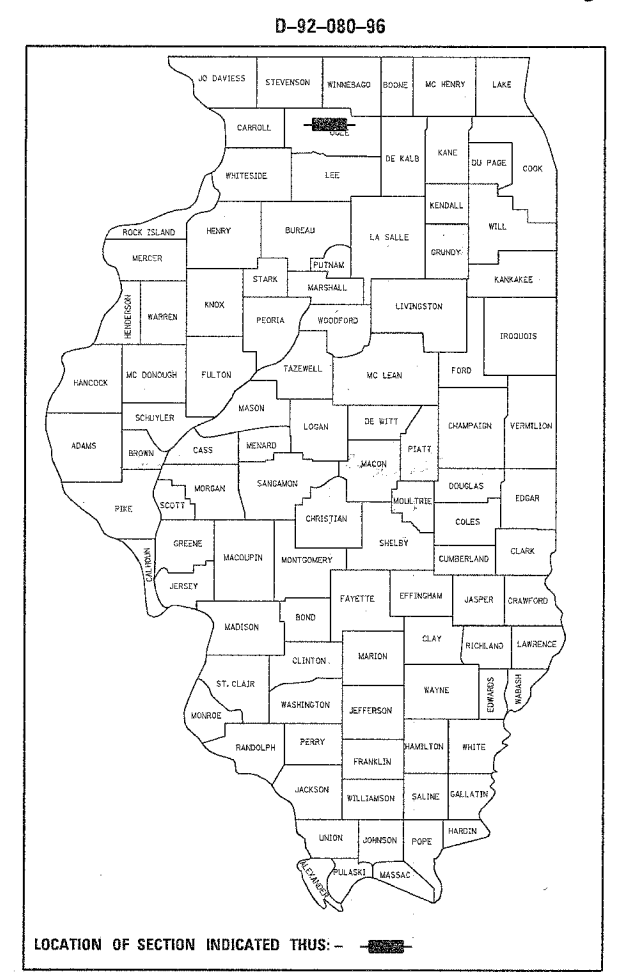

**METRIC RATIOS**

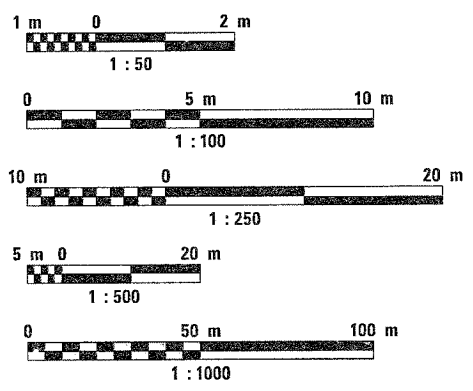

FULL SIZE PLANS HAVE BEEN PREPARED USING STANDARD ENGINEERING SCALES. REDUCED SIZED PLANS WILL NOT CONFORM TO STANDARD SCALES. IN MAKING MEASUREMENTS ON REDUCED PLANS, THE ABOVE SCALES MAY BE USED.

J.U.I.E.  
JOINT UTILITY LOCATION INFORMATION FOR EXCAVATION  
1-800-892-0123

PROJECT BEGINS  
STA. 32 + 604

DESIGN DESTINATION  
1615(96)-OTHER PRINCIPLE ARTERIALS-3.22(PCC-20)

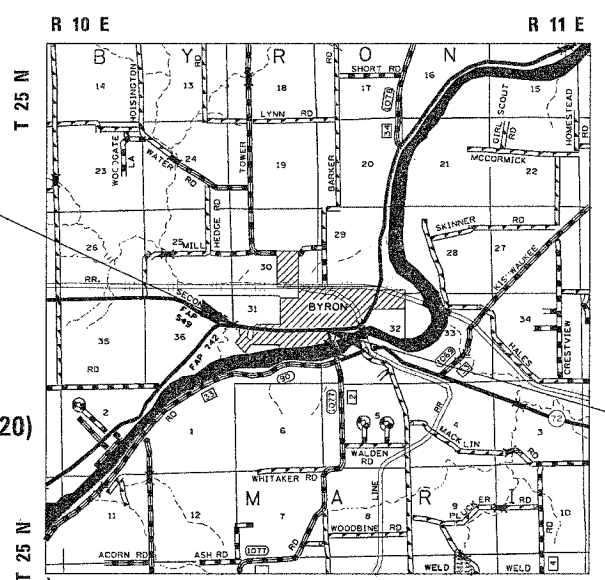

PROJECT ENDS  
STA. 34 + 450

BYRON TOWNSHIP, SECTIONS 36, 31, 32  
NET LENGTH OF PROJECT = 1846 M = 1.846 Km  
SCALE 1" = 1 MILE

STATE OF ILLINOIS  
DEPARTMENT OF TRANSPORTATION  
DIVISION OF HIGHWAYS

SUBMITTED Aug 30 2004  
*Joseph L. Hunt* DISTRICT ENGINEER

December 10, 2004  
*Mike Hine* ENGINEER OF DESIGN AND ENVIRONMENT

December 10, 2004  
*Victor Madec* DIRECTOR, DIVISION OF HIGHWAYS

**PRINTED BY THE AUTHORITY  
OF THE STATE OF ILLINOIS**

DISTRICT 2  
DIXON, IL

CONTRACT NO. 64157

SQUAD LEADER: KYLE LORENZ (815) 284-5942

PROJECT ENGINEER: BOB WAGNER (815) 284-5358