

PAVEMENT JOINT DETAILS

F.A.P. RTE.	SECTION	COUNTY	TOTAL SHEETS	SHEET NO.
742	37R-2	OGLE	389	79
STA. 32+800		TO STA. 32+975		
FED. ROAD DIST. NO.		ILLINOIS FED. AID PROJECT		
CONTRACT #64157				

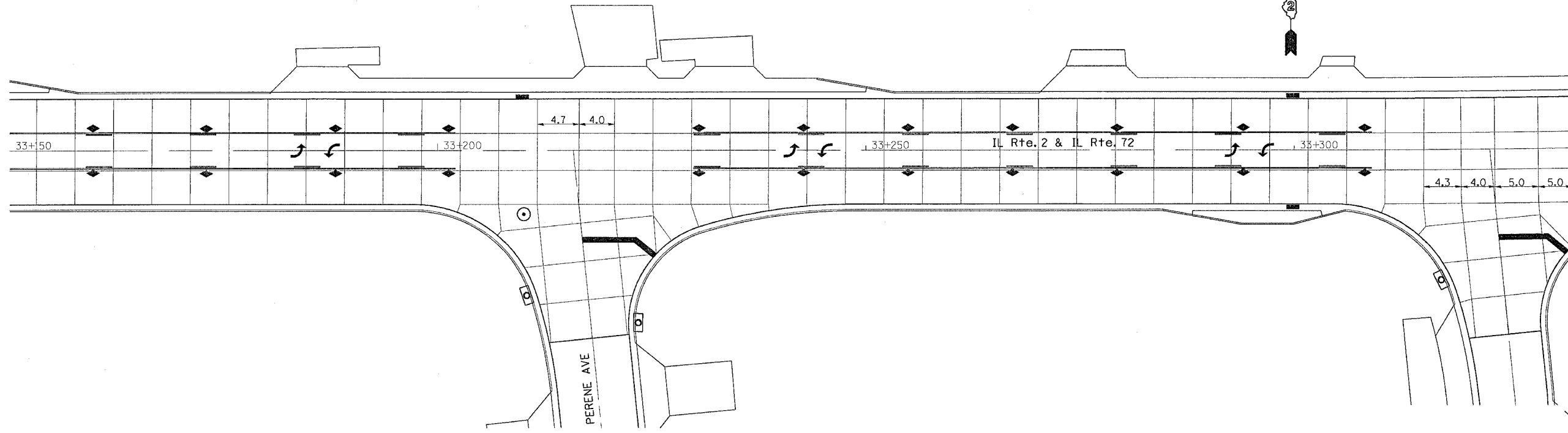

FINAL SURVEY	BY	DATE
SURVEYED		
PLOTTED		
NOTE BOOK TEMPLATE		
AREAS CHECKED		
NO.		



TRANSVERSE JOINT SPACING IS 4.5m UNLESS OTHERWISE NOTED

ORIGINAL SURVEY	BY	DATE
SURVEYED		
PLOTTED		
NOTE BOOK TEMPLATE		
AREAS CHECKED		
NO.		

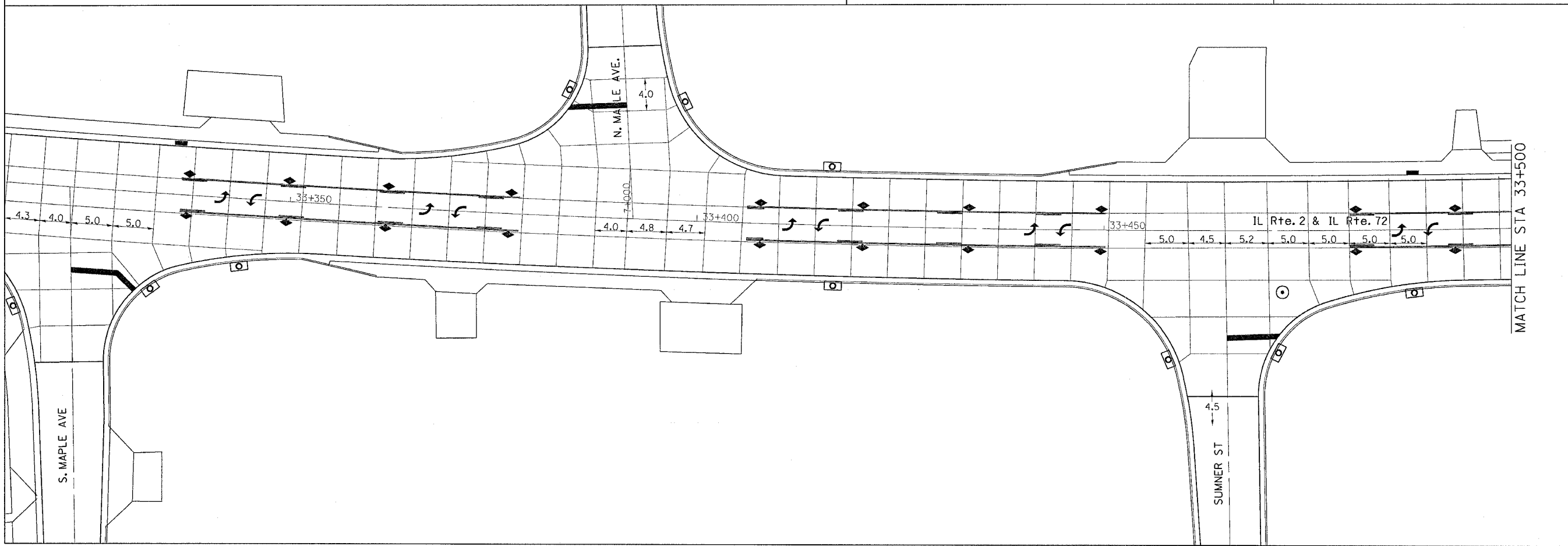

MATCH LINE STA 33+500

Fri Aug 27 13:28:35 2004
c:\projects\m268096\pave\joint.dgn

PAVEMENT JOINT DETAILS