

# SEEDING, SODDING, & PAVEMENT MARKING DETAILS

F.A.P. RTE.	SECTION	COUNTY	TOTAL SHEETS	SHEET NO.
742	37R-2	OGLE	389	117
STA. 32+800		TO STA. 32+975		
FED. ROAD DIST. NO.		ILLINOIS	FED. AID PROJECT	
		CONTRACT #64157		



FINAL SURVEY	BY	DATE
SURVEY PLOTTED		
NOTE BOOK TEMPLATE		
AREAS CHECKED		
NO.		

MATCH LINE STA 33+150

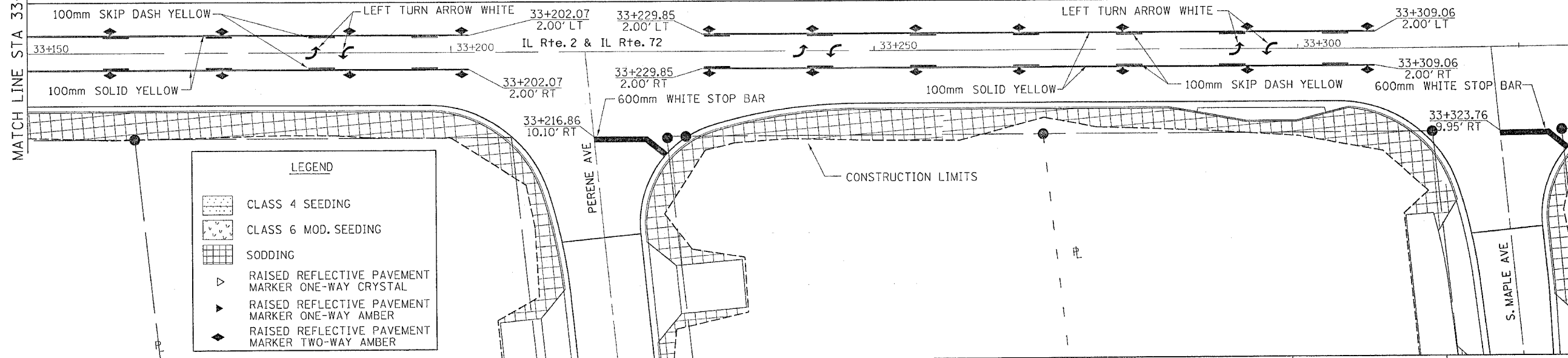

LEGEND

	CLASS 4 SEEDING
	CLASS 6 MOD. SEEDING
	SODDING
	RAISED REFLECTIVE PAVEMENT MARKER ONE-WAY CRYSTAL
	RAISED REFLECTIVE PAVEMENT MARKER ONE-WAY AMBER
	RAISED REFLECTIVE PAVEMENT MARKER TWO-WAY AMBER

ORIGINAL SURVEY	BY	DATE
SURVEY PLOTTED		
NOTE BOOK TEMPLATE		
AREAS CHECKED		
NO.		

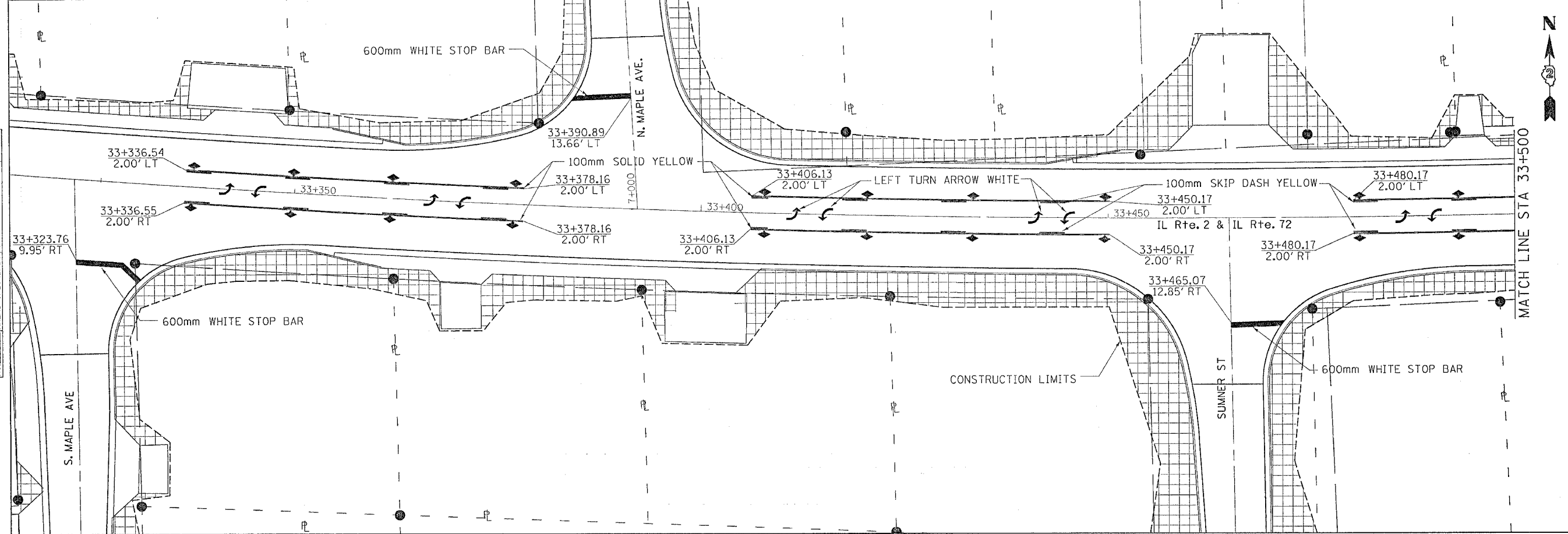

MATCH LINE STA 33+500

Mon Oct 18 11:46:29 2004  
c:\projects\m208096\seedseed.dgn